



Western Michigan University
ScholarWorks at WMU

Legacy Scout Tickets from Pure Oil Company

8-20-2021

**MGRRE_PureOilScoutTickets_Southwick, C R
W_1_21073118650000**

MGRRE
Western Michigan University

Follow this and additional works at: <https://scholarworks.wmich.edu/pure>



Part of the Geology Commons

WMU ScholarWorks Citation

MGRRE, "MGRRE_PureOilScoutTickets_Southwick, C R W_1_21073118650000" (2021). *Legacy Scout Tickets from Pure Oil Company*. 3737.
<https://scholarworks.wmich.edu/pure/3737>

This Document is brought to you for free and open access via ScholarWorks at WMU. It has been accepted for inclusion in Legacy Scout Tickets from Pure Oil Company by an authorized administrator of ScholarWorks at WMU. See the National Digital Catalogue - Science Base Catalogue for more collections submitted by MGRRE.



MGRRE_PureOilScoutTickets_Southwick, C R W_1_21073118650000

API 21073118650000

Permit Number 11865

Lease Name Southwick, C R W

Well Number 1

County Isabella

Township 15N

Range 06W

Section 9

2021 DEQ or Pure co_name Collin, C. W.

Pure Number 1057

Latitude 43.70551

Longitude -85.03432

THE PURE OIL COMPANY LOCATION REPORT

Date October 3, 1945

A.F.E. No. _____

Division Mich. Producing District _____

Lease C.R.W. Southwick
C. R. W. Southwick

Acres _____ Lease No. _____ Elevation _____ Well No. 1 (Serial No. 1057)

Quadrangle SE-SW-NE Sec. 9 Twp. 15 N Rge. 6 W Twp. SHERMAN
SE SW NE 9 15 N 6 W Sherman

Survey _____ County Isabella State Michigan

Operator C. W. Collin Map Sherman Township, Isabella County

_____ Feet from North Line of Lease

_____ " " East " " "

330 330 " " South " " "

990 990 " " West " " "

_____ Feet from North Line of Section

_____ " " East " " "

330 330 " " South " 1/4"

990 990 " " West " " "

LEGEND

○ Location

☀ Gas Well

● Oil Well

☀ Gas - Distillate Well

○ or ○ Dry Hole

● Dry Showing Oil

☀ Dry Showing Gas

⊗ Abandoned Location

☀ or ☀ Abandoned Gas Well

● or ● Abandoned Oil Well

● or ○ Input Well

Handwritten notes:
NE 490
9-29-45
10" P.P. 190

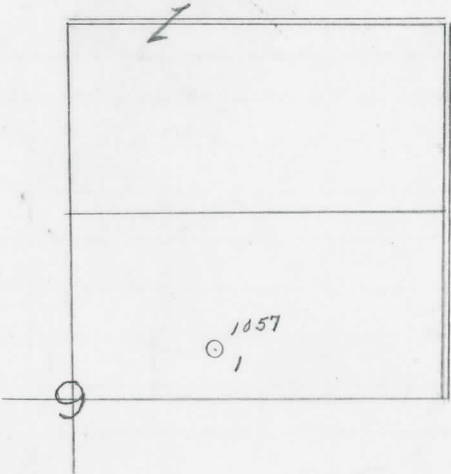

Scale _____

Remarks: _____

Submitted by _____
Civil Engineer

Approved by _____
Division Manager

Approved by _____
Vice-President - General Manager

THE PURE OIL COMPANY

The Pure Oil Company

COMPLETION RECORD OF WELLS DRILLED BY OTHER OPERATORS

Michigan Producing Division

Date October 24, 1945 No. 1057

State Mich. Co. Isabella ~~Dist.~~ Twp. Sherman Sec. 9 Twp. 15 N Rge. 6 W

Well No. 1 Serial No. 1057 Farm C. R. W. Southwick Acres _____

Operator C. W. Collin

Date started 9-29-45 Date completed 10-18-45 Elevation 952.8

PRODUCTION RECORD

1st 24 hours natural

Date of shot _____ No. of quarts _____ From _____ To _____ From _____ to _____

Date of acid _____ shot _____ No. of gallons _____

1st 24 hours after acid

Completed as: Oil Well _____ Gas Well _____ Dry Hole X

FORMATION AND CASING RECORD

Formation	Top	Bottom	Top Pay	Bottom Pay	Remarks	Casing	
						Size	Set at
Brown Dolomite	1325 Schl.	(-372)				10"	475
Mich. Stray	1438 Schl.	(-485)					
Total Depth		1765		(-812)			

Remarks Schlumberger survey at 1720'
1277 equals 78 SLM

Signed D. C. Shackelford