



Western Michigan University  
ScholarWorks at WMU

---

Legacy Scout Tickets from Pure Oil Company

---

8-20-2021

**MGRRE\_PureOilScoutTickets\_Smith,  
Winnifred\_1\_21073118660000**

MGRRE  
*Western Michigan University*

Follow this and additional works at: <https://scholarworks.wmich.edu/pure>



Part of the Geology Commons

---

#### **WMU ScholarWorks Citation**

MGRRE, "MGRRE\_PureOilScoutTickets\_Smith, Winnifred\_1\_21073118660000" (2021). *Legacy Scout Tickets from Pure Oil Company*. 3738.

<https://scholarworks.wmich.edu/pure/3738>

This Document is brought to you for free and open access via ScholarWorks at WMU. It has been accepted for inclusion in Legacy Scout Tickets from Pure Oil Company by an authorized administrator of ScholarWorks at WMU. See the National Digital Catalogue - Science Base Catalogue for more collections submitted by MGRRE.



---

**MGRRE\_PureOilScoutTickets\_Smith, Winnifred\_1\_21073118660000**

API 21073118660000

Permit Number 11866

Lease Name Smith, Winnifred

Well Number 1

County Isabella

Township 13N

Range 04W

Section 29

2021 DEQ or Pure co\_name Wicklund, J. V. Development Company

Pure Number 1058

Latitude 43.48681

Longitude -84.82562

# THE PURE OIL COMPANY

## LOCATION REPORT

Date October 3, 1945 A.F.E. No. \_\_\_\_\_

Division Mich. Producing District \_\_\_\_\_ Lease Winnifred Smith  
*WINNIFRED SMITH*

Acres \_\_\_\_\_ Lease No. \_\_\_\_\_ Elevation \_\_\_\_\_ Well No. 1 (Serial No. 1058)

Quadrangle NW-NW-SW Sec. 29 Twp. 13 N Rge. 4 W Twp. Lincoln  
*NW NW SW* *29* *13 N* *4 W* *Lincoln*

Survey \_\_\_\_\_ County Isabella State Michigan  
*ISABELLA*

Operator J. V. Wicklund Development Co. Map Lincoln Township, Isabella County  
*J. V. WICKLUND*

<u>330</u>	<u>330</u>	Feet from North Line of Lease
_____	_____	" " East " " "
_____	_____	" " South " " "
<u>330</u>	<u>330</u>	" " West " " "
<u>330</u>	<u>330</u>	Feet from North Line of Section
_____	_____	" " East " " "
_____	_____	" " South " " "
<u>330</u>	<u>330</u>	" " West " " "

### LEGEND

- Location
- ☀ Gas Well
- Oil Well
- ☀ Gas-Distillate Well
- ⊘ or ○ Dry Hole
- Dry Showing Oil
- ☀ Dry Showing Gas
- ⊘ Abandoned Location
- ☀ or ⊘ Abandoned Gas Well
- or ● Abandoned Oil Well
- or ○ Input Well

*mg*

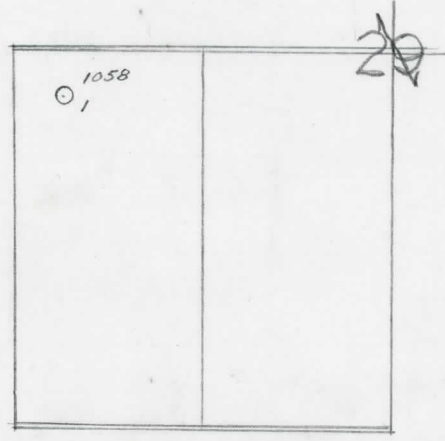

Scale \_\_\_\_\_

Remarks: \_\_\_\_\_  
\_\_\_\_\_  
\_\_\_\_\_

Submitted by \_\_\_\_\_ Civil Engineer Approved by \_\_\_\_\_ Division Manager

Approved by \_\_\_\_\_ Vice-President-General Manager

Date October 3, 1942

LOCATION REPORT

W.E.E. No.

THE PURE OIL COMPANY

COMPLETION RECORD OF WELLS DRILLED BY OTHER OPERATORS

WC

Michigan Producing Division

Date January 16, 1946 No. 1058

State Mich. County Isabella Twp. Lincoln Sec. 29 Twp. 13 N Rge. 4 W  
(Serial No.)

Well No. 1 (County No.) 1058 Farm Winnifred Smith Acres

Operator J. V. Wicklund Dvl. Co. Information secured ~~from~~ By Scouting Department

Date well started 11-16-45 Date well completed 1-8-46 Elevation 853.8

PRODUCTION BOARD

1st 24 hours natural DRY HOLE

2nd 24 hours natural

Date of shot No. of quarts From To From to

Date of acid No. of gallons

1st 24 hours after acid shot

2nd 24 hours after acid shot

FORMATION AND CASING RECORD

Formation	Top	Bottom	Top Pay	Bottom Pay	Remarks	Casing	
						Size	Set at
Brown Dolomite	1225		(-371)			10"	496
Stray Stray	1255	1260				8-1/4"	1005
Mich. Stray	1270		(-416)			6-5/8"	1625
Marshall	1322	1622	(-468)				
Sunbury	2569	(-1721)					
Berea	2585	(-1731)					
Antrim	2590	3050	(-736)				
Traverse Lime	3053	(-2199)					
Dundee	3612	(-2758)			Show salt water		
					(-2773) 3627; inc. salt water		
					(-2776) 3630; H.F.S.W. 3636. (-2782)		
Total Depth		3636	(-2782)				

Remarks 3580' equals 3580' S.L.M.; 3636' equals 3635' S.L.M.

Signed D. C. Shackelford