



Western Michigan University
ScholarWorks at WMU

Legacy Scout Tickets from Pure Oil Company

8-20-2021

**MGRRE_PureOilScoutTickets_Gieseler, Oscar
D_1_21073118950000**

MGRRE
Western Michigan University

Follow this and additional works at: <https://scholarworks.wmich.edu/pure>



Part of the Geology Commons

WMU ScholarWorks Citation

MGRRE, "MGRRE_PureOilScoutTickets_Gieseler, Oscar D_1_21073118950000" (2021). *Legacy Scout Tickets from Pure Oil Company*. 3739.
<https://scholarworks.wmich.edu/pure/3739>

This Document is brought to you for free and open access via ScholarWorks at WMU. It has been accepted for inclusion in Legacy Scout Tickets from Pure Oil Company by an authorized administrator of ScholarWorks at WMU. See the National Digital Catalogue - Science Base Catalogue for more collections submitted by MGRRE.



MGRRE_PureOilScoutTickets_Gieseler, Oscar D_1_21073118950000

API 21073118950000

Permit Number 11895

Lease Name Gieseler, Oscar D

Well Number 1

County Isabella

Township 16N

Range 06W

Section 29

2021 DEQ or Pure co_name A N R Pipeline Company

Pure Number 1059

Latitude 43.75262

Longitude -85.06571

TV

THE PURE OIL COMPANY

LOCATION REPORT

Date October 17, 1945

A.F.E. No. _____

Division Mich. Producing District _____

Lease Oscar D. Gieseler
Oscar D. Gieseler

Acres _____ Lease No. _____ Elevation _____ Well No. 1 (Serial No. 1059)

Quadrangle C-5/2-NW-NW Sec. 29 Twp. 16 N Rge. 6 W ~~ENE~~ ~~ENEC~~ Coldwater
C S 1/2 NW NW 29 16 N 6 W Coldwater

Survey _____ County Isabella State Michigan

Operator Sohio Petroleum Company Map Coldwater Township, Isabella County

_____	_____	Feet from North Line of Lease	_____	_____	_____	_____
_____	_____	" " East " " "	_____	_____	_____	_____
<u>330</u>	<u>330</u>	" " South " " "	_____	_____	_____	_____
<u>660</u>	<u>660</u>	" " West " " "	_____	_____	_____	_____
<u>990</u>	<u>990</u>	Feet from North Line of Section	_____	_____	_____	_____
_____	_____	" " East " " "	_____	_____	_____	_____
_____	_____	" " South " " "	_____	_____	_____	_____
<u>660</u>	<u>660</u>	" " West " " "	_____	_____	_____	_____

LEGEND

- Location
- ☀ Gas Well
- Oil Well
- ☀ Gas - Distillate Well
- ∅ or ○ Dry Hole
- Dry Showing Oil
- ☀ Dry Showing Gas
- ⊗ Abandoned Location
- ☀ or ☀ Abandoned Gas Well
- or ● Abandoned Oil Well
- or ○ Input Well

N

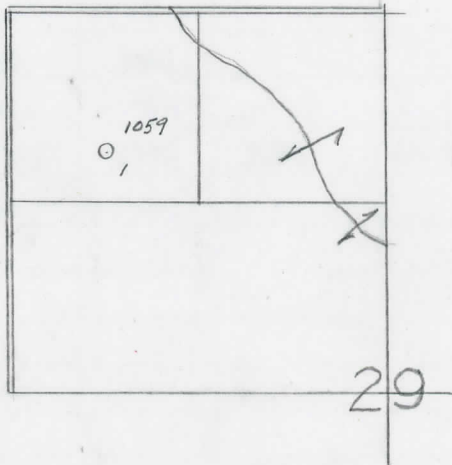

Remarks: _____

Scale _____

Submitted by _____ Civil Engineer Approved by _____ Division Manager

Approved by _____ Vice-President - General Manager

Date October 13, 1942

LOCATION BEBOVI

WELL NO.

THE PURE OIL COMPANY

COMPLETION RECORD OF WELLS DRILLED BY OTHER OPERATORS

Michigan Producing Division

Date December 5, 1945 No. 1059
 State Michigan Co. Isabella District Coldwater Twp. 29 Sec. 16 N Rge 6 W
 Well No. 1 Serial No. 1059 Farm Oscar D. Gieseler Acres _____
 Operator Sohio Petroleum Company
 Date started 10-12-45 Date completed 11-12-45 Elevation 1016.0

PRODUCTION RECORD

1st 24 hours natural Flowed 56 Barrels
 Date of shot _____ No. of quarts _____ From _____ To _____ From _____ to _____
 Date of acid _____ No. of gallons _____ shot _____
 1st 24 hours after acid _____
 Completed as: Oil Well Gas Well _____ Dry Hole _____

FORMATION AND CASING RECORD

Formation	Top	Bottom	Top Pay	Bottom Pay	Remarks	Casing	
						Size	Set at
Brown Dolomite	1307	Schl.	(-293)			10"	710
Mich. Stray	1403	"	(-402)			5-3/16"	3777
Marshall	(-694)	1710	Schl.				
Traverse Lime	3190	Schl.	(-2174)				
Dundee	3781	(-2765)	3782	3784	(-2766)		
Total Depth		3784	(-2768)				

Remarks _____

Signed D. C. Shackelford