



Western Michigan University
ScholarWorks at WMU

Legacy Scout Tickets from Pure Oil Company

8-20-2021

MGRRE_PureOilScoutTickets_Simpson_1_21073120650000

MGRRE

Western Michigan University

Follow this and additional works at: <https://scholarworks.wmich.edu/pure>



Part of the Geology Commons

WMU ScholarWorks Citation

MGRRE, "MGRRE_PureOilScoutTickets_Simpson_1_21073120650000" (2021). *Legacy Scout Tickets from Pure Oil Company*. 3749.

<https://scholarworks.wmich.edu/pure/3749>

This Document is brought to you for free and open access via ScholarWorks at WMU. It has been accepted for inclusion in Legacy Scout Tickets from Pure Oil Company by an authorized administrator of ScholarWorks at WMU. See the National Digital Catalogue - Science Base Catalogue for more collections submitted by MGRRE.



MGRRE_PureOilScoutTickets_Simpson_1_21073120650000

API 21073120650000

Permit Number 12065

Lease Name Simpson

Well Number 1

County Isabella

Township 16N

Range 04W

Section 16

2021 DEQ or Pure co_name Union Drilling and Producing Company

Pure Number 1071

Latitude 43.7755

Longitude -84.79433

THE PURE OIL COMPANY
LOCATION REPORT

Date January 9, 1946 A.F.E. No. _____
 Division Mich. Producing District _____ Lease Simpson
 Acres _____ Lease No. _____ Elevation _____ Well No. 1 (Serial No. 1071)
 Quadrangle SE-NW-SE Sec. 16 Twp. 16 N Rge. 4 W ~~Dist.~~ Vernon
 Survey _____ County Isabella State Michigan
 Operator Union Drilling & Producing Co. Map Vernon Township, Isabella County

<u>990</u>	<u>990</u>	Feet from North Line of Lease
		" " East " " "
		" " South " " "
<u>330</u>	<u>330</u>	" " West " " "
<u>990</u>	<u>990</u>	Feet from North Line of Section
		" " East " " "
		" " South " " "
<u>990</u>	<u>990</u>	" " West " " "

LEGEND

- Location
- ☉ Gas Well
- Oil Well
- ☉ Gas - Distillate Well
- or ○ Dry Hole
- Dry Showing Oil
- ☉ Dry Showing Gas
- ⊗ Abandoned Location
- ☉ or ☉ Abandoned Gas Well
- or ● Abandoned Oil Well
- or ○ Input Well

m 196
Sp 1-5-46

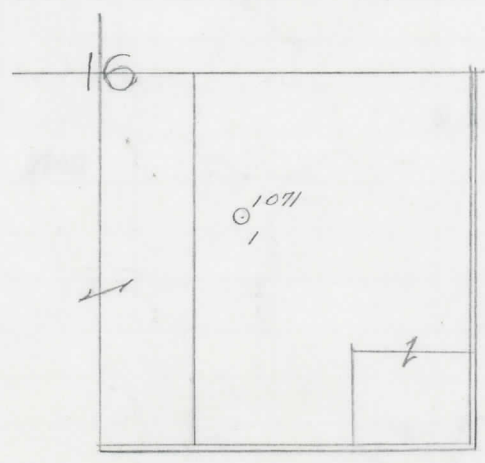

Remarks: _____

Scale _____

Submitted by CB Civil Engineer Approved by _____ Division Manager
 Approved by _____ Vice-President - General Manager

