



Western Michigan University
ScholarWorks at WMU

Legacy Scout Tickets from Pure Oil Company

8-20-2021

**MGRRE_PureOilScoutTickets_Foley, Charles F. & Henry
F._1_21073121680000**

MGRRE
Western Michigan University

Follow this and additional works at: <https://scholarworks.wmich.edu/pure>



Part of the Geology Commons

WMU ScholarWorks Citation

MGRRE, "MGRRE_PureOilScoutTickets_Foley, Charles F. & Henry F._1_21073121680000" (2021). *Legacy Scout Tickets from Pure Oil Company*. 3758.
<https://scholarworks.wmich.edu/pure/3758>

This Document is brought to you for free and open access via ScholarWorks at WMU. It has been accepted for inclusion in Legacy Scout Tickets from Pure Oil Company by an authorized administrator of ScholarWorks at WMU. See the National Digital Catalogue - Science Base Catalogue for more collections submitted by MGRRE.



MGRRE_PureOilScoutTickets_Foley, Charles F. & Henry F._1_21073121680000

API 21073121680000

Permit Number 12168

Lease Name Foley, Charles F. & Henry F.

Well Number 1

County Isabella

Township 15N

Range 04W

Section 29

2021 DEQ or Pure co_name Gordon Oil Company

Pure Number 1083

Latitude 43.66319

Longitude -84.82411

WC

THE PURE OIL COMPANY

LOCATION REPORT

Date March 20, 1946

A.F.E. No. _____

Division Mich. Producing District _____

Chas. F. & Henry F. Foley
Lease Chas. F. & Henry F. Foley

Acres _____ Lease No. _____ Elevation _____ Well No. 1 (Serial No. 1083)

Quadrangle SE-SW-NW SE SW NW Sec. 29 Twp. 15 N Rge. 4 W ~~Isabella~~ Isabella Twp. Isabella

Survey Gordon Oil Co. County Isabella State Michigan

Operator Gordon Oil Company Map Isabella Township, Isabella County

		Feet from North Line of Lease
<u>330</u>	<u>330</u>	" " East " " "
<u>330</u>	<u>330</u>	" " South " " "
		" " West " " "

		Feet from North Line of Section
		" " East " " "
<u>330</u>	<u>330</u>	" " South " <u>1/4</u> "
<u>990</u>	<u>990</u>	" " West " " "

LEGEND

- Location
- ☀ Gas Well
- Oil Well
- ☀ Gas - Distillate Well
- or ○ Dry Hole
- Dry Showing Oil
- ☀ Dry Showing Gas
- ⊗ Abandoned Location
- ☀ or ☀ Abandoned Gas Well
- or ● Abandoned Oil Well
- or ○ Input Well

Big

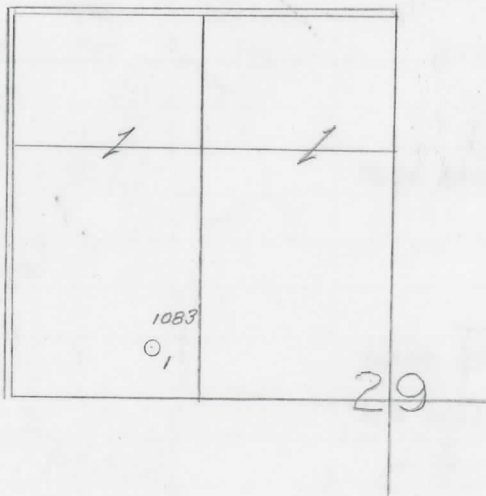

Remarks: _____

Scale _____

Submitted by CB _____
Civil Engineer

Approved by _____
Division Manager

Approved by _____
Vice-President - General Manager

THE PURE OIL COMPANY
COMPLETION RECORD OF WELLS DRILLED BY OTHER OPERATORS

Michigan Producing Division

Date May 22, 1946 No. 1083
 State Michigan Co. Isabella ~~Dodge~~ Isabella Twp. Isabella Sec. 29 Twp. 15 N Rge. 4 W
 Well No. 1 Serial No. 1083 Farm C.F. & H.F. Foley Acres _____
 Operator Gordon Oil Company
 Date started 3-26-46 Date completed 5-16-46 Elevation 801.7

PRODUCTION RECORD

1st 24 hours natural _____
 Date of shot _____ No. of quarts _____ From _____ To _____ From _____ To _____
 Date of acid _____ No. of gallons _____ shot _____
 1st 24 hours after acid _____
 Completed as: Oil Well _____ Gas Well _____ Dry Hole

FORMATION AND CASING RECORD

Formation	Top	Bottom	Top Pay	Bottom Pay	Remarks	Casing	
						Size	Set at
Brown Dolomite	1308	(-506)				10"	487
Mich. Stray	1410	(-608)				8-1/4"	1070
Marshall	1511	1677	(-709)		Show gas 2292.	6-5/8"	1725
Antrim	2645	(-1843)			(-1440)		
Traverse Lime	3168	(-2366)					
Trav. (Alpena)	3240	(-2438)					
Dundee (Dol.)	3783	(-2981)			Water (500 ft. in 1/2 hr.) at 3804.		
Total Depth		3804	(-3002)		(-3002)		

Remarks 1717' eq. 1723' SLM; 3189' eq. 3187' SLM.

Signed D. C. Shackelford