



Western Michigan University
ScholarWorks at WMU

Legacy Scout Tickets from Pure Oil Company

8-20-2021

**MGRRE_PureOilScoutTickets_Wilson, Laura
B_2_21073123780000**

MGRRE
Western Michigan University

Follow this and additional works at: <https://scholarworks.wmich.edu/pure>



Part of the Geology Commons

WMU ScholarWorks Citation

MGRRE, "MGRRE_PureOilScoutTickets_Wilson, Laura B_2_21073123780000" (2021). *Legacy Scout Tickets from Pure Oil Company*. 3773.
<https://scholarworks.wmich.edu/pure/3773>

This Document is brought to you for free and open access via ScholarWorks at WMU. It has been accepted for inclusion in Legacy Scout Tickets from Pure Oil Company by an authorized administrator of ScholarWorks at WMU. See the National Digital Catalogue - Science Base Catalogue for more collections submitted by MGRRE.



MGRRE_PureOilScoutTickets_Wilson, Laura B_2_21073123780000

API 21073123780000

Permit Number 12378

Lease Name Wilson, Laura B

Well Number 2

County Isabella

Township 16N

Range 06W

Section 30

2021 DEQ or Pure co_name A N R Pipeline Company

Pure Number 1101

Latitude 43.75087

Longitude -85.07563

THE PURE OIL COMPANY

LOCATION REPORT

Date June 13, 1946

A.F.E. No. _____

Division Michigan Producing District _____

Lease Laura B. Wilson
Laura B. Wilson

Acres _____ Lease No. 30 Elevation _____ Well No. 2 (Serial No. 1101)

Quadrangle C-N¹/₂-SW-NE Sec. 30 Twp. 16-N Rge. 6-W Blk. 2 Dist. Coldwater
C N¹/₂ SW NE 30 16-N 6-W Coldwater
Isabella Coldwater

Survey _____ County Isabella State Michigan

Operator Sohio Pet. Co. Map Coldwater Township, Isabella County
Sohio Pet. Co.

<u>330</u>	<u>330</u>	Feet from North Line of Lease
<u>1980</u>	<u>1980</u>	" " East " " "
		" " South " " "
		" " West " " "
		Feet from North Line of Section <u>1/4</u>
<u>990</u>	<u>990</u>	" " East " " "
<u>660</u>	<u>660</u>	" " South " " "
		" " West " " "

LEGEND

- Location
- ☀ Gas Well
- Oil Well
- ☀ Gas - Distillate Well
- ∅ or ○ Dry Hole
- Dry Showing Oil
- ☀ Dry Showing Gas
- ⊗ Abandoned Location
- ☀ or ☀ Abandoned Gas Well
- or ● Abandoned Oil Well
- or ○ Input Well

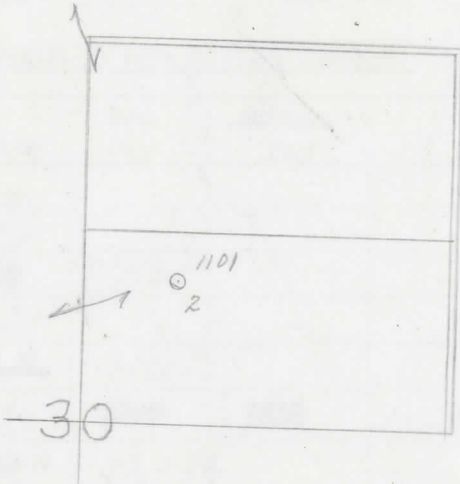

Scale _____

Remarks: _____

Submitted by CB Civil Engineer

Approved by _____ Division Manager

Approved by _____ Vice-President - General Manager

COMPLETION RECORD OF WELLS DRILLED BY OTHER OPERATORS

Michigan Producing Division

Date July 31, 1946 No. 1101
 State Michigan Co. Isabella Twp. Coldwater Sec. 30 Twp. 16 N Rge. 6 W
 Well No. 2 Serial No. 1101 Farm Laura B. Wilson Acres _____
 Operator Sohio Petroleum Company
 Date started 6-20-46 Date completed 7-25-46 Elevation 1054.5

PRODUCTION RECORD

1st 24 hours natural Estimated potential - 398 Bbls.
 Date of shot _____ No. of quarts _____ From _____ To _____ From _____ To _____
 Date of acid _____ No. of gallons _____ shot _____
 1st 24 hours after acid _____
 Completed as: Oil Well Gas Well _____ Dry Hole _____

FORMATION AND CASING RECORD

Formation	Top	Bottom	Top Pay	Bottom Pay	Remarks	Casing	
						Size	Set at
Brown Dolomite	1361	(-306)				10"	477
Mich. Stray	1466	(-411)				6-5/8"	1775
Marshall		1768	(-713)			5-3/16"	3807
Antrim	2593	(-1538)					
Traverse Lime	3213	S.L.M.	(-2158)				
Dundee	3806	(-2751)	3809	3816	(-2754)		
Total Depth		3816	(-2761)				

Remarks _____

Signed D. C. Shackelford