



Western Michigan University
ScholarWorks at WMU

Legacy Scout Tickets from Pure Oil Company

8-20-2021

**MGRRE_PureOilScoutTickets_Mogg, E R & ethel
M_2_21073126200000**

MGRRE
Western Michigan University

Follow this and additional works at: <https://scholarworks.wmich.edu/pure>



Part of the Geology Commons

WMU ScholarWorks Citation

MGRRE, "MGRRE_PureOilScoutTickets_Mogg, E R & ethel M_2_21073126200000" (2021). *Legacy Scout Tickets from Pure Oil Company*. 3784.
<https://scholarworks.wmich.edu/pure/3784>

This Document is brought to you for free and open access via ScholarWorks at WMU. It has been accepted for inclusion in Legacy Scout Tickets from Pure Oil Company by an authorized administrator of ScholarWorks at WMU. See the National Digital Catalogue - Science Base Catalogue for more collections submitted by MGRRE.



MGRRE_PureOilScoutTickets_Mogg, E R & ethel M_2_21073126200000

API 21073126200000

Permit Number 12620

Lease Name Mogg, E R & ethel M

Well Number 2

County Isabella

Township 15N

Range 04W

Section 12

2021 DEQ or Pure co_name Summit Petroleum Corporation

Pure Number 1112

Latitude 43.7030746

Longitude -84.7453987

THE PURE OIL COMPANY

LOCATION REPORT

Date Sept. 25, 1946

A.F.E. No. _____

E.R. Mogg & Ethel M. Mogg

Division Mich. Producing District _____

Lease E.R. Mogg & Ethel M. Mogg

Acres _____ Lease No. _____

Elevation _____

Well No. 2 (Serial No. 1112)

Quadrangle C-5/2 - NW-SW - 12

Sec. 12 Twp. 15 N

Rge. 4 W XBDK. Isabella
XDist. Isabella

Twp. Isabella

Survey _____ County Isabella

State Michigan

Operator Wittmer Oil & Gas Corporation

Map Isabella Township, Isabella County

330 330 Feet from North Line of Lease

" " East " " "

" " South " " "

656 656 " " West " " "

990 990 Feet from North Line of Section

" " East " " "

" " South " " "

656 656 " " West " " "

LEGEND

○ Location

☀ Gas Well

☀ Dry Showing Gas

● Oil Well

⊗ Abandoned Location

☀ Gas - Distillate Well

☀ or ⊗ Abandoned Gas Well

○ or ⊗ Dry Hole

● or ● Abandoned Oil Well

● Dry Showing Oil

● or ○ Input Well

Loc

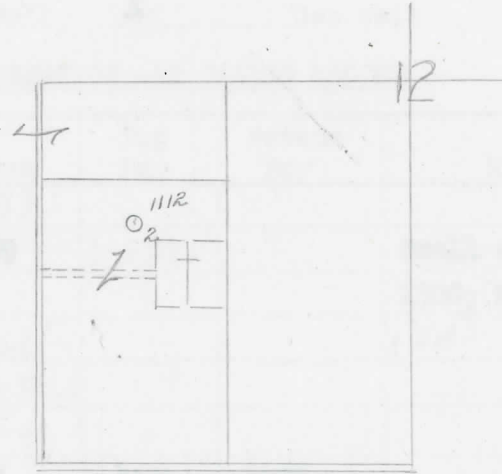

Scale _____

Remarks: _____

Submitted by CB Civil Engineer

Approved by _____ Division Manager

Approved by _____ Vice-President - General Manager

COMPLETION RECORD OF WELLS DRILLED BY OTHER OPERATORS

Michigan Producing DIVISION

Date December 31, 1946 No. 1112
 State Mich. Co. Isabella ~~District~~ Twp. Isabella Sec. 12 Twp. 15 N Rge. 4 W
 Well No. 2 Serial No. 1112 Farm Mogg Acres _____
 Operator Wittmer Oil & Gas Corp.
 Date started 10-21-46 Date completed 12-4-46 Elevation 772.1

PRODUCTION RECORD

1st 24 hours natural Filled up 1000 ft.
 Date of shot _____ No. of quarts _____ From _____ To _____ From _____ To _____
 Date of acid 12-20-46 No. of gallons 1000
 1st 24 hours after acid Flowing 42 Bbls. per day.
 Completed as: Oil Well Gas Well _____ Dry Hole _____

FORMATION AND CASING RECORD

Formation	Top	Bottom	Top Pay	Bottom Pay	Remarks	Casing	
						Size	Set at
Stray	1255	(-483)				10"	575
Marshall	1300	1559	(-528)		Small show gas at 1300; HFW 1320.	8-1/4"	966
Sunbury	2500	(-1728)			(-528) (-548)	6-5/8"	1562
Traverse Form.	3004	(-2232)				5-3/16"	3667
Traverse Lime	3012	(-2240)					
Dundee	3662	SLM.	3694	3697	(-2922)		
	(-2890)		3705	3710	(-2933)		
Total Depth		3710	(-2938)				

Remarks 3665' CTM equals 3667' SLM.

Signed Harry J. Gaspeny