



Western Michigan University  
ScholarWorks at WMU

---

Legacy Scout Tickets from Pure Oil Company

---

8-20-2021

**MGRRE\_PureOilScoutTickets\_Navarre et al\_1\_21073128120000**

MGRRE

*Western Michigan University*

Follow this and additional works at: <https://scholarworks.wmich.edu/pure>



Part of the Geology Commons

---

#### **WMU ScholarWorks Citation**

MGRRE, "MGRRE\_PureOilScoutTickets\_Navarre et al\_1\_21073128120000" (2021). *Legacy Scout Tickets from Pure Oil Company*. 3805.

<https://scholarworks.wmich.edu/pure/3805>

This Document is brought to you for free and open access via ScholarWorks at WMU. It has been accepted for inclusion in Legacy Scout Tickets from Pure Oil Company by an authorized administrator of ScholarWorks at WMU. See the National Digital Catalogue - Science Base Catalogue for more collections submitted by MGRRE.



---

**MGRRE\_PureOilScoutTickets\_Navarre et al\_1\_21073128120000**

API 21073128120000

Permit Number 12812

Lease Name Navarre et al

Well Number 1

County Isabella

Township 16N

Range 06W

Section 31

2021 DEQ or Pure co\_name Rex Oil and Gas Company

Pure Number 1134

Latitude 43.72825

Longitude -85.07391

WELL REPORT - OUTSIDE OPERATIONS

1134

SERIAL NO.

Michigan

XXX  
PSH  
CO.

Isabella

STATE

Rex Oil & Gas Company

OPERATOR

Navarre, et al

FARM

WELL NO.

1

Coldwater

31

16N

6W

TWP. SURVEY

S.

T.

R.

C E 1/2 SW SE

LOC.

WILDCAT  FIELD  FIELD NAME

MAP NO. CO-ORD. ELEV.

Total Depth 3741'.

STATUS

Plugged and Abandoned 5-8-50.

NORTH

DATE 7-17-50

SCOUT H. J. G.

THE PURE OIL COMPANY  
LOCATION REPORT

Date December 4, 1946 A.F.E. No. \_\_\_\_\_  
 Division Mich. Producing District \_\_\_\_\_ Lease Navarre, et al  
 Acres \_\_\_\_\_ Lease No. \_\_\_\_\_ Elevation \_\_\_\_\_ Well No. 1 (Serial No. 1134)  
 Quadrangle C E 1/2 SW SE Sec. 31 Twp. 16 N Rge. 6 W BKK D&K Coldwater  
Isabella Twp. Coldwater  
 Survey \_\_\_\_\_ County Isabella State Michigan  
 Operator Rex Oil & Gas Co. Map Coldwater Township, Isabella County

		Feet from North Line of Lease	
<u>330</u>	<u>330</u>	" "	East " " "
<u>660</u>	<u>660</u>	" "	South " " "
		" "	West " " "
		Feet from North Line of Section	
<u>660</u>	<u>660</u>	" "	East " " "
<u>990</u>	<u>990</u>	" "	South " " <u>1/4</u> "
		" "	West " " "

Low

LEGEND

- ☀ Gas Well
- Oil Well
- ☀ Gas - Distillate Well
- ∅ or ○ Dry Hole
- Dry Showing Oil
- Location
- ☀ Dry Showing Gas
- ⊗ Abandoned Location
- ☀ or ☀ Abandoned Gas Well
- or ● Abandoned Oil Well
- or ○ Input Well

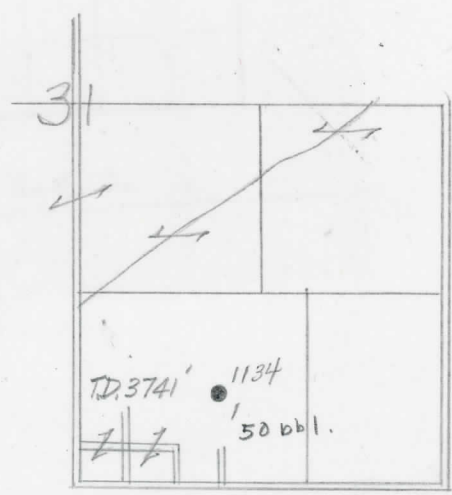

Remarks: \_\_\_\_\_ Scale \_\_\_\_\_

Submitted by CB Civil Engineer Approved by \_\_\_\_\_ Division Manager  
 Approved by \_\_\_\_\_ Vice-President - General Manager