



Western Michigan University
ScholarWorks at WMU

Legacy Scout Tickets from Pure Oil Company

8-20-2021

MGRRE_PureOilScoutTickets_Woodworth_1_unk

MGRRE

Western Michigan University

Follow this and additional works at: <https://scholarworks.wmich.edu/pure>



Part of the Geology Commons

WMU ScholarWorks Citation

MGRRE, "MGRRE_PureOilScoutTickets_Woodworth_1_unk" (2021). *Legacy Scout Tickets from Pure Oil Company*. 3810.

<https://scholarworks.wmich.edu/pure/3810>

This Document is brought to you for free and open access via ScholarWorks at WMU. It has been accepted for inclusion in Legacy Scout Tickets from Pure Oil Company by an authorized administrator of ScholarWorks at WMU. See the National Digital Catalogue - Science Base Catalogue for more collections submitted by MGRRE.



MGRRE_PureOilScoutTickets_Woodworth_1_unk

API unk

Permit Number unk

Lease Name Woodworth

Well Number 1

County Jackson

Township 02S

Range 01W

Section 22

2021 DEQ or Pure co_name unk

Pure Number 1

Latitude 42.2838313

Longitude -84.4135847

THE PURE OIL COMPANY

DATE June 30th 1928

LOCATION REPORT

No. 1STATE Michigan COUNTY Jackson DIST. Blackman SEC. 22 TOWN 3 S RANGE 1 WTWP.
PREC.WELL No. 1 (SERIAL No. 1) FARM Woodworth ACRES

NAME OF STREAM OR WATERS QUADRANGLE

OPERATOR MAP 4 Inches - 1 Mile

Feet from North Line of Farm

" " East " " "

" " South " " "

" " West " " "

Feet from North Line of Section

" " East " " "

" " South " " "

" " West " " "

LEGEND

○ LOCATION

① RIG

⊕ DRILLING

⊙ GAS WELL

● OIL WELL

⦿ SMALL OIL WELL

⊙ DRY HOLE

⦿ DRY SHOWING OIL

⊙ DRY SHOWING GAS

⦿ ABANDONED LOCATION

⦿ ABANDONED GAS WELL

⦿ ABANDONED OIL WELL

NOTE: Below make tracing from map (when no map is obtainable make sketch), showing farm, center of section, this location with measurements and also wells, dry holes, or other locations in the vicinity of this location. Make copy to keep for reference and send original to Columbus office.

Elevation

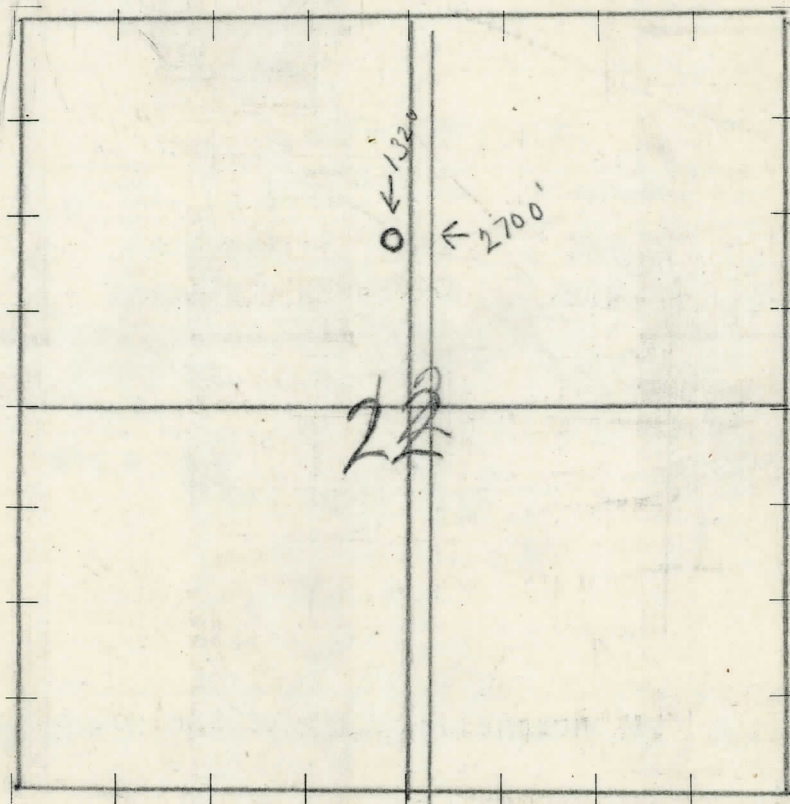
970

N



REMARKS:

SIGNED

Superintendent or Foreman.

STATE Mich COUNTY Jackson DIST. Blackman SEC. 22 TOWN 2S RANGE 1W
 DATE May 9 1948 LOCATION REPORT No. _____
 WELL No. _____ (SERIAL No. 1) FARM Woodworth ACRES _____
 NAME OF STREAM OR WATERS _____ QUADRANGLE 46-1-11-1
 OPERATOR _____ MAP 1" = 1 mi.

_____ Feet from North Line of Farm
 _____ " " East " " "
 _____ " " South " " "
 _____ " " West " " "
1320 Feet from North Line of Section
2700 " " East " " "
 _____ " " South " " "
 _____ " " West " " "

LEGEND

○ LOCATION	⊗ DRY HOLE
⊕ RIG	⬢ DRY SHOWING OIL
⊕ DRILLING	⊗ DRY SHOWING GAS
⊗ GAS WELL	⊗ ABANDONED LOCATION
● OIL WELL	⊗ ABANDONED GAS WELL
⬢ SMALL OIL WELL	⬢ ABANDONED OIL WELL

NOTE: Below make tracing from map (when no map is obtainable make sketch), showing farm, center of section, this location with measurements and also wells, dry holes, or other locations in the vicinity of this location. Make copy to keep for reference and send original to Columbus office.

Elev 970

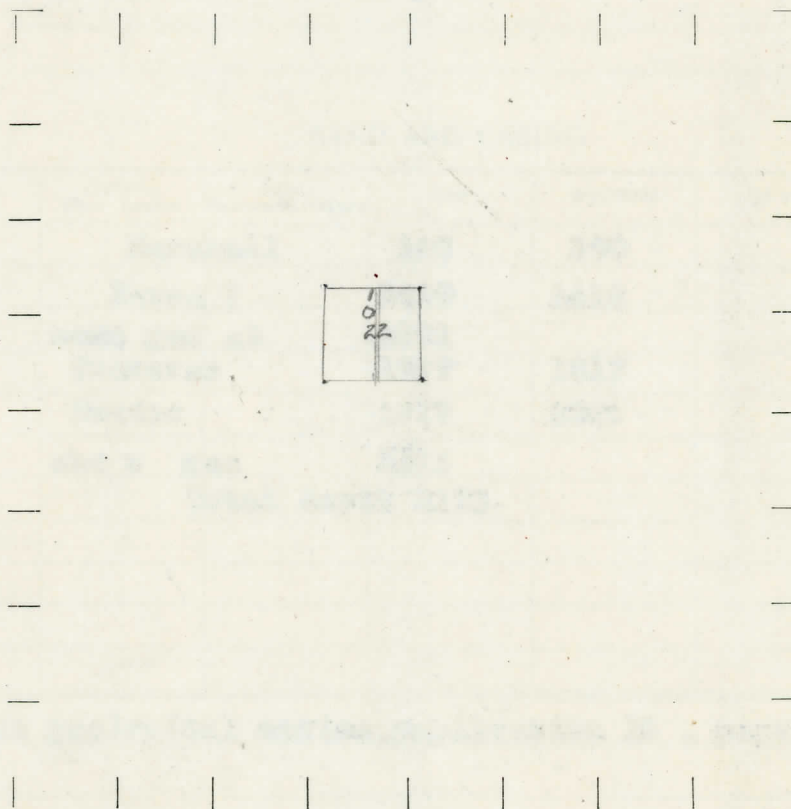

REMARKS:

SIGNED

Superintendent or Foreman.

DIVISION

140

COMPLETION RECORD

No. 1

WELL No. _____ (SERIAL No. _____) FARM Woodworth _____ ACRES

OPERATOR _____ MAP _____ 4 inches - 1 Mile

WELL STARTED (DATE) _____ WELL COMPLETED (DATE) _____

GAS WELL

DRY HOLE

ABANDONED WELL

DATE OF SHOT _____ NUMBER OF QUARTS _____

BARRELS OR FEET

5th " " " " " "

SAND AND CASING

[illegible]

REMARKS Michigan geological series publication 14 , page 161

SIGNED

SUPT. OR FOREMAN

DESCRIPTION	QUANTITY	MAKE	SIZE	MATERIAL
-------------	----------	------	------	----------

Pub-14, Page 161

Marshall 140-300

Berea ? 1410-1418 red shale

some gas at 1601
Laurel 1767-1817

Dunder 1817-2054

show gas 2163,

T D 2173