



Western Michigan University
ScholarWorks at WMU

Legacy Scout Tickets from Pure Oil Company

8-20-2021

MGRRE_PureOilScoutTickets_Jackson County_1_21075005189000

MGRRE
Western Michigan University

Follow this and additional works at: <https://scholarworks.wmich.edu/pure>



Part of the Geology Commons

WMU ScholarWorks Citation

MGRRE, "MGRRE_PureOilScoutTickets_Jackson County_1_21075005189000" (2021). *Legacy Scout Tickets from Pure Oil Company*. 3811.
<https://scholarworks.wmich.edu/pure/3811>

This Document is brought to you for free and open access via ScholarWorks at WMU. It has been accepted for inclusion in Legacy Scout Tickets from Pure Oil Company by an authorized administrator of ScholarWorks at WMU. See the National Digital Catalogue - Science Base Catalogue for more collections submitted by MGRRE.



MGRRE_PureOilScoutTickets_Jackson County_1_21075005189000

API 21075005189000

Permit Number 518

Lease Name Jackson County

Well Number 1

County Jackson

Township 03S

Range 02E

Section 31

2021 DEQ or Pure co_name Jackson County Oil and Gas Company

Pure Number 2

Latitude 42.16015

Longitude -84.2408

Converted Location Report

THE PURE OIL COMPANY

DATE June 16th 1928

LOCATION REPORT

No. 2

STATE Michigan COUNTY Jackson DIST. Napoleon SEC. 31 TOWN 35 RANGE 1 E

WELL No. 1 (SERIAL No. 2) FARM ACRES

NAME OF STREAM OR WATERS QUADRANGLE

OPERATOR MAP 4" = 1 Mile.

Feet from North Line of Farm

" " East " " "

" " South " " "

" " West " " "

Feet from North Line of Section

" " East " " "

" " South " " "

" " West " " "

LEGEND

O LOCATION

① RIG

⊕ DRILLING

⊙ GAS WELL

● OIL WELL

⦿ SMALL OIL WELL

⦿ DRY HOLE

⦿ DRY SHOWING OIL

⦿ DRY SHOWING GAS

⦿ ABANDONED LOCATION

⦿ ABANDONED GAS WELL

⦿ ABANDONED OIL WELL

NOTE: Below make tracing from map (when no map is obtainable make sketch), showing farm, center of section, this location with measurements and also wells, dry holes, or other locations in the vicinity of this location. Make copy to keep for reference and send original to Columbus office.

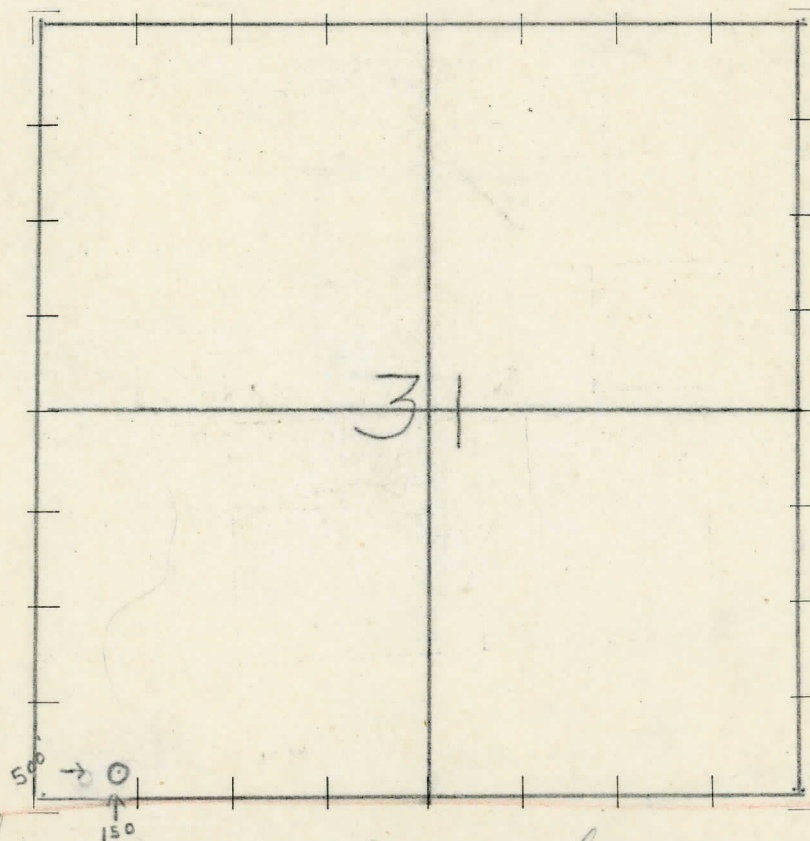

REMARKS:

Change of Township. There are two Sections 31 in Napoleon Twp. This is East Section 31

SIGNED

Superintendent or Foreman.

STATE Mich COUNTY Jackson DIST. Napoleon SEC. 31 TOWN 38 RANGE 1 E
DATE _____ LOCATION REPORT No. 2
WELL No. _____ (SERIAL No. _____) FARM _____ ACRES
NAME OF STREAM OR WATERS _____ QUADRANGLE _____
OPERATOR _____ MAP 1" = 1 mi

Feet from North Line of Farm

" " East " " "

" " South " " "

" " West " " "

Feet from North Line of Section

" " East " " "

150 " " South " " "

500 " " West " " "

○ LOCATION

① RIG

⊕ DRILLING

☼ GAS WELL

● OIL WELL

⦿ SMALL OIL WELL

LEGEND

⦿ DRY HOLE

⦿ DRY SHOWING OIL

⦿ DRY SHOWING GAS

⦿ ABANDONED LOCATION

⦿ ABANDONED GAS WELL

⦿ ABANDONED OIL WELL

NOTE: Below make tracing from map (when no map is obtainable make sketch), showing farm, center of section, this location with measurements and also wells, dry holes, or other locations in the vicinity of this location. Make copy to keep for reference and send original to Columbus office.

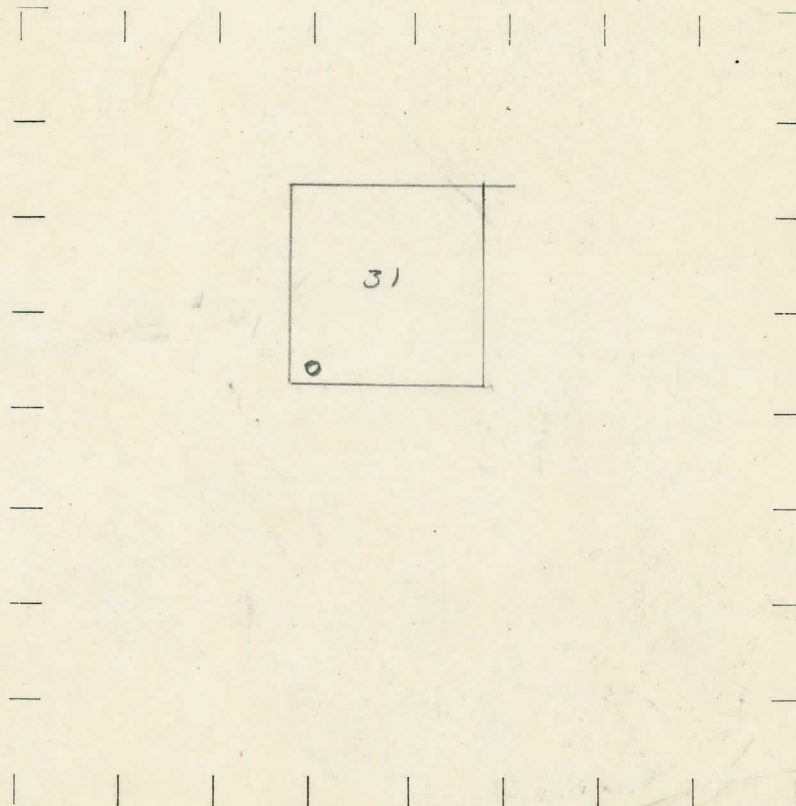

N



REMARKS:

SIGNED

Superintendent or Foreman.

Change of Township.
There are 2 Sec. 31 in
Napoleon Twp. This is
last sec. 31

DATE June 30th 1928

LOCATION REPORT

No. 6STATE Michigan COUNTY Jackson DIST. Napoleon SEC. 31 TOWN 3 S RANGE 1E
TWP. Napoleon PREC.WELL No. 1 (SERIAL No. 2) FARM Jackson Co. Oil & Gas Co. ACRES

NAME OF STREAM OR WATERS _____ QUADRANGLE _____

OPERATOR Jackson Co. Oil & Gas Co. MAP 4 Inches - 1 mile

Feet from North Line of Farm

" " East " " "

" " South " " "

" " West " " "

Feet from North Line of Section

" " East " " "

150

" " South " " "

560

" " West " " "

LEGEND

○ LOCATION

① RIG

⊕ DRILLING

⊙ GAS WELL

● OIL WELL

⊙ SMALL OIL WELL

⊙ DRY HOLE

⊙ DRY SHOWING OIL

⊙ DRY SHOWING GAS

⊙ ABANDONED LOCATION

⊙ ABANDONED GAS WELL

⊙ ABANDONED OIL WELL

NOTE: Below make tracing from map (when no map is obtainable make sketch), showing farm, center of section, this location with measurements and also wells, dry holes, or other locations in the vicinity of this location. Make copy to keep for reference and send original to Columbus office.

Elevation

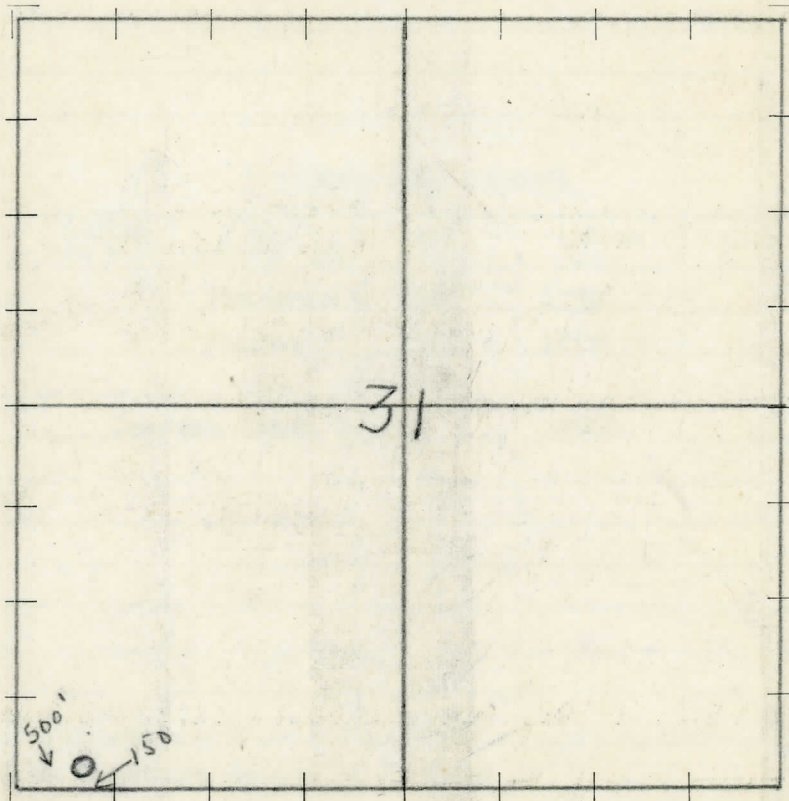
978

REMARKS:

SIGNED

Superintendent or Foreman.

No. 45

No. 2

SIGNED _____ SUPT. OR FOREMAN

| DESCRIPTION | QUANTITY | MAKE | SIZE | MATERIAL |
|-------------|----------|------|------|----------|
|-------------|----------|------|------|----------|

LIST OF MATERIAL CHARGEABLE TO WELL No.

DATE May 9 1928 LOCATION REPORT No. _____
 STATE Mich COUNTY Jackson DIST. Napoleon SEC. 31 TOWN 3S RANGE 1E
 WELL No. 1 (SERIAL No. 2) FARM Jackson Co Oil & Gas Co ACRES _____
 NAME OF STREAM OR WATERS _____ QUADRANGLE _____
 OPERATOR Jackson Co Oil & Gas Co MAP 1/2" = 1 mi.

Feet from North Line of Farm

" " East " " "
 " " South " " "
 " " West " " "

Feet from North Line of Section

1500 " " East " " "
1500 " " South " " "
500 " " West " " "

LEGEND

- | | |
|------------------|----------------------|
| ○ LOCATION | ⊕ DRY HOLE |
| ⊕ RIG | ⊕ DRY SHOWING OIL |
| ⊕ DRILLING | ⊕ DRY SHOWING GAS |
| ⊕ GAS WELL | ⊕ ABANDONED LOCATION |
| ● OIL WELL | ⊕ ABANDONED GAS WELL |
| ⊕ SMALL OIL WELL | ⊕ ABANDONED OIL WELL |

NOTE: Below make tracing from map (when no map is obtainable make sketch), showing farm, center of section, this location with measurements and also wells, dry holes, or other locations in the vicinity of this location. Make copy to keep for reference and send original to Columbus office.

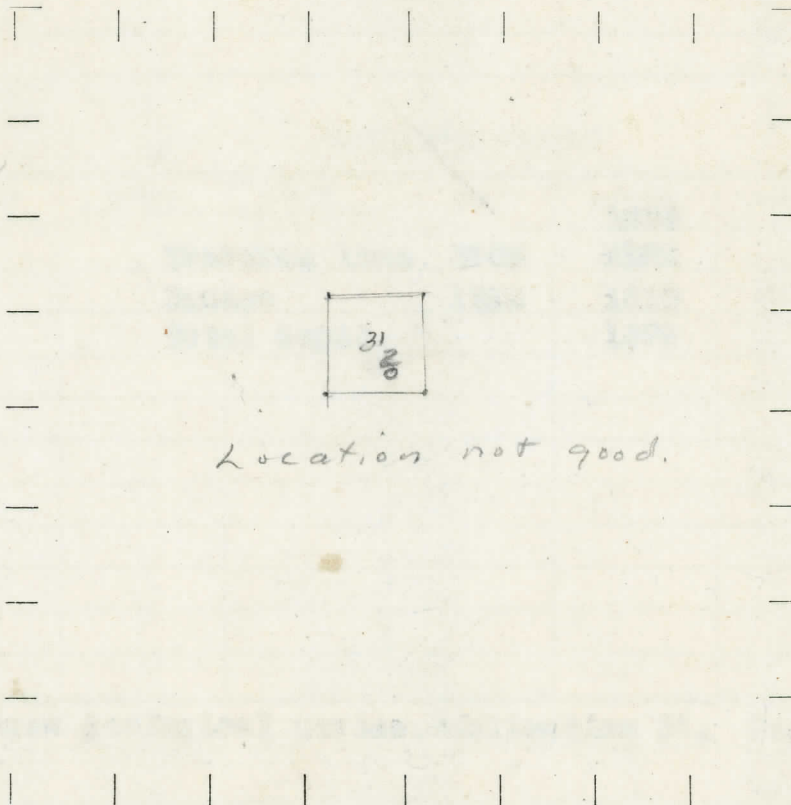

REMARKS:

SIGNED

Superintendent or Foreman.

| | | | | |
|-------------|----------|------|------|----------|
| DESCRIPTION | QUANTITY | MAKE | SIZE | MATERIAL |
|-------------|----------|------|------|----------|

Traverse

→ 1605-1770

Dundee 1762-1810

T.D. 1876