



Western Michigan University
ScholarWorks at WMU

Legacy Scout Tickets from Pure Oil Company

8-20-2021

MGRRE_PureOilScoutTickets_Micigan State Prison_1_unk

MGRRE

Western Michigan University

Follow this and additional works at: <https://scholarworks.wmich.edu/pure>



Part of the Geology Commons

WMU ScholarWorks Citation

MGRRE, "MGRRE_PureOilScoutTickets_Micigan State Prison_1_unk" (2021). *Legacy Scout Tickets from Pure Oil Company*. 3814.

<https://scholarworks.wmich.edu/pure/3814>

This Document is brought to you for free and open access via ScholarWorks at WMU. It has been accepted for inclusion in Legacy Scout Tickets from Pure Oil Company by an authorized administrator of ScholarWorks at WMU. See the National Digital Catalogue - Science Base Catalogue for more collections submitted by MGRRE.



MGRRE_PureOilScoutTickets_Micigan State Prison_1_unk

API unk

Permit Number unk

Lease Name Micigan State Prison

Well Number 1

County Jackson

Township 02S

Range 01W

Section 14

2021 DEQ or Pure co_name State of Michgian

Pure Number 7

Latitude 42.2983844

Longitude -84.3939741

THE PURE OIL COMPANY

DATE **JUN 23 1928**

LOCATION REPORT

No. **7**STATE **Michigan** COUNTY **Jackson** DIST. **Blackman** SEC. **14** TOWN **25** RANGE **1W**WELL No. (SERIAL No. **17**) FARM **Michigan State Prison** ACRES

NAME OF STREAM OR WATERS QUADRANGLE

OPERATOR **State of Michigan** MAP **4 inches = 1 mile**

Feet from North Line of Farm

" " East " " "

" " South " " "

" " West " " "

Feet from North Line of Section

" " East " " "

" " South " " "

" " West " " "

LEGEND

O LOCATION

① RIG

⊕ DRILLING

⊗ GAS WELL

● OIL WELL

⦿ SMALL OIL WELL

⊗ DRY HOLE

⦿ DRY SHOWING OIL

⊗ DRY SHOWING GAS

⦿ ABANDONED LOCATION

⊗ ABANDONED GAS WELL

⦿ ABANDONED OIL WELL

NOTE: Below make tracing from map (when no map is obtainable make sketch), showing farm, center of section, this location with measurements and also wells, dry holes, or other locations in the vicinity of this location. Make copy to keep for reference and send original to Columbus office.

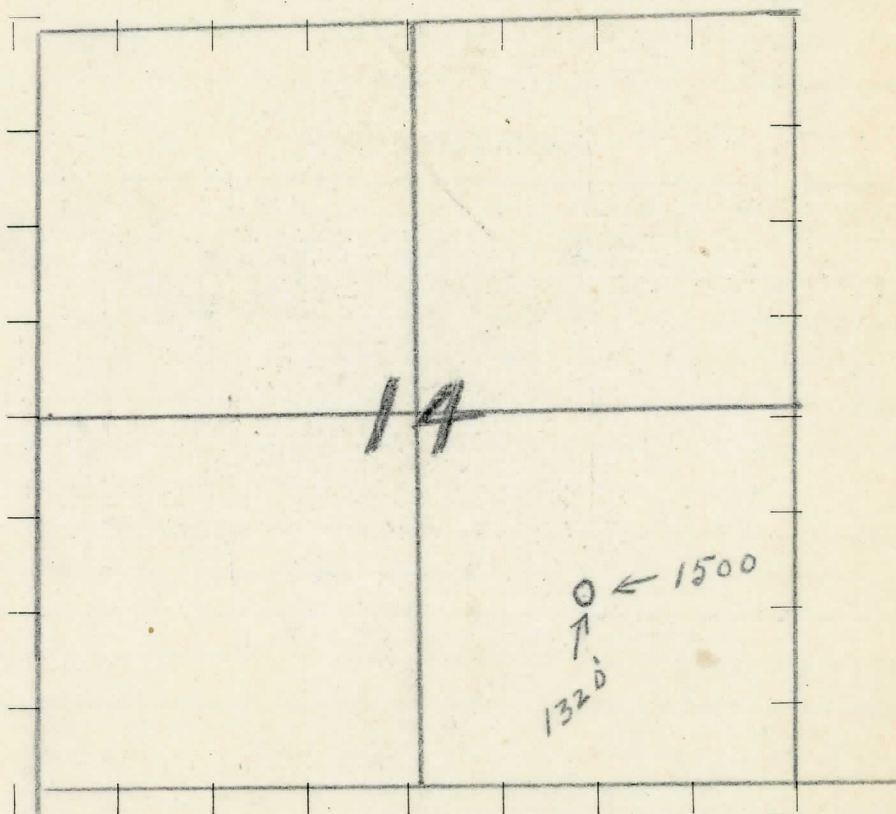

REMARKS:

SIGNED

Superintendent or Foreman.

THE PURE OIL COMPANY

DATE

JUN 23 1928

LOCATION REPORT

No. 77

STATE Mich COUNTY Jackson DIST. Blackman SEC. 14 TOWN 25 RANGE 1WTWP.
PREC.WELL No. (SERIAL No. 10) FARM Mich State Prison ACRES

NAME OF STREAM OR WATERS QUADRANGLE

OPERATOR State of Mich MAP 1/2" = 1 mi

Feet from North Line of Farm

" " East " " "

" " South " " "

" " West " " "

Feet from North Line of Section

1500 " " East " " "

1320 " " South " " "

" " West " " "

LEGEND

O LOCATION

① RIG

⊕ DRILLING

⊗ GAS WELL

● OIL WELL

⬮ SMALL OIL WELL

⊗ DRY HOLE

⬮ DRY SHOWING OIL

⊗ DRY SHOWING GAS

⊗ ABANDONED LOCATION

⬮ ABANDONED GAS WELL

⬮ ABANDONED OIL WELL

NOTE: Below make tracing from map (when no map is obtainable make sketch), showing farm, center of section, this location with measurements and also wells, dry holes, or other locations in the vicinity of this location. Make copy to keep for reference and send original to Columbus office.

Elev

919.5



N

REMARKS:

SIGNED

Superintendent or Foreman.

7004 83 1258

NO

THE LOVE OF COMPANY

Saginaw Michigan Special DIVISION

DATE JUN 23 1928

COMPLETION RECORD

No. 7

STATE Michigan COUNTY Jackson DIST. Blackmar TWP. 14 SEC. 25 TOWN 14

WELL No. 1 (SERIAL No. 51) FARM Michigan State Prison ACRES

NAME OF STREAM OR WATERS _____ QUADRANGLE _____

OPERATOR State of Michigan MAP 4 = 1 mile

LOCATION REPORT SENT IN (DATE) June 23rd 1928

WELL STARTED (DATE) _____ WELL COMPLETED (DATE) _____

OIL WELL

GAS WELL

~~DRY HOLE~~

ABANDONED WELL

(Water Well)

CROSS OUT THREE OF THE ABOVE
WELL RECORD

DATE OF SHOT _____ NUMBER OF QUARTS. _____

1st 24 HOURS PRODUCTION				BARRELS OR FEET		
2nd	"	"	"		"	"
3rd	"	"	"		"	"
4th	"	"	"		"	"
5th	"	"	"		"	"

SAND AND CASING

[illegible][illegible]

NOTE:—MAKE COPY TO KEEP FOR REFERENCE AND SEND ORIGINAL TO CHICAGO OFFICE. LIST MATERIAL CHARGEABLE TO WELL ON OTHER SIDE.

SIGNED

SUPT. OR FOREMAN

DESCRIPTION	QUANTITY	MAKE	SIZE	MATERIAL
-------------	----------	------	------	----------

LIST OF MATERIAL CHARGEABLE TO WELL NO.

Drift 0-48
Marshall 80-263

T.D. 263

JUN 23 1928