



Western Michigan University  
ScholarWorks at WMU

---

Legacy Scout Tickets from Pure Oil Company

---

8-20-2021

**MGRRE\_PureOilScoutTickets\_Mulvaney\_1\_21075026310000**

MGRRE

*Western Michigan University*

Follow this and additional works at: <https://scholarworks.wmich.edu/pure>



Part of the Geology Commons

---

#### **WMU ScholarWorks Citation**

MGRRE, "MGRRE\_PureOilScoutTickets\_Mulvaney\_1\_21075026310000" (2021). *Legacy Scout Tickets from Pure Oil Company*. 3816.

<https://scholarworks.wmich.edu/pure/3816>

This Document is brought to you for free and open access via ScholarWorks at WMU. It has been accepted for inclusion in Legacy Scout Tickets from Pure Oil Company by an authorized administrator of ScholarWorks at WMU. See the National Digital Catalogue - Science Base Catalogue for more collections submitted by MGRRE.



---

**MGRRE\_PureOilScoutTickets\_Mulvaney\_1\_21075026310000**

API 21075026310000

Permit Number 2631

Lease Name Mulvaney

Well Number 1

County Jackson

Township 01S

Range 01E

Section 31

2021 DEQ or Pure co\_name Petroleum and Gas Development Company, Incorporated

Pure Number 9

Latitude 42.34658

Longitude -84.34981

DATE July 26, 1935  
7/25/35

LOCATION REPORT

No. 9

STATE Mich. Michigan COUNTY Jackson DIST. Henrietta TWP. Henrietta SEC. 31 TOWN. 1S RANGE 1E

WELL No. 1 (SERIAL No. 99) FARM Mulvaney ACRES

NAME OF STREAM OR WATERS QUADRANGLE NE-SE-NE  
NE-SE-NE

OPERATOR Petroleum & Gas Development Co., Inc. Map Henrietta Township, Jackson Co.  
Petroleum & Gas Development Company

Feet from North Line of Farm

300 300 " " East " " "

1120 1120 " " South " " "

" " West " " "

Feet from North Line of Section

1520 520 " " East " " 1/4

300 300 " " South " " "

" " West " " "

LEGEND

- LOCATION
- ⊕ RIG
- ⊕ DRILLING
- ☀ GAS WELL
- OIL WELL
- ⊕ SMALL OIL WELL
- ⊕ DRY HOLE
- DRY SHOWING OIL
- ⊕ DRY SHOWING GAS
- ⊕ ABANDONED LOCATION
- ☀ ABANDONED GAS WELL
- ABANDONED OIL WELL

NOTE: Below make tracing from map, (when no map is obtainable make sketch) showing farm, center of section, this location with measurements and also wells, dry holes, or other locations in the vicinity of this location.

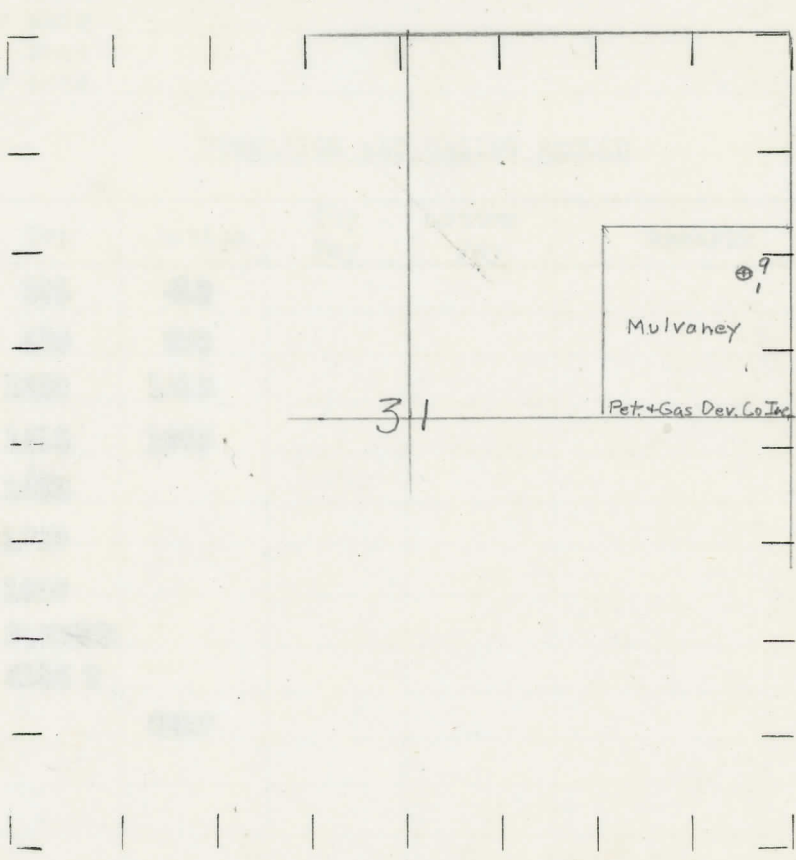

REMARKS:

SIGNED

R. P. Yeager  
Superintendent or Foreman.

Per # 2631

THE LAKE ON CONEYZA  
COMPLETION RECORD OF WELLS DRILLED BY OTHER OPERATORS

Mich. Producing Division

Date Dec. 5, 1935 No. 9  
 State Mich. County Jackson Dist. \_\_\_\_\_  
 (Serial No.) Twp. Henrietta Sec. 31 Twp. 1 S Rge. 1 E  
 Well No. 1 (County No.) 9 Farm Milvaney Acres \_\_\_\_\_  
 Operator Petroleum & Gas Dev. Co., Inc. Information secured ~~from~~ Scouting Dept. by \_\_\_\_\_  
 Date well started 7-21-35 Date well completed 11-27-35 Elevation 949

PRODUCTION RECORD

1st 24 hours natural Dry Hole  
 2nd 24 hours natural \_\_\_\_\_  
 Date of shot \_\_\_\_\_ No. of quarts \_\_\_\_\_ From \_\_\_\_\_ to \_\_\_\_\_ From \_\_\_\_\_ to \_\_\_\_\_  
 Date of acid \_\_\_\_\_ No. of gallons \_\_\_\_\_  
 1st 24 hours after acid shot \_\_\_\_\_  
 2nd 24 hours after acid shot \_\_\_\_\_

FORMATION AND CASING RECORD

Formation	Top	Bottom	Top Pay	Bottom Pay	Remarks	Casing	
						Size	Set at
Marshall	275	410				10"	137
Red Rock	410	570				8 1/2"	620
Red Rock	1600	1615				6-5/8"	2089
Sunbury	1615	1635					
Berea	1635						
Antrim	1730						
Traverse	1950						
Dundee	2109SLM						
Monroe	2185 ?						
Total Depth		2217					

Remarks Show gas 1776 - show oil 1955 - H.F.S.W. 1980 - Rainbow oil 2103 - 1 Bailer  
Black Water 2146 - 3 Bailers Black Water 2185.

Signed G.H. Bell