



Western Michigan University
ScholarWorks at WMU

Legacy Scout Tickets from Pure Oil Company

8-20-2021

MGRRE_PureOilScoutTickets_Upjohn Unemployment Corp._1_21077063700000

MGRRE

Western Michigan University

Follow this and additional works at: <https://scholarworks.wmich.edu/pure>



Part of the Geology Commons

WMU ScholarWorks Citation

MGRRE, "MGRRE_PureOilScoutTickets_Upjohn Unemployment Corp._1_21077063700000" (2021). *Legacy Scout Tickets from Pure Oil Company*. 3841.
<https://scholarworks.wmich.edu/pure/3841>

This Document is brought to you for free and open access via ScholarWorks at WMU. It has been accepted for inclusion in Legacy Scout Tickets from Pure Oil Company by an authorized administrator of ScholarWorks at WMU. See the National Digital Catalogue - Science Base Catalogue for more collections submitted by MGRRE.



MGRRE_PureOilScoutTickets_Upjohn Unemployment Corp._1_21077063700000

API 21077063700000

Permit Number 6370

Lease Name Upjohn Unemployment Corp.

Well Number 1

County Kalamazoo

Township 01S

Range 10W

Section 32

2021 DEQ or Pure co_name Twin Drilling Company

Pure Number 12

Latitude 42.33818

Longitude -85.5119

THE PURE OIL COMPANY

DATE June 22, 1939

LOCATION REPORT

No. 12

STATE Mich. COUNTY Kalamazoo DIST. Richland TWP. Richland SEC. 32 TOWN 1 S RANGE 10 W

WELL No. 1 (SERIAL No. 12) FARM Upjohn Unemployment Corp. ACRES

NAME OF STREAM OR WATERS _____ QUADRANGLE CW-1-NW-SW

OPERATOR Twin Drilling Company Map Richland Township, Kalamazoo County

6660 Feet from North Line of Farm

“ “ East “ “ “

“ “ South “ “ “

3330 “ “ West “ “ “

6660 Feet from North Line of Section

“ “ East “ “ “

“ “ South “ “ “

3330 “ “ West “ “ “

LEGEND

- LOCATION
- ⊙ RIG
- ⊕ DRILLING
- ☀ GAS WELL
- OIL WELL
- ⦿ SMALL OIL WELL
- ⊖ DRY HOLE
- ⦿ DRY SHOWING OIL
- ⊖ DRY SHOWING GAS
- ⊖ ABANDONED LOCATION
- ☀ ABANDONED GAS WELL
- ⦿ ABANDONED OIL WELL

NOTE: Below make tracing from map, (when no map is obtainable make sketch) showing farm, center of section, this location with measurements and also wells, dry holes, or other locations in the vicinity of this location.

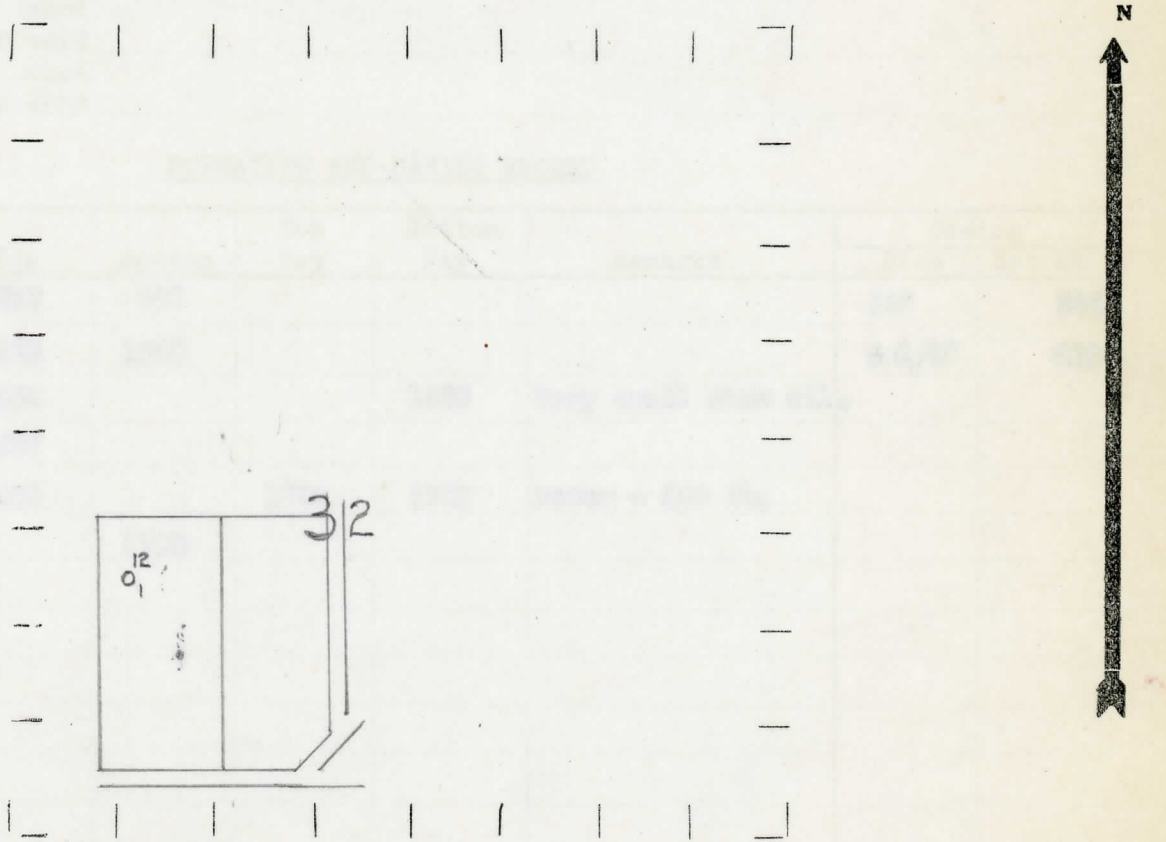

REMARKS: _____

SIGNED _____

Superintendent or Foreman.

COMPLETION RECORD OF WELLS DRILLED BY OTHER OPERATORS

Michigan Producing Division

Date July 20, 1939 No. 12
 State Mich. County Kalamazoo ~~Dist.~~ Twp. Richland Sec. 32 Twp. 1 S Rge. 10 W
 Well No. 1 (Serial No.) 12 Farm Upjohn Unemployment Corp. Acres _____
 Operator Twin Drilling Company Information secured ~~from~~ By Scouting Department
 Date well started 6-23-39 Dated well completed 7-13-39 Elevation 913.3

PRODUCTION RECORD

1st 24 hours natural Dry Hole
 2nd 24 hours natural _____
 Date of shot _____ No. of quarts _____ From _____ to _____ From _____ to _____
 Date of acid _____ No. of gallons _____
 shot _____
 1st 24 hours after acid _____
 shot _____
 2nd 24 hours after acid _____

FORMATION AND CASING RECORD

Formation	Top	Bottom	Top Pay	Bottom Pay	Remarks	Casing	
						Size	Set at
Red Rock	942	957				10"	222
Antrim	1262	1390				8-1/4"	330
Traverse Lime	1459			1460	Very small show oil.		
Dundee	1667						
Monroe	1673		1700	1701	Water - 500 ft.		
Total Depth		1705					

Remarks Small show salt water from 1495' to 1500'. 1426' C.T.M. equals 1428' S.L.M.

Signed D. C. Shackelford