



Western Michigan University
ScholarWorks at WMU

Legacy Scout Tickets from Pure Oil Company

8-20-2021

MGRRE_PureOilScoutTickets_Lamb, Sam D._1_21077066260000

MGRRE

Western Michigan University

Follow this and additional works at: <https://scholarworks.wmich.edu/pure>



Part of the Geology Commons

WMU ScholarWorks Citation

MGRRE, "MGRRE_PureOilScoutTickets_Lamb, Sam D._1_21077066260000" (2021). *Legacy Scout Tickets from Pure Oil Company*. 3846.

<https://scholarworks.wmich.edu/pure/3846>

This Document is brought to you for free and open access via ScholarWorks at WMU. It has been accepted for inclusion in Legacy Scout Tickets from Pure Oil Company by an authorized administrator of ScholarWorks at WMU. See the National Digital Catalogue - Science Base Catalogue for more collections submitted by MGRRE.



MGRRE_PureOilScoutTickets_Lamb, Sam D._1_21077066260000

API 21077066260000

Permit Number 6626

Lease Name Lamb, Sam D.

Well Number 1

County Kalamazoo

Township 03S

Range 09W

Section 6

2021 DEQ or Pure co_name Smith Petroleum Company

Pure Number 17

Latitude 42.23963

Longitude -85.39564

THE PURE OIL COMPANY
LOCATION REPORT

DATE August 17, 1939
AUG 19-1939

No. 17

STATE Michigan COUNTY Kalamazoo DIST. Climax TWP. Climax SEC. 6 TOWN 3 S RANGE 9 W
WELL No. 1 (SERIAL No. 17) FARM Sam D. Lamb ACRES
NAME OF STREAM OR WATERS. QUADRANGLE C E 1/2 SE NE
OPERATOR Smith Petroleum Company Map Climax Township, Kalamazoo County
Smith Petroleum Co. Climax - Kalamazoo Co.

Feet from North Line of Farm
33830 " " East " " "
660860 " " South " " "
" " West " " "
Feet from North Line of Section
33830 " " East " 1/4 "
660860 " " South " 1/4 "
" " West " " "

LEGEND

- LOCATION
- ⊕ RIG
- ⊕ DRILLING
- ☀ GAS WELL
- OIL WELL
- ⊕ SMALL OIL WELL
- ⊖ DRY HOLE
- ⊕ DRY SHOWING OIL
- ⊖ DRY SHOWING GAS
- ⊖ ABANDONED LOCATION
- ☀ ABANDONED GAS WELL
- ⊖ ABANDONED OIL WELL

NOTE: Below make tracing from map, (when no map is obtainable make sketch) showing farm, center of section, this location with measurements and also wells, dry holes, or other locations in the vicinity of this location.

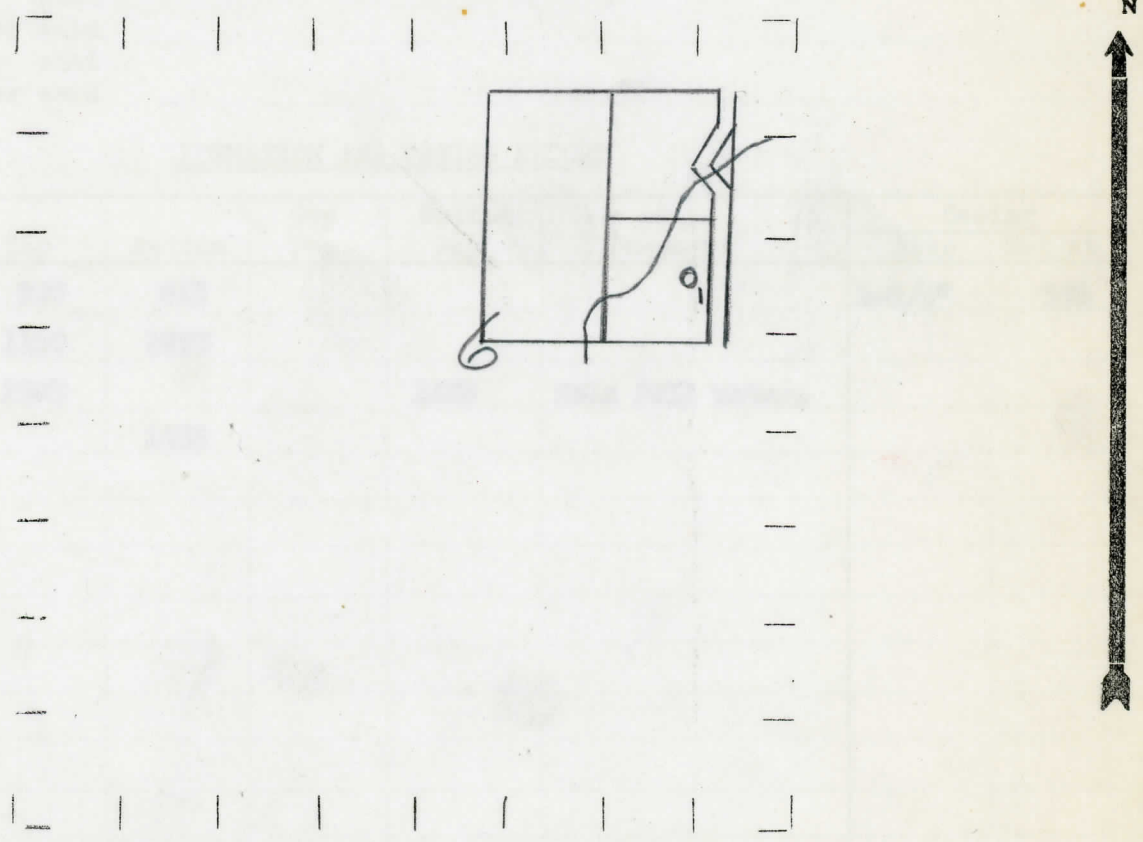

REMARKS:

SIGNED

Superintendent or Foreman.

