



Western Michigan University
ScholarWorks at WMU

Legacy Scout Tickets from Pure Oil Company

8-20-2021

**MGRRE_PureOilScoutTickets_Kinney,
Phoebe_1_21077074190000**

MGRRE
Western Michigan University

Follow this and additional works at: <https://scholarworks.wmich.edu/pure>



Part of the Geology Commons

WMU ScholarWorks Citation

MGRRE, "MGRRE_PureOilScoutTickets_Kinney, Phoebe_1_21077074190000" (2021). *Legacy Scout Tickets from Pure Oil Company*. 3858.
<https://scholarworks.wmich.edu/pure/3858>

This Document is brought to you for free and open access via ScholarWorks at WMU. It has been accepted for inclusion in Legacy Scout Tickets from Pure Oil Company by an authorized administrator of ScholarWorks at WMU. See the National Digital Catalogue - Science Base Catalogue for more collections submitted by MGRRE.



MGRRE_PureOilScoutTickets_Kinney, Phoebe_1_21077074190000

API 21077074190000

Permit Number 7419

Lease Name Kinney, Phoebe

Well Number 1

County Kalamazoo

Township 04S

Range 12W

Section 5

2021 DEQ or Pure co_name Malcom, R. D.

Pure Number 29

Latitude 42.14302

Longitude -85.73679

THE PURE OIL COMPANY

DATE March 6, 1940

LOCATION REPORT

No. 29

STATE Michigan

COUNTY Kalamazoo

Kalamazoo

DIST. Prairie Ronde
TWP. Prairie Ronde
REC. Phoebe Kinney

SEC. 55

TOWN 4S

RANGE 12 W

12 W

WELL No. 1 (SERIAL No. 29) FARM _____ ACRES _____

NAME OF STREAM OR WATERS _____

QUADRANGLE SE SE SW SW

OPERATOR R. D. Malcolm, Trustee

Map Prairie Ronde Township, Kalamazoo County

Prairie Ronde - Kalamazoo

R. D. Malcolm Tr.

Feet from North Line of Farm

330 ³⁰

" " East " " "

330 ³⁰

" " South " " "

" " West " " "

Feet from North Line of Section

330 ³⁰

" " East 1/4 "

330 ³⁰

" " South 1/4 "

" " West " " "

LEGEND

○ LOCATION

⊕ RIG

⊕ DRILLING

☀ GAS WELL

● OIL WELL

⊕ SMALL OIL WELL

⊕ DRY HOLE

⊕ DRY SHOWING OIL

⊕ DRY SHOWING GAS

⊕ ABANDONED LOCATION

⊕ ABANDONED GAS WELL

⊕ ABANDONED OIL WELL

NOTE: Below make tracing from map, (when no map is obtainable make sketch) showing farm, center of section, this location with measurements and also wells, dry holes, or other locations in the vicinity of this location.

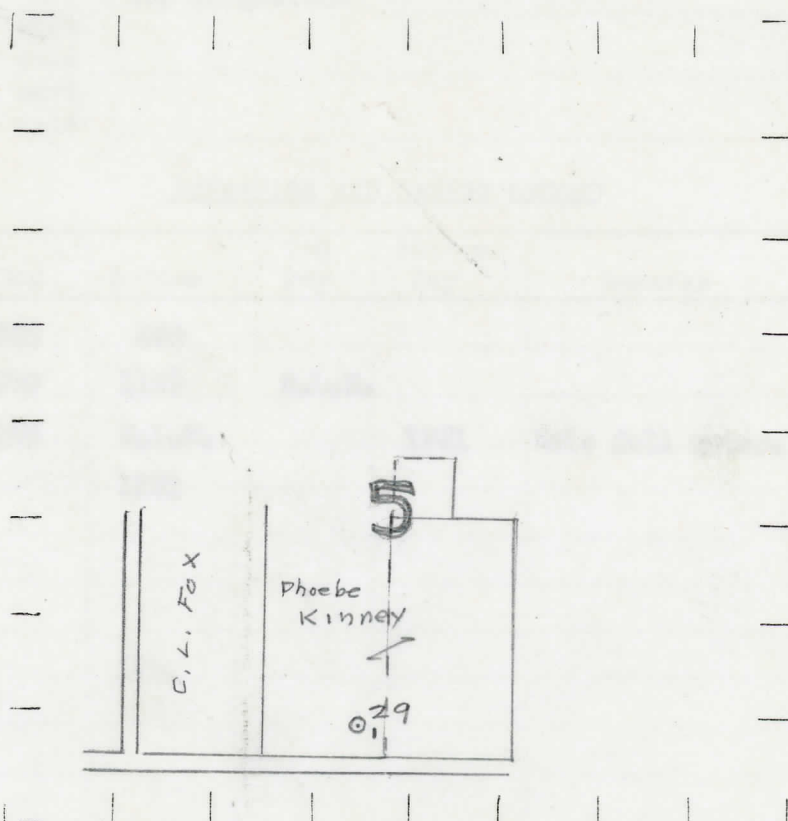

REMARKS:

SIGNED

Superintendent or Foreman.

COMPLETION RECORD OF WELLS DRILLED BY OTHER OPERATORS

Michigan Producing Division

Date April 24, 1940 No. 29
 State Mich. County Kalamazoo Dist. Prairie Ronde
 (Serial No.) Twp. 4 S Rge. 12 W
 Well No. 1 (County No.) 29 Farm Phoebe Kinney Acres _____
 Operator R. D. Malcolm, Trustee Information secured ~~from~~ Scouting Department
 Date well started 3-5-40 Dated well completed 4-17-40 Elevation 932.3

PRODUCTION RECORD

1st 24 hours natural Dry Hole
 2nd 24 hours natural _____
 Date of shot _____ No. of quarts _____
 Date of acid _____ No. of gallons _____
 1st 24 hours after acid shot _____
 2nd 24 hours after acid shot _____

FORMATION AND CASING RECORD

Formation	Top	Bottom	Top Pay	Bottom Pay	Remarks	Casing	
						Size	Set at
Red Rock	643	650				8-5/8"	326
Antrim	1070	1192	S.L.M.				
Traverse Line	1258	S.L.M.		1281	Hole full water.		
Total Depth		1281					

Remarks 1204' C.T.M. equals 1211' S.L.M.

Signed D. C. Shackelford