



Western Michigan University
ScholarWorks at WMU

Legacy Scout Tickets from Pure Oil Company

8-20-2021

**MGRRE_PureOilScoutTickets_Drobney,
Adam_1_21077103300000**

MGRRE
Western Michigan University

Follow this and additional works at: <https://scholarworks.wmich.edu/pure>



Part of the Geology Commons

WMU ScholarWorks Citation

MGRRE, "MGRRE_PureOilScoutTickets_Drobney, Adam_1_21077103300000" (2021). *Legacy Scout Tickets from Pure Oil Company*. 3867.
<https://scholarworks.wmich.edu/pure/3867>

This Document is brought to you for free and open access via ScholarWorks at WMU. It has been accepted for inclusion in Legacy Scout Tickets from Pure Oil Company by an authorized administrator of ScholarWorks at WMU. See the National Digital Catalogue - Science Base Catalogue for more collections submitted by MGRRE.



MGRRE_PureOilScoutTickets_Drobney, Adam_1_21077103300000

API 21077103300000

Permit Number 10330

Lease Name Drobney, Adam

Well Number 1

County Kalamazoo

Township 01S

Range 12W

Section 31

2021 DEQ or Pure co_name Harris Oil Company

Pure Number 38

Latitude 42.33264

Longitude -85.76426

THE PURE OIL COMPANY LOCATION REPORT

Date February 9, 1944 A.F.E. No. _____
 Division Mich. Producing District _____ Lease Adam Drobney
 Acres _____ Lease No. _____ Elevation _____ Well No. 1 (Serial No. 38)
 Quadrangle SW-SW-SW Sec. 31 Twp. 1 S Rge. 12 W Twp. Alamo
 Survey _____ County Kalamazoo State Michigan
 Operator Harris Oil Co Map Alamo Twp - Kalamazoo Co
Harris Oil Company

330 330 Feet from North Line of Lease
 " " East " " "
330 330 " " South " " "
330 330 " " West " " "
 Feet from North Line of Section
 " " East " " "
330 330 " " South 1/4 "
330 330 " " West " " "

LEGEND

- Location
- ☀ Gas Well
- Oil Well
- ☀ Gas - Distillate Well
- or ○ Dry Hole
- Dry Showing Oil
- ☀ Dry Showing Gas
- ⊗ Abandoned Location
- ☀ or ☀ Abandoned Gas Well
- or ● Abandoned Oil Well
- or ○ Input Well

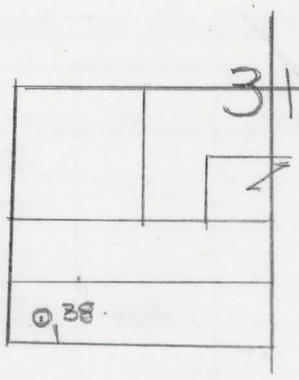

Remarks: Transfer of Permit from Van Buren Co # 910
Transfer of Permit from Van Buren County No. 910.

Submitted by RN Civil Engineer Approved by _____ Division Manager
 Approved by _____ Vice-President - General Manager

Michigan Producing Division

Date April 5, 1944 No. 38
 State Mich. County Kalamazoo District Alamo Twp. 31 Sec. 31 Twp. 1 S Rge. 12 W
 Well No. 1 (Serial No.) 38 Farm Adam Drobney Acres _____
 Operator Harris Oil Company Information secured from Scouting Department By _____
 Date well started 2-3-44 Date well completed 2-17-44 Elevation 734.5

PRODUCTION BOARD

1st 24 hours natural Dry Hole
 2nd 24 hours natural _____
 Date of shot _____ No. of quarts _____ From _____ to _____ From _____ to _____
 Date of acid _____ No. of gallons _____
 1st 24 hours after acid shot _____
 2nd 24 hours after acid shot _____

FORMATION AND CASING RECORD

Formation	Top	Bottom	Top Pay	Bottom Pay	Remarks	Casing	
						Size	Set at
<u>Coldwater Lime</u>	<u>330</u>	<u>401</u>				<u>8-5/8"</u>	<u>192</u>
<u>Red Rock</u>	<u>630</u>	<u>632</u>					
<u>" "</u>	<u>648</u>	<u>653</u>					
<u>" "</u>	<u>662</u>	<u>674</u>	<u>SLM.</u>				
<u>Antrim (light)</u>	<u>974</u>						
<u>Antrim (dark)</u>	<u>1080</u>						
<u>Traverse Form.</u>	<u>1205</u>						
<u>Traverse Lime</u>	<u>1272</u>	<u>SLM.</u>	<u>1274 1/2</u>	<u>1275 ?</u>	<u>- show gas - 40 ft. oil in hole -</u>		
<u>Total Depth</u>		<u>1275</u>			<u>700 ft. water in 20 minutes.</u>		

Remarks 1273' CTM equals 1272' SLM.

Signed D. C. Shackelford