



Western Michigan University  
ScholarWorks at WMU

---

Legacy Scout Tickets from Pure Oil Company

---

8-20-2021

## MGRRE\_PureOilScoutTickets\_Grayling Development Test Well\_3\_21079002230000

MGRRE

*Western Michigan University*

Follow this and additional works at: <https://scholarworks.wmich.edu/pure>



Part of the Geology Commons

---

### WMU ScholarWorks Citation

MGRRE, "MGRRE\_PureOilScoutTickets\_Grayling Development Test Well\_3\_21079002230000" (2021).  
*Legacy Scout Tickets from Pure Oil Company*. 3883.  
<https://scholarworks.wmich.edu/pure/3883>

This Document is brought to you for free and open access via ScholarWorks at WMU. It has been accepted for inclusion in Legacy Scout Tickets from Pure Oil Company by an authorized administrator of ScholarWorks at WMU. See the National Digital Catalogue - Science Base Catalogue for more collections submitted by MGRRE.



---

**MGRRE\_PureOilScoutTickets\_Grayling Development Test  
Well\_3\_21079002230000**

API 21079002230000

Permit Number 223

Lease Name Grayling Development Test Well

Well Number 3

County Kankaska

Township 26N

Range 05W

Section 17

2021 DEQ or Pure co\_name Grayling Development Company

Pure Number 1

Latitude 44.64647

Longitude -84.93906

DATE 4-19-29

LOCATION REPORT

No. 1

STATE Michigan COUNTY Kalkaska DIST. Clearwater SEC. 17 TOWN 26N RANGE 5W  
TWP. Clearwater PREC. State Land

WELL No. 1 (SERIAL No. 1) FARM State Land ACRES

NAME OF STREAM OR WATERS QUADRANGLE NN 1/4 SE 1/4

OPERATOR Grayling Development Co MAP Clearwater Twp. - 2000' Tol'

Feet from North Line of Farm

1980' " " East " " "  
1980' " " South " " "  
" " West " " "

Feet from North Line of Section

1980' " " East " " "  
1980' " " South " " "  
" " West " " "

LEGEND

- LOCATION
- ⊕ RIG
- ⊕ DRILLING
- ⊗ GAS WELL
- OIL WELL
- SMALL OIL WELL
- ⊗ DRY HOLE
- ⊕ DRY SHOWING OIL
- ⊗ DRY SHOWING GAS
- ⊗ ABANDONED LOCATION
- ⊗ ABANDONED GAS WELL
- ABANDONED OIL WELL

NOTE: Below make tracing from map, (when no map is obtainable make sketch) showing farm, center of section, this location with measurements and also wells, dry holes, or other locations in the vicinity of this location. Make copy to keep for reference and send original to Columbus office.

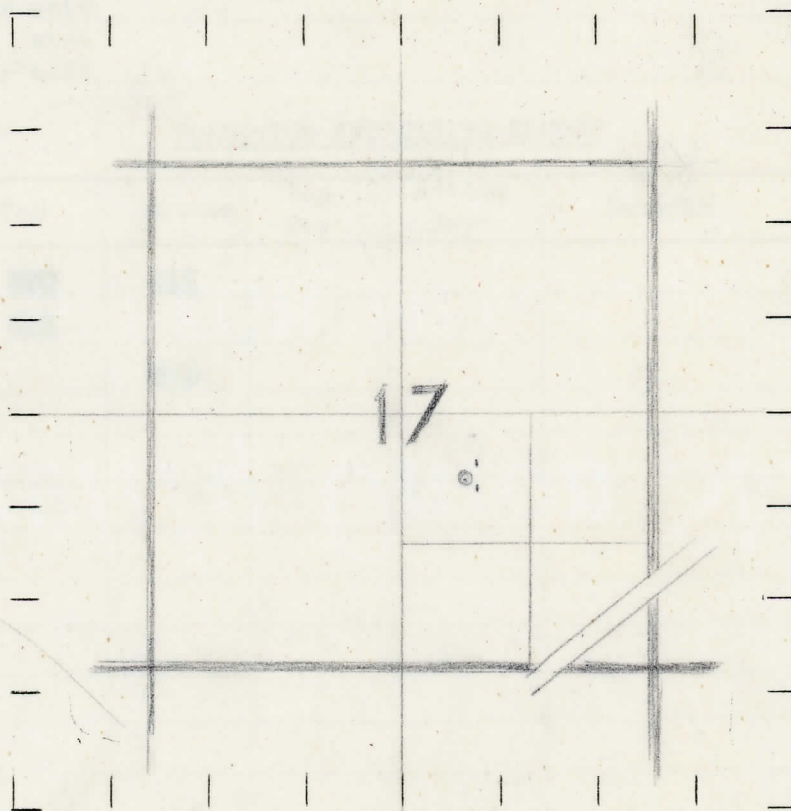

REMARKS:

.....  
.....  
.....

SIGNED

Superintendent or Foreman.

Michigan Producing Division

Date July 15, 1938 No. 1  
 State Michigan County Kalkaska Twp. Clearwater Sec. 17 Twp. 26 N Rge. 5 W  
 (Serial No.)  
 Well No. 1 (~~County No.~~) 1 Farm State of Michigan Acres \_\_\_\_\_  
 Operator Grayling Development Co. Information secured ~~from~~ Scouting Department By \_\_\_\_\_  
 Date well started 1928 Date well completed 1929 Elevation 1106.3

PRODUCTION RECORD

1st 24 hours natural Dry Hole  
 2nd 24 hours natural \_\_\_\_\_  
 Date of shot \_\_\_\_\_ No. of quarts \_\_\_\_\_ From \_\_\_\_\_ to \_\_\_\_\_ From \_\_\_\_\_ to \_\_\_\_\_  
 Date of acid \_\_\_\_\_ No. of gallons \_\_\_\_\_  
 shot  
 1st 24 hours after acid \_\_\_\_\_  
 shot  
 2nd 24 hours after acid \_\_\_\_\_

FORMATION AND CASING RECORD

Formation	Top	Bottom	Top Pay	Bottom Pay	Remarks	Casing	
						Size	Set at
Marshall	330	411					
Coldwater	411						
Total Depth		673					

Remarks \_\_\_\_\_

\_\_\_\_\_

\_\_\_\_\_

\_\_\_\_\_

Signed D. C. Shackelford