



Western Michigan University  
ScholarWorks at WMU

---

Legacy Scout Tickets from Pure Oil Company

---

8-20-2021

**MGRRE\_PureOilScoutTickets\_Fletcher, H. B.\_1\_21081036010000**

MGRRE

*Western Michigan University*

Follow this and additional works at: <https://scholarworks.wmich.edu/pure>



Part of the Geology Commons

---

#### **WMU ScholarWorks Citation**

MGRRE, "MGRRE\_PureOilScoutTickets\_Fletcher, H. B.\_1\_21081036010000" (2021). *Legacy Scout Tickets from Pure Oil Company*. 3912.

<https://scholarworks.wmich.edu/pure/3912>

This Document is brought to you for free and open access via ScholarWorks at WMU. It has been accepted for inclusion in Legacy Scout Tickets from Pure Oil Company by an authorized administrator of ScholarWorks at WMU. See the National Digital Catalogue - Science Base Catalogue for more collections submitted by MGRRE.



---

**MGRRE\_PureOilScoutTickets\_Fletcher, H. B.\_1\_21081036010000**

API 21081036010000

Permit Number 3601

Lease Name Fletcher, H. B.

Well Number 1

County Kent

Township 07N

Range 10W

Section 25

2021 DEQ or Pure co\_name Central Michigan Petroleum Corporation

Pure Number 34

Latitude 42.95846

Longitude -85.45072

DATE October 15, 1936

LOCATION REPORT

No. 34

STATE Michigan COUNTY Kent DIST. Ada TWP. Ada SEC. 25 TOWN 7 N RANGE 10 W

WELL No. 1 (SERIAL No. 34) FARM H. B. Fletcher ACRES

NAME OF STREAM OR WATERS \_\_\_\_\_ QUADRANGLE SW-SW-SW

OPERATOR Central Michigan Petroleum Corp. Map Ada Township, Kent County  
Central Mich. Petroleum Corp. Ada Twp - Kent Co.

\_\_\_\_\_ Feet from North Line of Farm

\_\_\_\_\_ " " East " " "

300 300 " " South " " "

300 300 " " West " " "

\_\_\_\_\_ Feet from North Line of Section

\_\_\_\_\_ " " East " " "

300 300 " " South " " "

300 300 " " West " " "

LEGEND

- LOCATION
- ⊕ RIG
- ⊕ DRILLING
- ☀ GAS WELL
- OIL WELL
- SMALL OIL WELL
- ⊙ DRY HOLE
- ◆ DRY SHOWING OIL
- ⊙ DRY SHOWING GAS
- ⊙ ABANDONED LOCATION
- ☀ ABANDONED GAS WELL
- ABANDONED OIL WELL

NOTE: Below make tracing from map, (when no map is obtainable make sketch) showing farm, center of section, this location with measurements and also wells, dry holes, or other locations in the vicinity of this location.

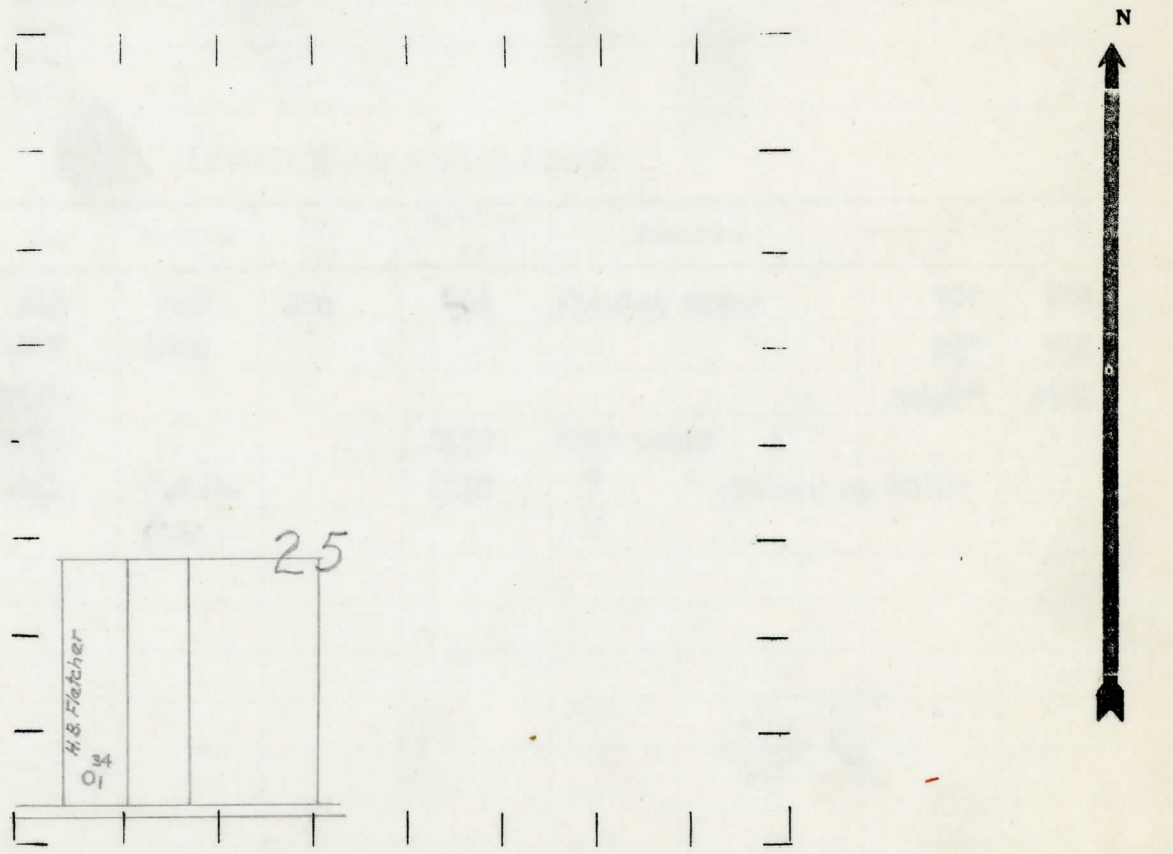

REMARKS: \_\_\_\_\_

SIGNED R. d. Young  
Superintendent or Foreman.



COMPLETION RECORD OF WELLS OBTAINED BY OTHER OPERATORS

Michigan Producing Division

Date June 17, 1937 No. 34  
 State Michigan County Kent Dist. Ada Sec. 25 Twp. 7 N Rge. 10 W  
 Well No. 1 (Serial No.) (County No.) 34 Farm H. B. Fletcher Acres \_\_\_\_\_  
 Operator Central Michigan Petroleum Corp. Information secured from Scoutng Department by \_\_\_\_\_  
 Date well started 4-4-37 Date well completed 6-7-37 Elevation 737.9

PRODUCTION RECORD

1st 24 hours natural Dry Hole  
 2nd 24 hours natural \_\_\_\_\_  
 Date of shot \_\_\_\_\_ No. of quarts \_\_\_\_\_ From \_\_\_\_\_ to \_\_\_\_\_ From \_\_\_\_\_ to \_\_\_\_\_  
 Date of acid \_\_\_\_\_ No. of gallons \_\_\_\_\_  
 1st 24 hours after acid shot \_\_\_\_\_  
 2nd 24 hours after acid shot \_\_\_\_\_

FORMATION AND CASING RECORD

Formation	Top	Bottom	Top Pay	Bottom Pay	Remarks	Casing	
						Size	Set At
Marshall	405	530	198	204	Flowing water	10"	206
Red Rock	1507	1520				8 1/2"	710
Antrim	1868					6-5/8"	2441
Traverse	2072			2130	Salt water		
Dundee	2450	C.T.M.		2510	" " -filled up 1600'		
Total Depth		2541					

Remarks \_\_\_\_\_  
 \_\_\_\_\_  
 \_\_\_\_\_

Signed D. C. Shackelford