



Western Michigan University  
ScholarWorks at WMU

---

Legacy Scout Tickets from Pure Oil Company

---

8-20-2021

**MGRRE\_PureOilScoutTickets\_Friedli, Godfrey\_1\_21081039610000**

MGRRE

*Western Michigan University*

Follow this and additional works at: <https://scholarworks.wmich.edu/pure>



Part of the Geology Commons

---

#### **WMU ScholarWorks Citation**

MGRRE, "MGRRE\_PureOilScoutTickets\_Friedli, Godfrey\_1\_21081039610000" (2021). *Legacy Scout Tickets from Pure Oil Company*. 3913.

<https://scholarworks.wmich.edu/pure/3913>

This Document is brought to you for free and open access via ScholarWorks at WMU. It has been accepted for inclusion in Legacy Scout Tickets from Pure Oil Company by an authorized administrator of ScholarWorks at WMU. See the National Digital Catalogue - Science Base Catalogue for more collections submitted by MGRRE.



---

**MGRRE\_PureOilScoutTickets\_Friedli, Godfrey\_1\_21081039610000**

API 21081039610000

Permit Number 3961

Lease Name Friedli, Godfrey

Well Number 1

County Kent

Township 07N

Range 09W

Section 26

2021 DEQ or Pure co\_name Flanigan, James E.

Pure Number 35

Latitude 42.95898

Longitude -85.33274

The Pure Oil Company  
THE PURE OIL COMPANY  
COMPLETION RECORD OF WELLS DRILLED BY OTHER OPERATORS

DATE March 25, 1937

LOCATION REPORT

No. 35

STATE Michigan COUNTY Kent DIST. Vergennes TWP. Vergennes SEC. 26 TOWN 7 N RANGE 9 W

WELL No. 1 (SERIAL No. 35) FARM Godfrey Friedli ACRES

NAME OF STREAM OR WATERS \_\_\_\_\_ QUADRANGLE SE-SE-SE

OPERATOR James E. Flanigan Map Vergennes Township, Kent County

470470 Feet from North Line of Farm

“ “ East “ “ “

“ “ South “ “ “

420420 “ “ West “ “ “

Feet from North Line of Section

29840 “ “ East “ “ “

190 190 “ “ South “ “ “

“ “ West “ “ “

*lp 175 = 10" 140  
3-19-37*

LEGEND

- LOCATION
- ⊕ RIG
- ⊕ DRILLING
- ☀ GAS WELL
- OIL WELL
- ⬮ SMALL OIL WELL
- ⊖ DRY HOLE
- ⬮ DRY SHOWING OIL
- ⊖ DRY SHOWING GAS
- ⊖ ABANDONED LOCATION
- ☀ ABANDONED GAS WELL
- ⬮ ABANDONED OIL WELL

NOTE: Below make tracing from map, (when no map is obtainable make sketch) showing farm, center of section, this location with measurements and also wells, dry holes, or other locations in the vicinity of this location.

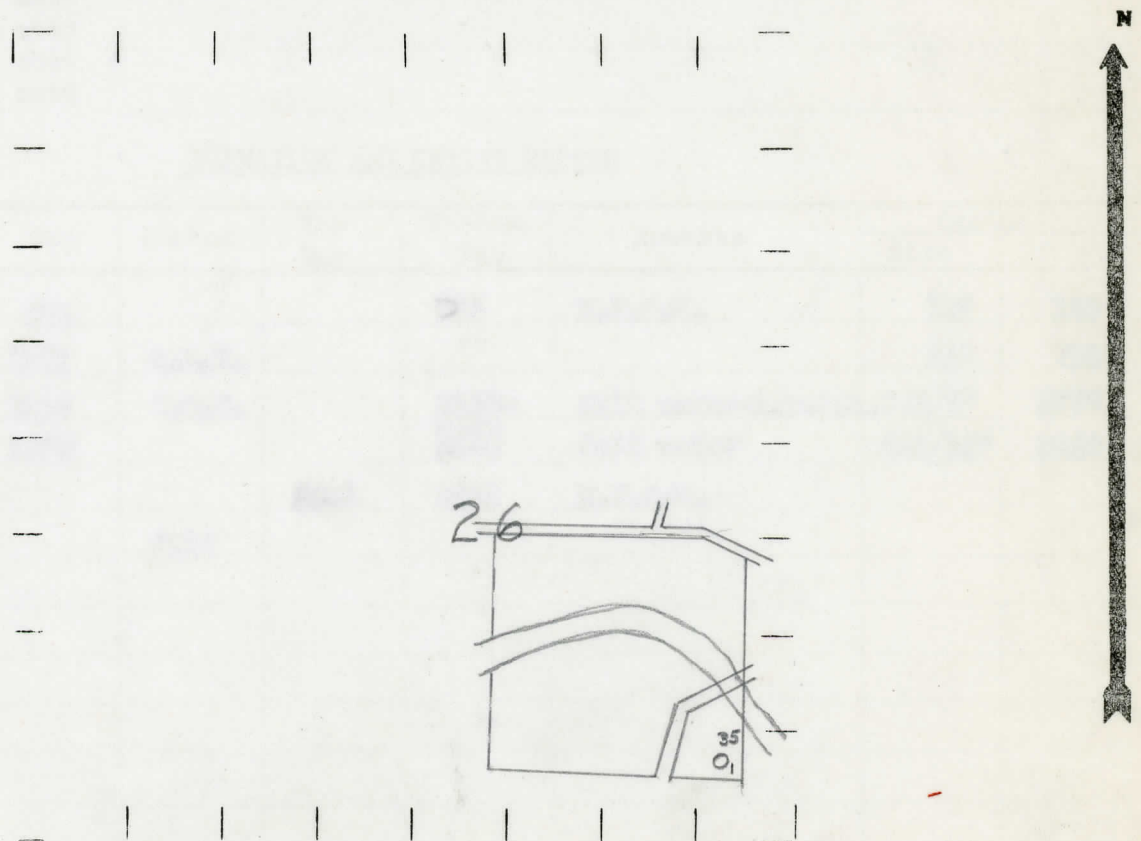

REMARKS:

SIGNED

*R. L. Young*

Superintendent or Foreman.

Michigan Producing Division

Date May 13, 1937 No. 35  
 State Michigan County Kent Dist. Vergennes  
 (Serial No.) Twp. 26 Sec. 9 N Rge. 7 W  
 Well No. 1 (County No.) 35 Farm Godfrey Friedli Acres \_\_\_\_\_  
 Operator James E. Flanigan by \_\_\_\_\_  
 Information secured from Scouting Department  
 Date well started 3-19-37 Date well completed 5-10-37 Elevation 656.1

PRODUCTION RECORD

1st 24 hours natural Dry Hole  
 2nd 24 hours natural \_\_\_\_\_  
 Date of shot \_\_\_\_\_ No. of quarts \_\_\_\_\_ From \_\_\_\_\_ to \_\_\_\_\_  
 Date of acid \_\_\_\_\_ No. of gallons \_\_\_\_\_  
 1st 24 hours after acid shot \_\_\_\_\_  
 2nd 24 hours after acid shot \_\_\_\_\_

FORMATION AND CASING RECORD

Formation	Top	Bottom	Top Pay	Bottom Pay	Remarks	Casing	
						Size	Set At
Marshall	400			525	H.F.S.W.	10"	140
Red Rock	1581	S.L.M.				8 1/2"	713
Traverse	2136	C.T.M.		2186-	Salt water-H.F.S.W.	6-5/8"	2378
Dundee	2456			2190 2490	Salt water	5-3/16"	2448
			2504	2512	H.F.S.W.		
<b>Total Depth</b>		<b>2523</b>					

Remarks \_\_\_\_\_

Signed Dean C. Shackelford