



Western Michigan University
ScholarWorks at WMU

Legacy Scout Tickets from Pure Oil Company

8-20-2021

MGRRE_PureOilScoutTickets_?_1_unk

MGRRE

Western Michigan University

Follow this and additional works at: <https://scholarworks.wmich.edu/pure>



Part of the Geology Commons

WMU ScholarWorks Citation

MGRRE, "MGRRE_PureOilScoutTickets_?_1_unk" (2021). *Legacy Scout Tickets from Pure Oil Company*. 3916.

<https://scholarworks.wmich.edu/pure/3916>

This Document is brought to you for free and open access via ScholarWorks at WMU. It has been accepted for inclusion in Legacy Scout Tickets from Pure Oil Company by an authorized administrator of ScholarWorks at WMU. See the National Digital Catalogue - Science Base Catalogue for more collections submitted by MGRRE.



MGRRE_PureOilScoutTickets_?_1_unk

API unk

Permit Number unk

Lease Name ?

Well Number 1

County Kent

Township 07N

Range 12W

Section 6

2021 DEQ or Pure co_name Shell Pet Co

Pure Number 38

Latitude 43.0234108

Longitude -85.7781199

THE PURE OIL COMPANY

LOCATION REPORT

DATE April 7, 1938

No. 38

STATE Michigan

COUNTY Kent

Kent.

DIST. Walker
TWP. Walker
PRBC. ??

Walker

SEC. 6

TOWN 6 N

6 N

RANGE 12 W

12 W

WELL No. 1 (SERIAL No. 38) FARM

ACRES

NAME OF STREAM OR WATERS

QUADRANGLE SW-SE-SW

OPERATOR Shell Petroleum Corporation

Map Walker Township, Kent County

Shell Pet. Corp.

Walker-Kent Co.

Feet from North Line of Farm

“ “ East “ “ “

“ “ South “ “ “

“ “ West “ “ “

Feet from North Line of Section

“ “ East “ “ “

“ “ South “ “ “

“ “ West “ “ “

50 50

15841584

LEGEND

○ LOCATION

⊕ RIG

⊕ DRILLING

☀ GAS WELL

● OIL WELL

● SMALL OIL WELL

⊙ DRY HOLE

● DRY SHOWING OIL

⊙ DRY SHOWING GAS

⊙ ABANDONED LOCATION

☀ ABANDONED GAS WELL

● ABANDONED OIL WELL

NOTE: Below make tracing from map, (when no map is obtainable make sketch) showing farm, center of section, this location with measurements and also wells, dry holes, or other locations in the vicinity of this location.

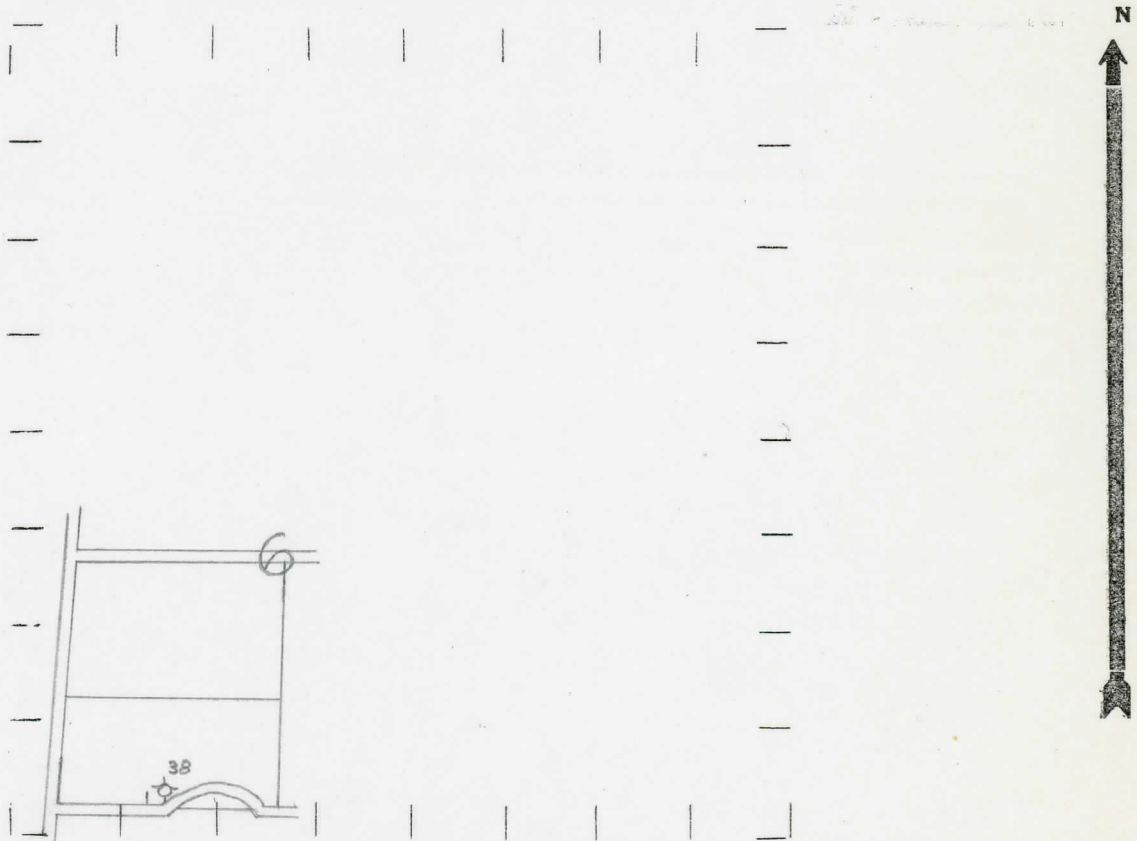

REMARKS: Core Test.

SIGNED

R. L. Yegor
Superintendent or Foreman.