



Western Michigan University
ScholarWorks at WMU

Legacy Scout Tickets from Pure Oil Company

8-20-2021

MGRRE_PureOilScoutTickets_Gavin_2_21081060180000

MGRRE

Western Michigan University

Follow this and additional works at: <https://scholarworks.wmich.edu/pure>



Part of the Geology Commons

WMU ScholarWorks Citation

MGRRE, "MGRRE_PureOilScoutTickets_Gavin_2_21081060180000" (2021). *Legacy Scout Tickets from Pure Oil Company*. 3940.

<https://scholarworks.wmich.edu/pure/3940>

This Document is brought to you for free and open access via ScholarWorks at WMU. It has been accepted for inclusion in Legacy Scout Tickets from Pure Oil Company by an authorized administrator of ScholarWorks at WMU. See the National Digital Catalogue - Science Base Catalogue for more collections submitted by MGRRE.



MGRRE_PureOilScoutTickets_Gavin_2_21081060180000

API 21081060180000

Permit Number 6018

Lease Name Gavin

Well Number 2

County Kent

Township 06N

Range 12W

Section 5

2021 DEQ or Pure co_name Gordon Oil Company

Pure Number 62

Latitude 42.94017

Longitude -85.76167

DATE April 13, 1939

LOCATION REPORT

No. 62

STATE Michigan COUNTY Kent DIST. Walker TWP. Walker SEC. 5 TOWN 6 N RANGE 12 W

WELL No. 22 (SERIAL No. 62) FARM Gavin ACRES

NAME OF STREAM OR WATERS QUADRANGLE SE-NW-NW
SE NW NW

OPERATOR Gordon Oil Company Map Walker Township, Kent County

Gordon Oil Co.
Feet from North Line of Farm

365 365 " " East " " "

372 372 " " South " " "

" " West " " "

105 1057 Feet from North Line of Section

" " East " " "

" " South " " "

111 1118 " " West " " "

119 Sp 4-6 -31

LEGEND

- LOCATION
- ⊕ DRILLING
- ☀ GAS WELL
- OIL WELL
- ⊕ SMALL OIL WELL
- ⊖ DRY HOLE
- ⊕ DRY SHOWING OIL
- ⊖ DRY SHOWING GAS
- ⊖ ABANDONED LOCATION
- ☀ ABANDONED GAS WELL
- ⊖ ABANDONED OIL WELL

NOTE: Below make tracing from map, (when no map is obtainable make sketch) showing farm, center of section, this location with measurements and also wells, dry holes, or other locations in the vicinity of this location.

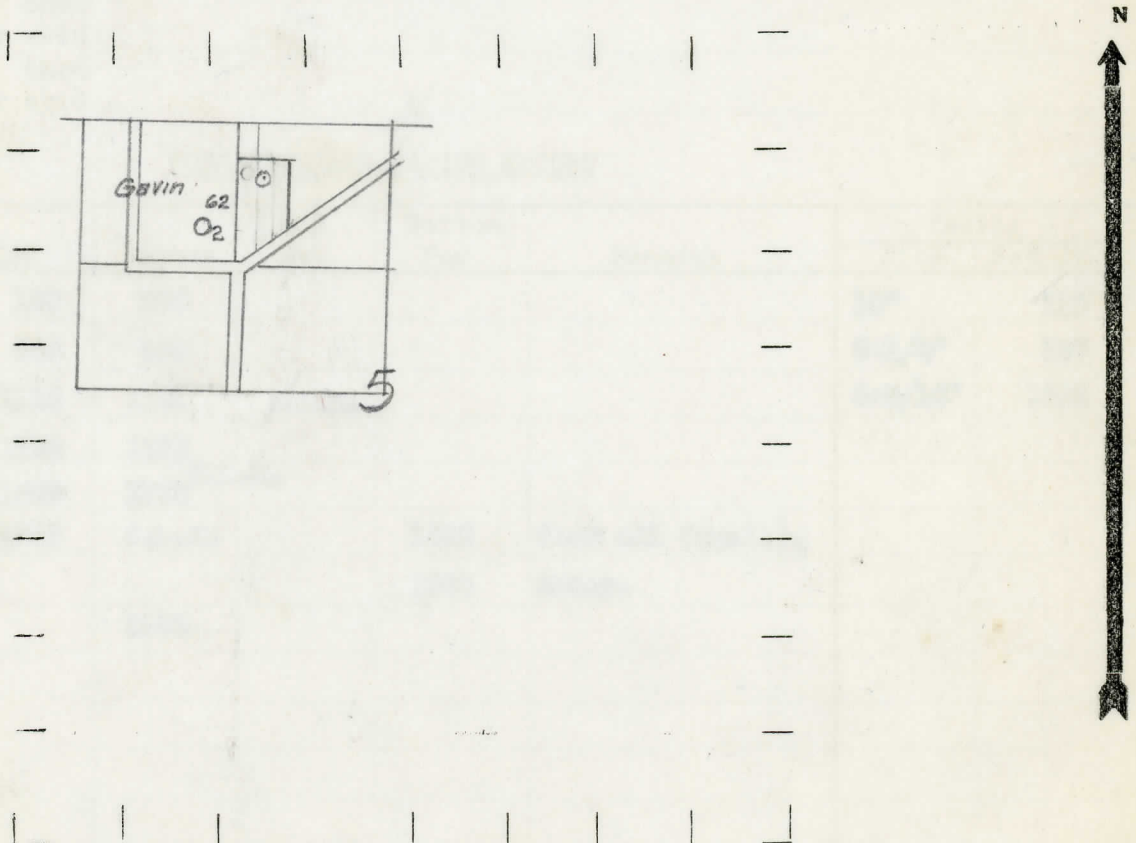

REMARKS:

SIGNED

R. J. G.

Superintendent or Foreman

COMPLETION RECORD OF WELLS DRILLED BY OTHER OPERATORS

Michigan Producing Division

Date May 4, 1939 No. 62
 State Mich. County Kent Dist. Walker Twp. Walker Sec. 5 Twp. 6 N Rge. 12 W
 Well No. 2 (Serial No.) 62 Farm Garvin Acres _____
 Operator Gordon Oil Company Information secured By Scouting Department
 Date well started 4-6-39 Dated well completed 4-26-39 Elevation 664.7

PRODUCTION RECORD

1st 24 hours natural Dry Hole
 2nd 24 hours natural _____
 Date of shot _____ No. of quarts _____ From _____ to _____ From _____ to _____
 Date of acid _____ No. of gallons _____
 1st 24 hours after acid shot _____
 2nd 24 hours after acid shot _____

FORMATION AND CASING RECORD

Formation	Top	Bottom	Top Pay	Bottom Pay	Remarks	Casing	
						Size	Set at
Marshall	120	385				10"	119
Coldwater Line	665	680				8-1/4"	597
Red Rock	1114	1121	S.L.M.			5-5/16"	1825
Berea	1154	1175	S.L.M.				
Antrim	1645	1775	S.L.M.				
Traverse Line	1825	S.L.M.		1830	Show oil (small).		
				1890	Water.		
Total Depth		1938					

Remarks 1125' C.T.M. equals 1120' S.L.M.

Signed D. C. Shackelford