



Western Michigan University
ScholarWorks at WMU

Legacy Scout Tickets from Pure Oil Company

8-20-2021

MGRRE_PureOilScoutTickets_Conrad, Bssie M._1_na

MGRRE

Western Michigan University

Follow this and additional works at: <https://scholarworks.wmich.edu/pure>



Part of the Geology Commons

WMU ScholarWorks Citation

MGRRE, "MGRRE_PureOilScoutTickets_Conrad, Bssie M._1_na" (2021). *Legacy Scout Tickets from Pure Oil Company*. 3952.

<https://scholarworks.wmich.edu/pure/3952>

This Document is brought to you for free and open access via ScholarWorks at WMU. It has been accepted for inclusion in Legacy Scout Tickets from Pure Oil Company by an authorized administrator of ScholarWorks at WMU. See the National Digital Catalogue - Science Base Catalogue for more collections submitted by MGRRE.



MGRRE_PureOilScoutTickets_Conrad, Bssie M._1_na

API na

Permit Number na

Lease Name Conrad, Bssie M.

Well Number 1

County Kent

Township 07N

Range 12W

Section 33

2021 DEQ or Pure co_name Strom, E. B.

Pure Number 74

Latitude 42.9498868

Longitude -85.7364961

THE PURE OIL COMPANY

COMPLETION RECORD OF WELLS DRILLED BY OTHER OPERATORS

DATE May 4, 1939

LOCATION REPORT

No. 74

STATE Michigan

COUNTY Kent

DIST. Walker

SEC. 33

TOWN 7 N

7 N

RANGE 12 W

WELL No. 1 (SERIAL No. 74) FARM

PREC. Bessie M. Conrad

ACRES

NAME OF STREAM OR WATERS

QUADRANGLE

SE-NE-SW
SE NE SW

OPERATOR E. B. Strom

Map Walker Township, Kent County

E. B. Strom

Walker - Kent

Feet from North Line of Farm

41.2 41.2

" " East " " "

26 264

" " South " " "

41.2 41.2

" " West " " "

Feet from North Line of Section

41.25 41.25

" " East " 1/4 "

148 1482

" " South " " "

" " West " " "

Loc

LEGEND

○ LOCATION

⊙ DRY HOLE

⊕ RIG

⊙ DRY SHOWING OIL

⊕ DRILLING

⊙ DRY SHOWING GAS

☀ GAS WELL

⊙ ABANDONED LOCATION

● OIL WELL

☀ ABANDONED GAS WELL

⊕ SMALL OIL WELL

⊙ ABANDONED OIL WELL

NOTE: Below make tracing from map, (when no map is obtainable make sketch) showing farm, center of section, this location with measurements and also wells, dry holes, or other locations in the vicinity of this location.

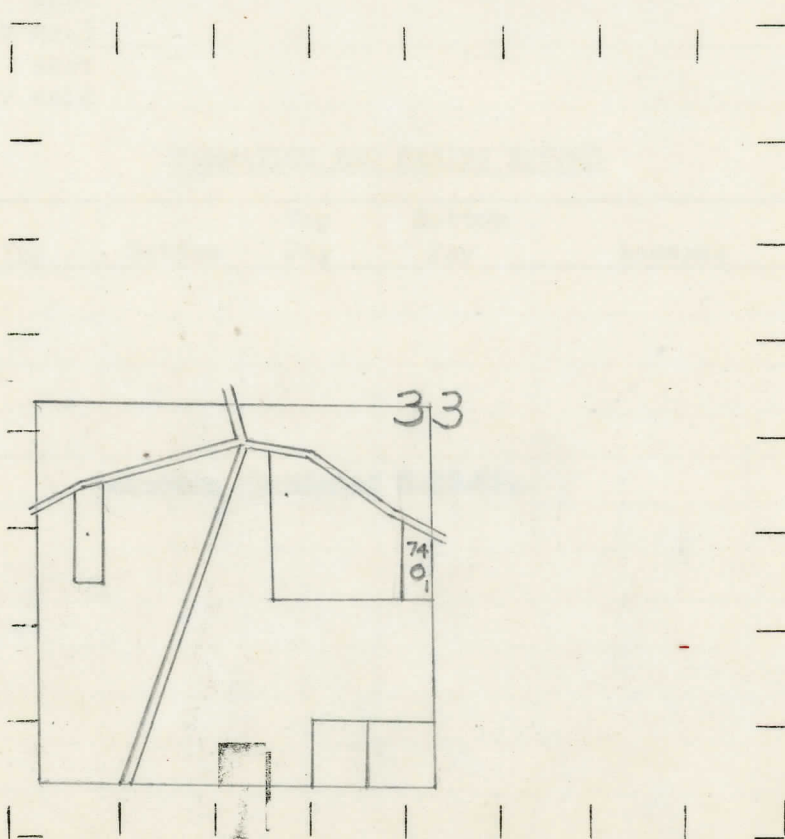

REMARKS:

SIGNED

R. A. J.

Superintendent or Foreman.

COMPLETION RECORD OF WELLS DRILLED BY OTHER OPERATORS

Michigan Producing Division

Date June 29, 1939 No. 74
State Mich. County Kent Twp. Walker Sec. 33 Twp. 7 N Rge. 12 W
Well No. 1 (Serial No.) (County No.) 74 Farm Bessie M. Conrad Acres
Operator Edward B. Strom Information secured from Scouting Department
Date well started Not started. Dated well completed Not completed. Elevation

PRODUCTION RECORD

1st 24 hours natural Location abandoned.
2nd 24 hours natural
Date of shot No. of quarts From to From to
Date of acid No. of gallons
shot
1st 24 hours after acid
shot
2nd 24 hours after acid

FORMATION AND CASING RECORD

Table with 7 columns: Formation, Top, Bottom, Top Pay, Bottom Pay, Remarks, Casing (Size, Set at). Includes text 'Location abandoned 6-27-39.' in the Remarks column.

Remarks

Signed D. C. Shackelford