



Western Michigan University  
ScholarWorks at WMU

---

Legacy Scout Tickets from Pure Oil Company

---

8-20-2021

**MGRRE\_PureOilScoutTickets\_GRUENBAUER, HOWARD  
\_1\_21081044820000**

MGRRE  
*Western Michigan University*

Follow this and additional works at: <https://scholarworks.wmich.edu/pure>



Part of the Geology Commons

---

#### **WMU ScholarWorks Citation**

MGRRE, "MGRRE\_PureOilScoutTickets\_GRUENBAUER, HOWARD \_1\_21081044820000" (2021). *Legacy Scout Tickets from Pure Oil Company*. 3956.  
<https://scholarworks.wmich.edu/pure/3956>

This Document is brought to you for free and open access via ScholarWorks at WMU. It has been accepted for inclusion in Legacy Scout Tickets from Pure Oil Company by an authorized administrator of ScholarWorks at WMU. See the National Digital Catalogue - Science Base Catalogue for more collections submitted by MGRRE.



---

**MGRRE\_PureOilScoutTickets\_GRUENBAUER, HOWARD \_1\_21081044820000**

API 21081044820000

Permit Number 4482

Lease Name GRUENBAUER, HOWARD

Well Number 1

County Kent

Township 07N

Range 12W

Section 33

2021 DEQ or Pure co\_name Mt. Pleasant Drill & Prod

Pure Number 78

Latitude 42.94755

Longitude -85.74516

THE PURE OIL COMPANY

COMPLETION RECORD OF WELLS DRILLED BY OTHER OPERATORS

DATE May 4, 1939

LOCATION REPORT

No. 78

STATE Michigan

COUNTY Kent

TWP. Walker

SEC. 33

TOWN 7 N

RANGE 12 W

WELL No. 1 (SERIAL No. 78) FARM

OWNER Gruebauer

ACRES

NAME OF STREAM OR WATERS

QUADRANGLE

SW-NW-SW  
SW NW SW

OPERATOR Mt. Pleasant Drilling & Producing Co.

Map

Walker Township, Kent County

33830

Mt Pleasant Drilg. & Prod. Co.

Walker - Kent

Feet from North Line of Farm

68 68

" " East " " "

Low

LEGEND

○ LOCATION

⊙ DRY HOLE

⊕ RIG

⊙ DRY SHOWING OIL

⊕ DRILLING

⊙ DRY SHOWING GAS

⊙ GAS WELL

⊙ ABANDONED LOCATION

⊙ OIL WELL

⊙ ABANDONED GAS WELL

⊙ SMALL OIL WELL

⊙ ABANDONED OIL WELL

915 915

Feet from North Line of Section

" " East " " "

" " South " " "

" " West " " "

327327

" " West " " "

NOTE: Below make tracing from map, (when no map is obtainable make sketch) showing farm, center of section, this location with measurements and also wells, dry holes, or other locations in the vicinity of this location.

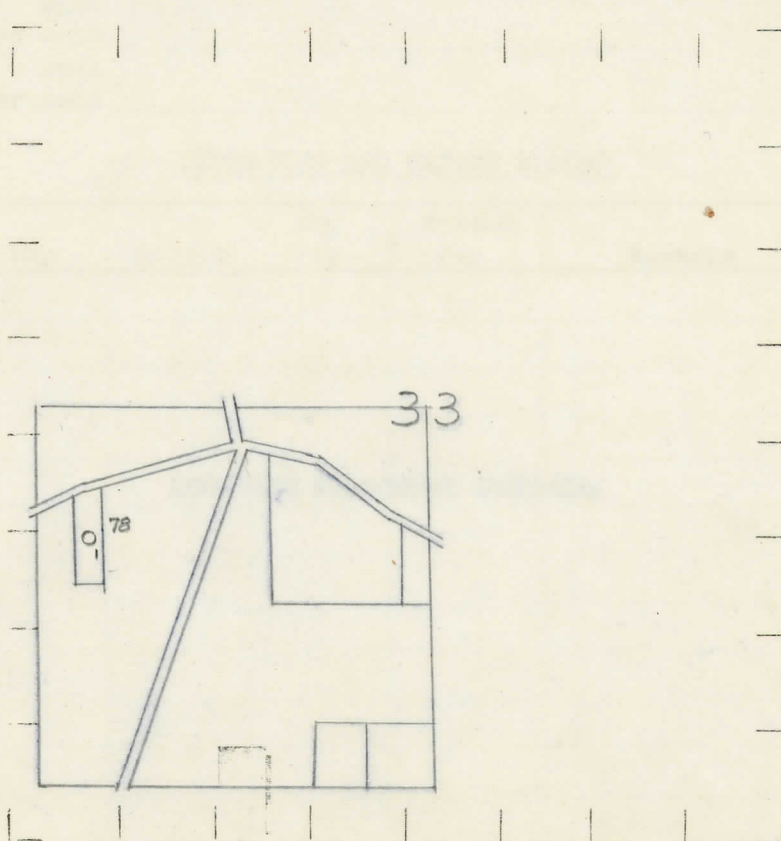

REMARKS:

SIGNED

*R. A. J.*

Superintendent or Foreman.

