



Western Michigan University  
ScholarWorks at WMU

---

Legacy Scout Tickets from Pure Oil Company

---

8-20-2021

## MGRRE\_PureOilScoutTickets\_Hendershot, William & Anna\_1\_21081061980000

MGRRE

*Western Michigan University*

Follow this and additional works at: <https://scholarworks.wmich.edu/pure>



Part of the Geology Commons

---

### WMU ScholarWorks Citation

MGRRE, "MGRRE\_PureOilScoutTickets\_Hendershot, William & Anna\_1\_21081061980000" (2021). *Legacy Scout Tickets from Pure Oil Company*. 3974.  
<https://scholarworks.wmich.edu/pure/3974>

This Document is brought to you for free and open access via ScholarWorks at WMU. It has been accepted for inclusion in Legacy Scout Tickets from Pure Oil Company by an authorized administrator of ScholarWorks at WMU. See the National Digital Catalogue - Science Base Catalogue for more collections submitted by MGRRE.



---

**MGRRE\_PureOilScoutTickets\_Hendershot, William & Anna\_1\_21081061980000**

API 21081061980000

Permit Number 6198

Lease Name Hendershot, William & Anna

Well Number 1

County Kent

Township 08N

Range 12W

Section 29

2021 DEQ or Pure co\_name Teater, C, W.

Pure Number 96

Latitude 43.05486

Longitude -85.7572

THE PURE OIL COMPANY

COMPLETION RECORD OF WELLS DRILLED BY OTHER OPERATORS

DATE May 18, 1939

LOCATION REPORT

No. 96

STATE Michigan COUNTY Kent DIST. Alpine TWP. Alpine SEC. 29 TOWN 8 N RANGE 12 W

WELL No. 1 (SERIAL No. 96) FARM Wm. Hendershot ACRES

NAME OF STREAM OR WATERS \_\_\_\_\_ QUADRANGLE NW-SW-NE

OPERATOR C. W. Teater Map Alpine Township, Kent County

3330 Feet from North Line of Farm

" " East " " "

" " South " " "

3330 " " West " " "

Feet from North Line of Section

" " East " " "

9990 " " South " 1/4 "

3330 " " West " 1/4 "

- LEGEND**
- LOCATION
  - ⊕ DRILLING
  - ☀ GAS WELL
  - OIL WELL
  - ⊙ SMALL OIL WELL
  - ⊖ DRY HOLE
  - ⊕ DRY SHOWING OIL
  - ⊖ DRY SHOWING GAS
  - ⊙ ABANDONED LOCATION
  - ☀ ABANDONED GAS WELL
  - ⊙ ABANDONED OIL WELL

NOTE: Below make tracing from map, (when no map is obtainable make sketch) showing farm, center of section, this location with measurements and also wells, dry holes, or other locations in the vicinity of this location.

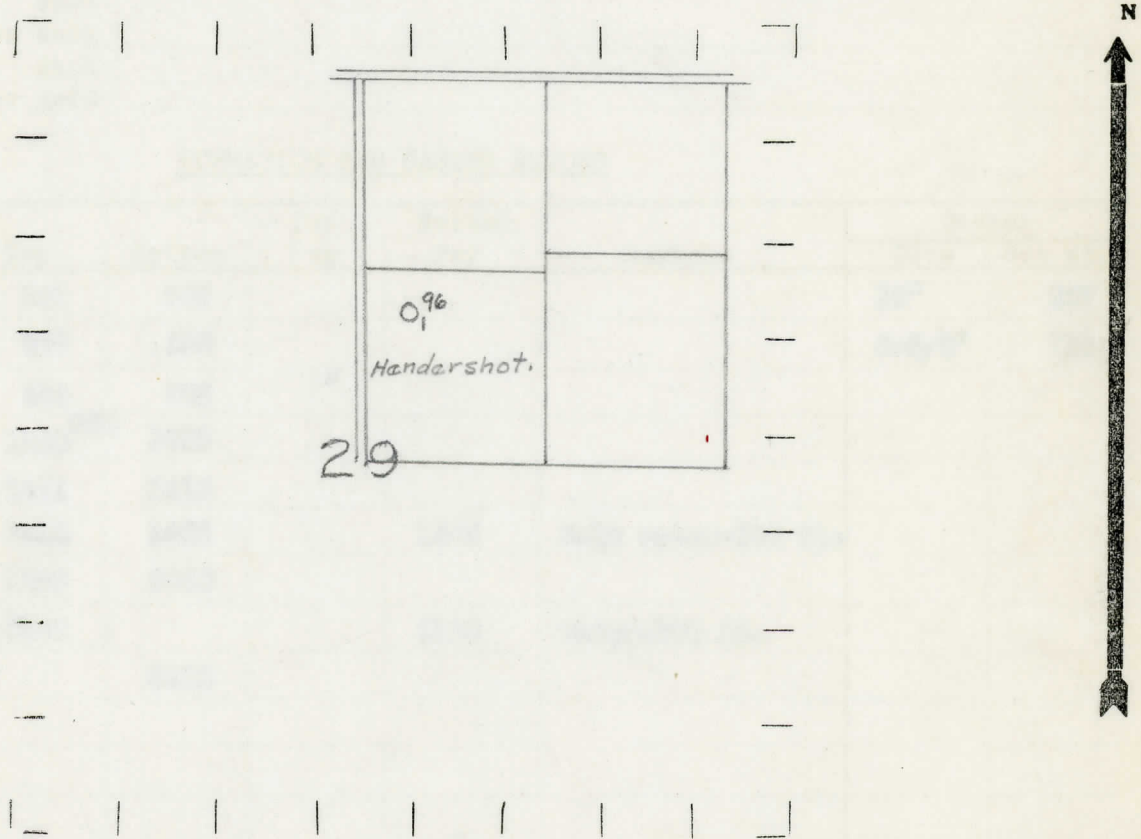

REMARKS:

\_\_\_\_\_  
\_\_\_\_\_  
\_\_\_\_\_

SIGNED

Superintendent or Foreman.

Michigan Producing Division

Date August 10, 1939 No. 96  
 State Mich. County Kent Dist. Alpine Twp. 8 N Rge. 12 W  
 (Serial No.)  
 Well No. 1 (County No.) 96 Farm Wm. Hendershot Acres  
 Operator C. W. Teater Information secured By Scouting Department  
 Date well started 5-23-39 Dated well completed 8-5-39 Elevation 764.5

PRODUCTION RECORD

1st 24 hours natural Dry Hole  
 2nd 24 hours natural  
 Date of shot No. of quarts From to From to  
 Date of acid No. of gallons  
 shot  
 1st 24 hours after acid  
 shot  
 2nd 24 hours after acid

FORMATION AND CASING RECORD

Formation	Top	Bottom	Top Pay	Bottom Pay	Remarks	Casing	
						Size	Set at
Marshall	691	702				10"	207
"	437	535				6-5/8"	713
"	544	683					
Red Rock	1380 <sup>CTM</sup>	1392					
Sunbury	1412	1419					
Berea	1419	1446		1446	Salt water-200 ft.		
Antrim	1885	2060					
Traverse Lime	2105			2120	Water-200 ft.		
Total Depth		2225					

Remarks

Signed D. C. Shackelford