



Western Michigan University
ScholarWorks at WMU

Legacy Scout Tickets from Pure Oil Company

8-20-2021

MGRRE_PureOilScoutTickets_Gilbert, Wm H Estate_4_21081063980000

MGRRE

Western Michigan University

Follow this and additional works at: <https://scholarworks.wmich.edu/pure>



Part of the Geology Commons

WMU ScholarWorks Citation

MGRRE, "MGRRE_PureOilScoutTickets_Gilbert, Wm H Estate_4_21081063980000" (2021). *Legacy Scout Tickets from Pure Oil Company*. 4024.

<https://scholarworks.wmich.edu/pure/4024>

This Document is brought to you for free and open access via ScholarWorks at WMU. It has been accepted for inclusion in Legacy Scout Tickets from Pure Oil Company by an authorized administrator of ScholarWorks at WMU. See the National Digital Catalogue - Science Base Catalogue for more collections submitted by MGRRE.



MGRRE_PureOilScoutTickets_Gilbert, Wm H Estate_4_21081063980000

API 21081063980000

Permit Number 6398

Lease Name Gilbert, Wm H Estate

Well Number 4

County Kent

Township 06N

Range 12W

Section 4

2021 DEQ or Pure co_name Smith Petroleum Company

Pure Number 146

Latitude 42.93651

Longitude -85.73685

THE PURE OIL COMPANY

LOCATION REPORT

No. 146

DATE June 29, 1939

STATE Michigan COUNTY Kent DIST. Walker TWP. Walker SEC. 4 TOWN 6 N RANGE 12 W WELL No. 4 (SERIAL No. 146) FARM Wm. H. Gilbert Estate ACRES

NAME OF STREAM OR WATERS QUADRANGLE SE SE NW

OPERATOR Smith Petroleum Company, et al Map Walker Township, Kent County

262807 Feet from North Line of Farm

East " " "

South " " "

West " " "

222280 Feet from North Line of Section

582582 East 1/4 " "

South " " "

West " " "

LEGEND

- LOCATION
⊕ DRILLING
☀ GAS WELL
● OIL WELL
● SMALL OIL WELL
⊕ DRY HOLE
● DRY SHOWING OIL
☀ DRY SHOWING GAS
⊕ ABANDONED LOCATION
☀ ABANDONED GAS WELL
● ABANDONED OIL WELL

NOTE: Below make tracing from map, (when no map is obtainable make sketch) showing farm, center of section, this location with measurements and also wells, dry holes, or other locations in the vicinity of this location.

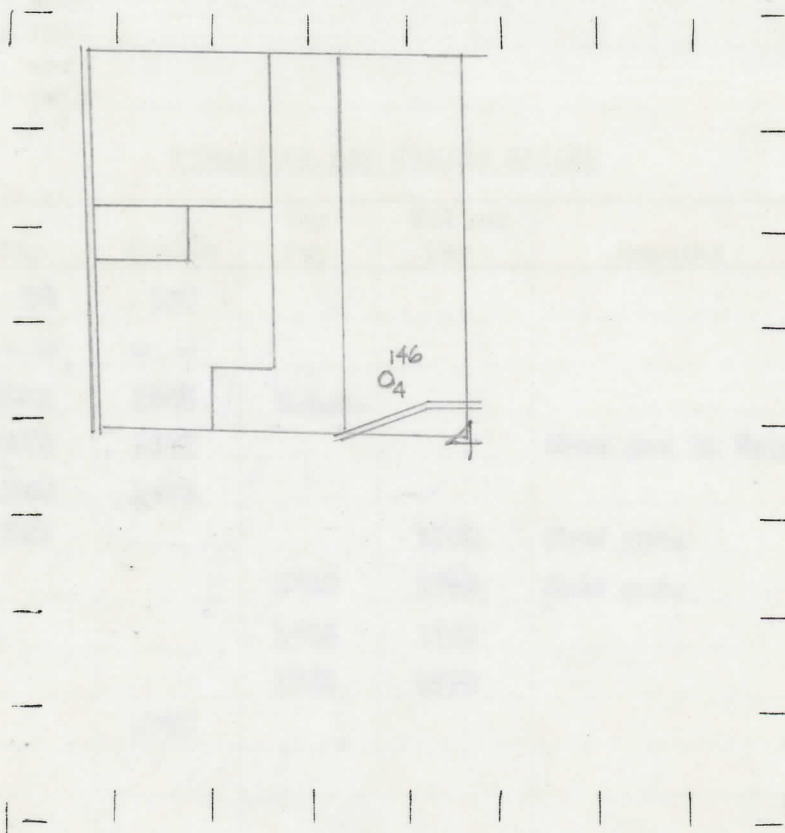

REMARKS:

3010-N
785-E

SIGNED

Superintendent or Foreman.

COMPLETION RECORD OF WELLS DRILLED BY OTHER OPERATORS

Michigan Producing Division

Date **July 20, 1939** No. **146**
 State **Mich.** County **Kent** ~~XXXX~~ Twp. **Walker** Sec. **4** Twp. **6 N** Rge. **12 W**
 Well No. **4** (Serial No.) ~~XXXXXX~~ **146** Farm **Wm. H. Gilbert Estate** Acres
 Operator **Smith Petroleum Company, et al** Information secured ~~XXXX~~ By **Scouting Department**
 Date well started **6-27-39** Dated well completed **7-16-39** Elevation **605.8**

PRODUCTION RECORD

1st 24 hours natural **3528 Barrels**
 2nd 24 hours natural
 Date of shot No. of quarts From to From to
 Date of acid No. of gallons
 1st 24 hours after acid shot
 2nd 24 hours after acid shot

FORMATION AND CASING RECORD

Formation	Top	Bottom	Top Pay	Bottom Pay	Remarks	Casing	
						Size	Set at
Marshall	70	337				10"	51
Coldwater Line	- -	- -				8-1/4"	395
Red Rock	1051	1066	S.L.M.			6-5/8"	1105
Berea	1073	1102			Show gas in Berea.	5-3/16"	1703
Antrim	1560	1678					
Traverse Line	1727			1730	Show gas.		
				1740	Show gas.		
				1746			
				1762			
Total Depth		1773					

Remarks **On July 18th this well was flowing 117 barrels per hour 1/2 of 1% salt water.**

Signed **D. C. Shackelford**