



Western Michigan University
ScholarWorks at WMU

Legacy Scout Tickets from Pure Oil Company

8-20-2021

**MGRRE_PureOilScoutTickets_Robinette,
Edward_1_21081064180000**

MGRRE
Western Michigan University

Follow this and additional works at: <https://scholarworks.wmich.edu/pure>



Part of the Geology Commons

WMU ScholarWorks Citation

MGRRE, "MGRRE_PureOilScoutTickets_Robinette, Edward_1_21081064180000" (2021). *Legacy Scout Tickets from Pure Oil Company*. 4028.
<https://scholarworks.wmich.edu/pure/4028>

This Document is brought to you for free and open access via ScholarWorks at WMU. It has been accepted for inclusion in Legacy Scout Tickets from Pure Oil Company by an authorized administrator of ScholarWorks at WMU. See the National Digital Catalogue - Science Base Catalogue for more collections submitted by MGRRE.



MGRRE_PureOilScoutTickets_Robinette, Edward_1_21081064180000

API 21081064180000

Permit Number 6418

Lease Name Robinette, Edward

Well Number 1

County Kent

Township 08N

Range 11W

Section 34

2021 DEQ or Pure co_name Neal, C. J.

Pure Number 150

Latitude 43.0363

Longitude -85.59377

THE PURE OIL COMPANY

COMPLETION RECORD OF WELLS DRILLED BY OTHER OPERATORS

DATE July 7, 1939

LOCATION REPORT

No. 150

STATE Michigan COUNTY Kent DISTRICT Plainfield SEC. 34 TOWN 8 N RANGE 11 W
 WELL No. 1 (SERIAL No. 150) FARM Edward Robinette ACRES _____
 NAME OF STREAM OR WATERS _____ QUADRANGLE SW SE NE
 OPERATOR Carl J. Neal Map Plainfield Township, Kent County

Feet from North Line of Farm
 " " East " " "
330 330 " " South " " "
330 330 " " West " " "
 Feet from North Line of Section
990 990 " " East " "1/4"
330 330 " " South " "1/4"
 " " West " " "

LEGEND

- LOCATION
- ⊕ DRILLING
- ☀ GAS WELL
- OIL WELL
- ⦿ SMALL OIL WELL
- ⊖ DRY HOLE
- ⦿ DRY SHOWING OIL
- ☀ DRY SHOWING GAS
- ⊖ ABANDONED LOCATION
- ☀ ABANDONED GAS WELL
- ⦿ ABANDONED OIL WELL

NOTE: Below make tracing from map, (when no map is obtainable make sketch) showing farm, center of section, this location with measurements and also wells, dry holes, or other locations in the vicinity of this location.

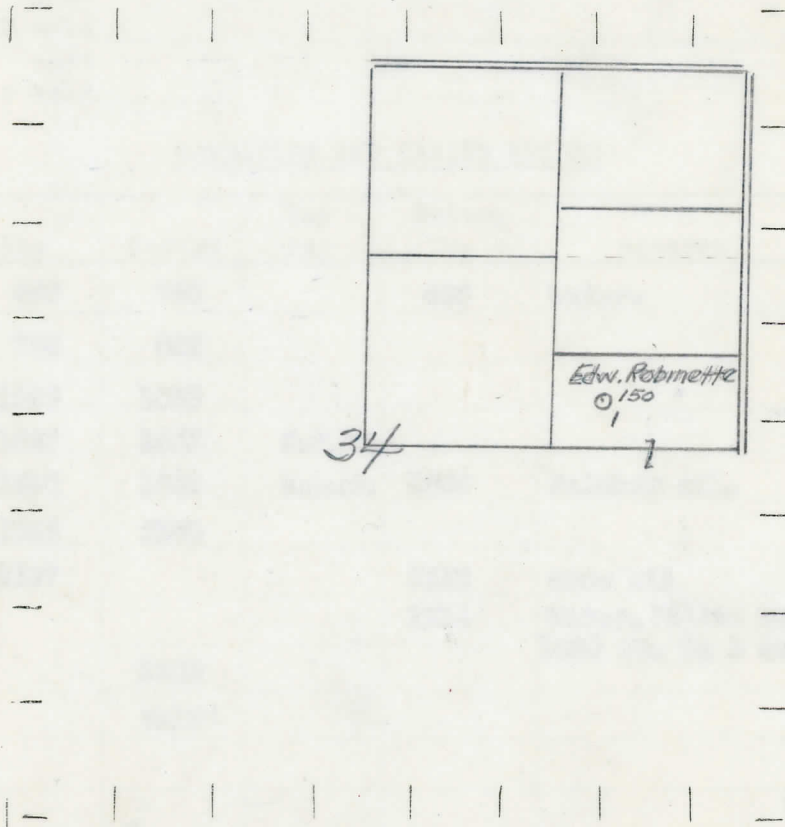

REMARKS:

SIGNED

Subintendent or Foreman.

Michigan Producing Division

Date September 21, 1939 No. 150
 State Mich. County Kent Twp. Plainfield Sec. 34 Twp. 8 N Rge. 11 W
 Well No. 1 (Serial No.) 150 Farm Edward Robinette Acres _____
 Operator Carl J. Neal Information secured By Scouting Department
 Date well started 7-17-39 Dated well completed 9-2-39 Elevation 788.0

PRODUCTION RECORD

1st 24 hours natural Dry Hole
 2nd 24 hours natural _____
 Date of shot _____ No. of quarts _____ From _____ to _____
 Date of acid _____ No. of gallons _____
 shot _____
 1st 24 hours after acid _____
 shot _____
 2nd 24 hours after acid _____

FORMATION AND CASING RECORD

Formation	Top	Bottom	Top Pay	Bottom Pay	Remarks	Casing	
						Size	Set at
Marshall	495	760		495	Water.	10"	235
Coldwater Line	770	805				8-1/4"	408
" "	1035	1055				6-5/8"	820
Red Rock	1547	1565	C.T.M.				
Berea	1590	1640	S.L.M.	1600	Rainbow oil.		
Antrim	1945	2160					
Traverse Line	2207			2212	Show oil		
				2214	Water. Filled up		
Total Depth		2268			1400 ft. in 5 days.		
Plugged Back:		2213'					

Remarks Water at 465'. 1726' C.T.M. equals 1738' S.L.M.

Signed D. C. Shackelford