



Western Michigan University
ScholarWorks at WMU

Legacy Scout Tickets from Pure Oil Company

8-20-2021

**MGRRE_PureOilScoutTickets_Christensen,
Stewart_1_21081064620000**

MGRRE
Western Michigan University

Follow this and additional works at: <https://scholarworks.wmich.edu/pure>



Part of the Geology Commons

WMU ScholarWorks Citation

MGRRE, "MGRRE_PureOilScoutTickets_Christensen, Stewart_1_21081064620000" (2021). *Legacy Scout Tickets from Pure Oil Company*. 4037.
<https://scholarworks.wmich.edu/pure/4037>

This Document is brought to you for free and open access via ScholarWorks at WMU. It has been accepted for inclusion in Legacy Scout Tickets from Pure Oil Company by an authorized administrator of ScholarWorks at WMU. See the National Digital Catalogue - Science Base Catalogue for more collections submitted by MGRRE.



MGRRE_PureOilScoutTickets_Christensen, Stewart_1_21081064620000

API 21081064620000

Permit Number 6462

Lease Name Christensen, Stewart

Well Number 1

County Kent

Township 06N

Range 11W

Section 27

2021 DEQ or Pure co_name Oryx Energy Company

Pure Number 159

Latitude 42.8827

Longitude -85.59773

THE PURE OIL COMPANY

COMPLETION RECORD OF WELLS DRILLED BY OTHER OPERATORS

DATE July 24, 1939

LOCATION REPORT

No. 159

STATE Michigan COUNTY Kent DIST. Paris TWP. Paris SEC. 27 TOWN 6 N RANGE 11 W

WELL No. 1 (SERIAL No. 159) FARM Stewart Christensen ACRES

NAME OF STREAM OR WATERS QUADRANGLE NE NE NW

OPERATOR Sun Oil Company Map Paris Township, Kent County

330 Feet from North Line of Farm

330 " " East " " "

" " South " " "

" " West " " "

3330 Feet from North Line of Section

3330 " " East " 1/4 "

" " South " " "

" " West " " "

LEGEND

○ LOCATION

⊙ RIG

⊕ DRILLING

☀ GAS WELL

● OIL WELL

⊙ SMALL OIL WELL

⊙ DRY HOLE

⊙ DRY SHOWING OIL

⊙ DRY SHOWING GAS

⊙ ABANDONED LOCATION

⊙ ABANDONED GAS WELL

⊙ ABANDONED OIL WELL

NOTE: Below make tracing from map, (when no map is obtainable make sketch) showing farm, center of section, this location with measurements and also wells, dry holes, or other locations in the vicinity of this location.

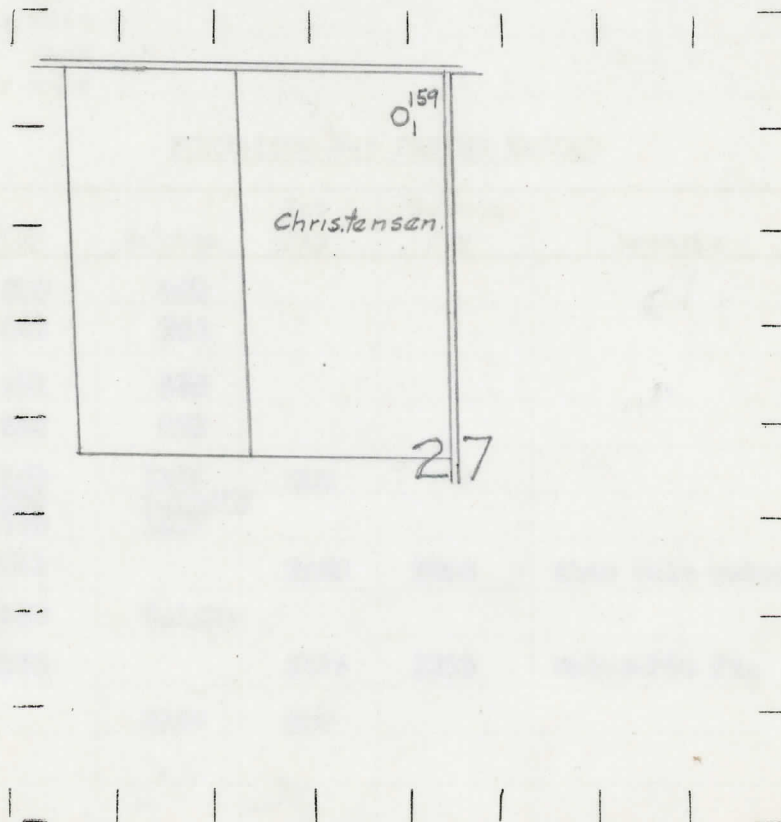

REMARKS:

SIGNED

Superintendent or Foreman.

Michigan Producing Division

Date August 17, 1939 No. 159
 State Mich. County Kent Dist. Paris
 (Serial No.) Twp. Paris Sec. 27 Twp. 6 N Rge. 11 W
 Well No. 1 (County No.) 159 Farm Stewart Christensen Acres
 Operator Sun Oil Company By Scouting Department
 Information secured from Scouting Department
 Date well started 7-20-39 Dated well completed 8-12-39 Elevation 777.2

PRODUCTION RECORD

1st 24 hours natural Dry Hole
 2nd 24 hours natural
 Date of shot No. of quarts From to From to
 Date of acid No. of gallons
 shot
 1st 24 hours after acid
 shot
 2nd 24 hours after acid

FORMATION AND CASING RECORD

Formation	Top	Bottom	Top Pay	Bottom Pay	Remarks	Casing	
						Size	Set at
Marshall	305	340				10"	223
"	343	395				8-1/4"	582
"	431	555				6-5/8"	1987
Coldwater Lime	858	868					
Red Rock	1369	1383	SLM				
Berea	1390	1410	SLM				
Antrim	1748	1957					
Traverse Line	2011		2260	2295	Show salt water.		
Dundee	2320	S.L.M.					
Monroe	2375		2379	2395	Water-350 ft.		
Total Depth		2395	SLM				

Remarks

Signed D. C. Shackelford