



Western Michigan University  
ScholarWorks at WMU

---

Legacy Scout Tickets from Pure Oil Company

---

8-20-2021

**MGRRE\_PureOilScoutTickets\_Newhouse,  
Samuel\_1\_21081067650000**

MGRRE

*Western Michigan University*

Follow this and additional works at: <https://scholarworks.wmich.edu/pure>



Part of the Geology Commons

---

#### **WMU ScholarWorks Citation**

MGRRE, "MGRRE\_PureOilScoutTickets\_Newhouse, Samuel\_1\_21081067650000" (2021). *Legacy Scout Tickets from Pure Oil Company*. 4148.

<https://scholarworks.wmich.edu/pure/4148>

This Document is brought to you for free and open access via ScholarWorks at WMU. It has been accepted for inclusion in Legacy Scout Tickets from Pure Oil Company by an authorized administrator of ScholarWorks at WMU. See the National Digital Catalogue - Science Base Catalogue for more collections submitted by MGRRE.



---

**MGRRE\_PureOilScoutTickets\_Newhouse, Samuel\_1\_21081067650000**

API 21081067650000

Permit Number 6765

Lease Name Newhouse, Samuel

Well Number 1

County Kent

Township 07N

Range 12W

Section 29

2021 DEQ or Pure co\_name Goodale Enterprises LLC

Pure Number 270

Latitude 42.965963

Longitude -85.7600615

THE PURE OIL COMPANY

COMPLETION RECORD OF WELLS LOCATED BY OTHER OPERATORS

DATE September 21, 1939

LOCATION REPORT

No. 270

STATE Mich. COUNTY Kent DISTRICT Walker TWP. Walker SEC. 29 TOWN 7 N RANGE 12 W  
 WELL No. 1 (SERIAL No. 270) FARM Samuel Newhouse ACRES \_\_\_\_\_

NAME OF STREAM OR WATERS \_\_\_\_\_ QUADRANGLE SW SE NW

OPERATOR Fisher & McCall Oil & Gas, Inc., et al Map Walker Township, Kent County  
Fisher & McCall Oil & Gas Inc. Walker - Kent.

Feet from North Line of Farm  
 " " East " " "  
 " " South " " "  
 " " West " " "  
 Feet from North Line of Section  
 " " East " 1/4  
 " " South " 1/4  
 " " West " " "

325  
Sp 9-17-39  
85/8 173  
T Marsh  
200

LEGEND

- LOCATION
- ⊙ RIG
- ⊕ DRILLING
- ☀ GAS WELL
- OIL WELL
- ⦿ SMALL OIL WELL
- ⊖ DRY HOLE
- ⊙ DRY SHOWING OIL
- ⊖ DRY SHOWING GAS
- ⊖ ABANDONED LOCATION
- ☀ ABANDONED GAS WELL
- ⦿ ABANDONED OIL WELL

NOTE: Below make tracing from map, (when no map is obtainable make sketch) showing farm, center of section, this location with measurements and also wells, dry holes, or other locations in the vicinity of this location.

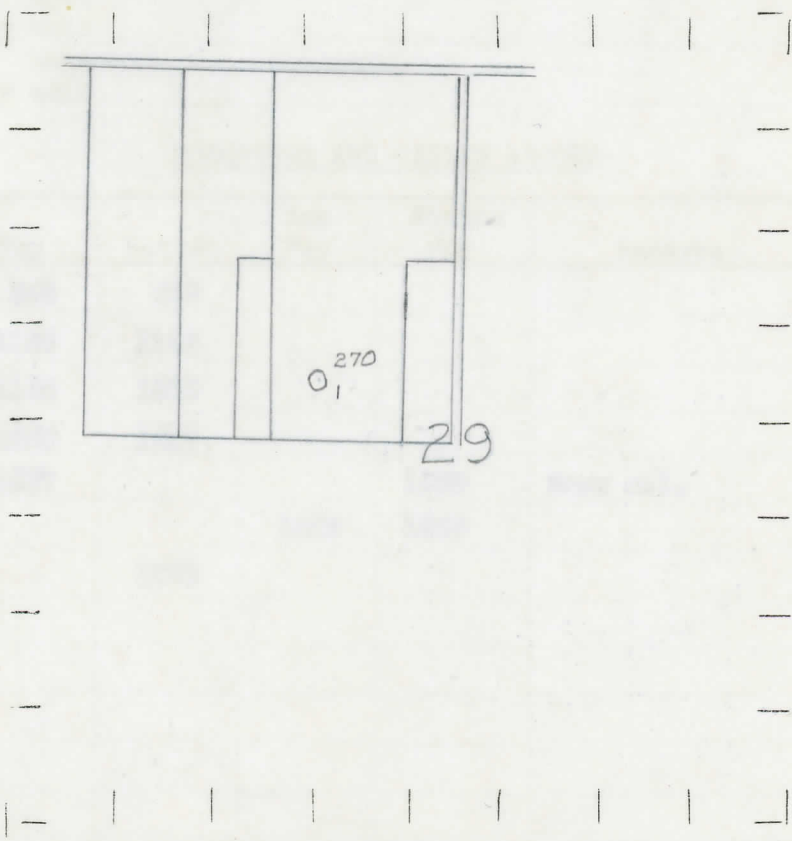

REMARKS:

SIGNED

Superintendent or Foreman.

Michigan Producing Division

Date **October 5, 1939** No. **270**  
 State **Mich.** County **Kent** Dist. **Walker** Twp. **Walker** Sec. **29** Twp. **7 N** Rge. **12 W**  
 Well No. **1** (Serial No.) **(County)** **270** Farm **Samuel Newhouse** Acres \_\_\_\_\_  
 Operator **Fisher-McCall Oil & Gas, Inc., et al** Information secured **By Scouting Department**  
 Date well started **9-17-39** Dated well completed **9-30-39** Elevation **707.6**

PRODUCTION RECORD

1st 24 hours natural **Est. 1200 Barrels**  
 2nd 24 hours natural \_\_\_\_\_  
 Date of shot \_\_\_\_\_ No. of quarts \_\_\_\_\_ From \_\_\_\_\_ to \_\_\_\_\_ From \_\_\_\_\_ to \_\_\_\_\_  
 Date of acid \_\_\_\_\_ No. of gallons \_\_\_\_\_  
 shot \_\_\_\_\_  
 1st 24 hours after acid \_\_\_\_\_  
 shot \_\_\_\_\_  
 2nd 24 hours after acid \_\_\_\_\_

FORMATION AND CASING RECORD

Formation	Top	Bottom	Top Pay	Bottom Pay	Remarks	Casing	
						Size	Set at
Marshall	200	465				8-5/8"	173
Red Rock	1165	1184				5-3/16"	1858
Berea	1184	1215					
Antrim	1660	1812					
Traverse Lime	1857			1858	Show oil.		
			1863	1868			
Total Depth		1868					

Remarks \_\_\_\_\_  
 \_\_\_\_\_  
 \_\_\_\_\_

Signed **D. C. Shackelford**