



Western Michigan University
ScholarWorks at WMU

Legacy Scout Tickets from Pure Oil Company

8-20-2021

MGRRE_PureOilScoutTickets_J. Thurkettle_3_21081069140000

MGRRE

Western Michigan University

Follow this and additional works at: <https://scholarworks.wmich.edu/pure>



Part of the Geology Commons

WMU ScholarWorks Citation

MGRRE, "MGRRE_PureOilScoutTickets_J. Thurkettle_3_21081069140000" (2021). *Legacy Scout Tickets from Pure Oil Company*. 4199.

<https://scholarworks.wmich.edu/pure/4199>

This Document is brought to you for free and open access via ScholarWorks at WMU. It has been accepted for inclusion in Legacy Scout Tickets from Pure Oil Company by an authorized administrator of ScholarWorks at WMU. See the National Digital Catalogue - Science Base Catalogue for more collections submitted by MGRRE.



MGRRE_PureOilScoutTickets_J. Thurkettle_3_21081069140000

API 21081069140000

Permit Number 6914

Lease Name J. Thurkettle

Well Number 3

County Kent

Township 07N

Range 12W

Section 29

2021 DEQ or Pure co_name Goodale Enterprises LLC

Pure Number 321

Latitude 42.9621448

Longitude -85.7601086

THE PURE OIL COMPANY
 LOCATION REPORT

DATE Oct. 26, 1939

No. 321

STATE Mich. COUNTY Kent DIST. Walker SEC. 29 TOWN 7 N RANGE 12 W

WELL No. 33 (SERIAL No. 321) FARM Jane Thirkettle ACRES

NAME OF STREAM OR WATERS Cardon Oil Co. 2-5-52 QUADRANGLE SW-NE-SW

OPERATOR H.C. Williams Petroleum Industries Map Walker-Kent

Feet from North Line of Farm

		East		
<u>330</u>	<u>330</u>	South		
<u>330</u>	<u>330</u>	West		
<u>990</u>	<u>990</u>	Feet from North Line of Section		
<u>990</u>	<u>990</u>	East		
		South		
		West		

321

LEGEND

- LOCATION
- ⊕ RIG
- ⊕ DRILLING
- ☀ GAS WELL
- OIL WELL
- ⊕ SMALL OIL WELL
- ⊖ DRY HOLE
- ⊕ DRY SHOWING OIL
- ⊖ DRY SHOWING GAS
- ⊖ ABANDONED LOCATION
- ☀ ABANDONED GAS WELL
- ⊖ ABANDONED OIL WELL

NOTE: Below make tracing from map, (when no map is obtainable make sketch) showing farm, center of section, this location with measurements and also wells, dry holes, or other locations in the vicinity of this location.

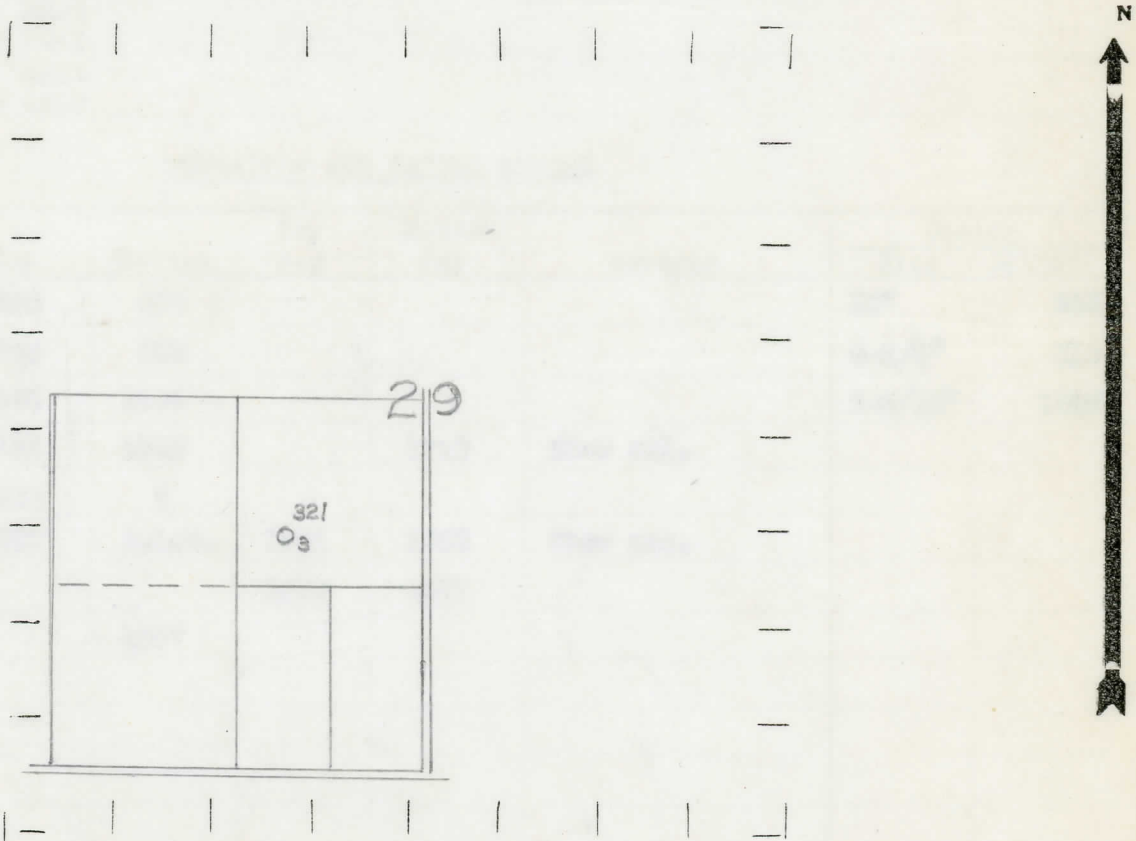

REMARKS:

SIGNED

Subintendent or Foreman

Michigan Producing Division

Date November 16, 1939 No. 321
 State Mich. County Kent ~~District~~ Twp. Walker Sec. 29 Twp. 7 N Rge. 12 W
 Well No. 3 (Serial No.) 321 Farm Jane Therkettle Acres _____
 Operator H. C. Williams Information secured ~~from~~ Scouting Department By _____
 Date well started 10-22-39 Dated well completed 11-10-39 Elevation 735.3

PRODUCTION RECORD

1st 24 hours natural Est. 1500 Barrels
 2nd 24 hours natural _____
 Date of shot _____ No. of quarts _____ From _____ to _____ From _____ to _____
 Date of acid _____ No. of gallons _____
 shot _____
 1st 24 hours after acid _____
 shot _____
 2nd 24 hours after acid _____

FORMATION AND CASING RECORD

Formation	Top	Bottom	Top Pay	Bottom Pay	Remarks	Casing	
						Size	Set at
Marshall	220	475				10"	228
Coldwater Lime	765	800				8-1/4"	510
Red Rock	1186	1194				5-3/16"	1862
Berea	1195	1240		1210	Show oil.		
Antrim	1660	?					
Traverse Lime	1862	S.L.M.	1862	1865	Show gas.		
			1870	1877			
Total Depth		1877					

Remarks _____

Signed D. C. Shackelford