



Western Michigan University  
ScholarWorks at WMU

---

Legacy Scout Tickets from Pure Oil Company

---

8-20-2021

**MGRRE\_PureOilScoutTickets\_O'Sullivan,  
Julia\_4\_21081069170000**

MGRRE  
*Western Michigan University*

Follow this and additional works at: <https://scholarworks.wmich.edu/pure>



Part of the Geology Commons

---

#### **WMU ScholarWorks Citation**

MGRRE, "MGRRE\_PureOilScoutTickets\_O'Sullivan, Julia\_4\_21081069170000" (2021). *Legacy Scout Tickets from Pure Oil Company*. 4202.  
<https://scholarworks.wmich.edu/pure/4202>

This Document is brought to you for free and open access via ScholarWorks at WMU. It has been accepted for inclusion in Legacy Scout Tickets from Pure Oil Company by an authorized administrator of ScholarWorks at WMU. See the National Digital Catalogue - Science Base Catalogue for more collections submitted by MGRRE.



---

**MGRRE\_PureOilScoutTickets\_O'Sullivan, Julia\_4\_21081069170000**

API 21081069170000

Permit Number 6917

Lease Name O'Sullivan, Julia

Well Number 4

County Kent

Township 07N

Range 12W

Section 30

2021 DEQ or Pure co\_name Smith Petroleum Company and Wolverine Natural Gas

Pure Number 324

Latitude 42.95882

Longitude -85.78238

THE PURE OIL COMPANY  
COMPLETION RECORD OF WELL DRILLED BY OTHER OPERATORS

DATE Oct. 26, 1939

LOCATION REPORT

No. 324

STATE Mich. COUNTY Kent DIST. Walker TWP. Walker SEC. 30 TOWN. 7 N RANGE 12 W

WELL No. 4 (SERIAL No. 324) FARM Julia O'Sullivan ACRES

NAME OF STREAM OR WATERS QUADRANGLE SW-SW-SW

OPERATOR Smith Pet. Co., et al Map Walker-Kent

Feet from North Line of Farm  
396 396 " " East " " "  
357 357 " " South " " "  
" " West " " "

Feet from North Line of Section  
" " East " " "  
357 357 " " South " " "  
543 543 " " West " " "

LEGEND

- LOCATION
- ⊕ RIG
- ⊕ DRILLING
- ☀ GAS WELL
- OIL WELL
- ⊕ SMALL OIL WELL
- ⊖ DRY HOLE
- ⊕ DRY SHOWING OIL
- ☀ DRY SHOWING GAS
- ⊖ ABANDONED LOCATION
- ☀ ABANDONED GAS WELL
- ⊖ ABANDONED OIL WELL

NOTE: Below make tracing from map, (when no map is obtainable make sketch) showing farm, center of section, this location with measurements and also wells, dry holes, or other locations in the vicinity of this location.

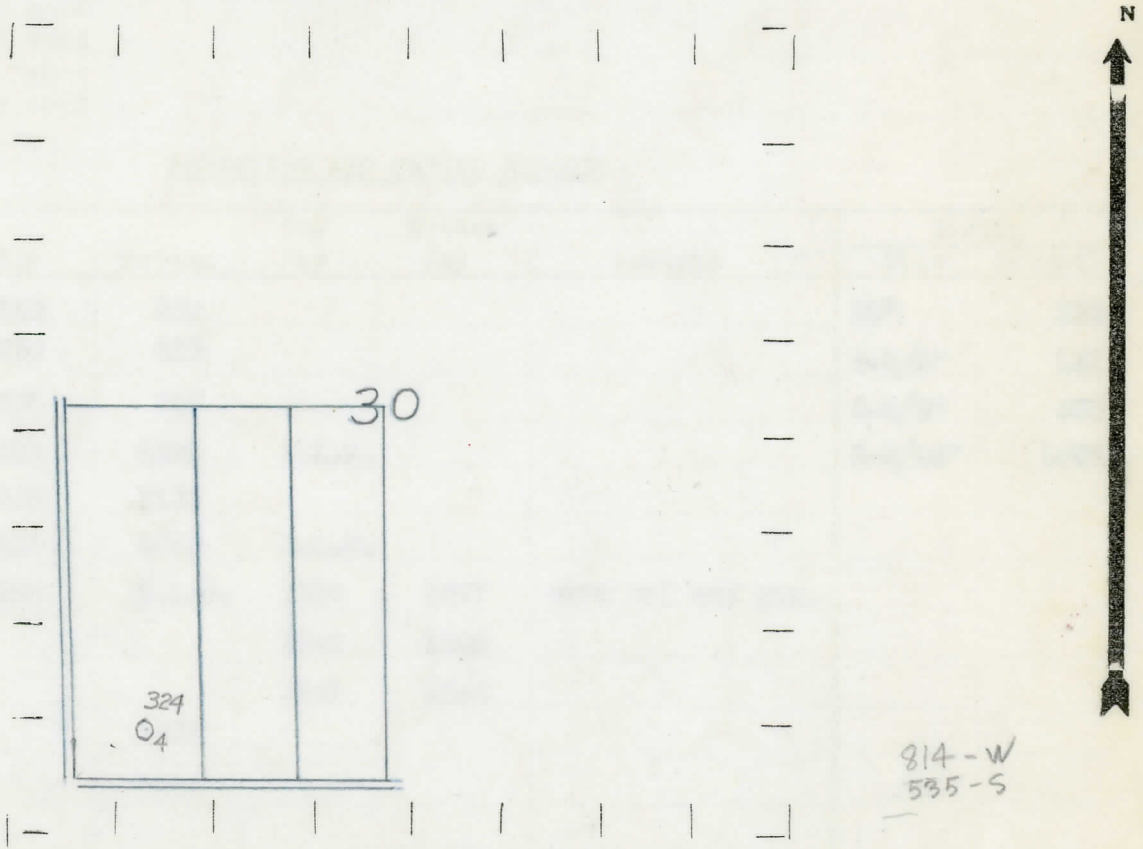

REMARKS:

SIGNED

Superintendent or Foreman.

Michigan Producing Division

Date November 22, 1939 No. 324  
 State Mich. County Kent District Walker Twp. Walker Sec. 50 Twp. 7 N Rge. 12 W  
 Well No. 4 (Serial No.) 324 Farm Julia O'Sullivan Acres \_\_\_\_\_  
 Operator Smith Petroleum Company, et al Information secured from Scouting Department  
 Date well started 10-29-39 Dated well completed 11-15-39 Elevation 675.6

PRODUCTION RECORD

1st 24 hours natural Est. 100 Barrels  
 2nd 24 hours natural \_\_\_\_\_  
 Date of shot \_\_\_\_\_ No. of quarts \_\_\_\_\_ From \_\_\_\_\_ to \_\_\_\_\_ From \_\_\_\_\_ to \_\_\_\_\_  
 Date of acid \_\_\_\_\_ No. of gallons \_\_\_\_\_  
 1st 24 hours after acid shot \_\_\_\_\_  
 2nd 24 hours after acid shot \_\_\_\_\_

FORMATION AND CASING RECORD

Formation	Top	Bottom	Top Pay	Bottom Pay	Remarks	Casing	
						Size	Set at
Marshall	160	260				10"	134
"	280	419				8-1/4"	147
Coldwater Lime	705	717				6-5/8"	470
Red Rock	1125	1140	S.L.M.			5-3/16"	1803
Berea	1154	1179					
Antrim	1635	1780	S.L.M.				
Traverse Lime	1829	S.L.M.	1834	1837	Show oil and gas.		
			1844	1849			
			1851	1856			
Total Depth		1856					

Remarks \_\_\_\_\_

Signed D. C. Shackelford