



Western Michigan University  
ScholarWorks at WMU

---

Legacy Scout Tickets from Pure Oil Company

---

8-20-2021

## MGRRE\_PureOilScoutTickets\_Miller, Semposki, Macneal Comm.\_1\_21081060370000

MGRRE

*Western Michigan University*

Follow this and additional works at: <https://scholarworks.wmich.edu/pure>



Part of the Geology Commons

---

### WMU ScholarWorks Citation

MGRRE, "MGRRE\_PureOilScoutTickets\_Miller, Semposki, Macneal Comm.\_1\_21081060370000" (2021).  
*Legacy Scout Tickets from Pure Oil Company*. 4213.  
<https://scholarworks.wmich.edu/pure/4213>

This Document is brought to you for free and open access via ScholarWorks at WMU. It has been accepted for inclusion in Legacy Scout Tickets from Pure Oil Company by an authorized administrator of ScholarWorks at WMU. See the National Digital Catalogue - Science Base Catalogue for more collections submitted by MGRRE.



---

**MGRRE\_PureOilScoutTickets\_Miller, Semposki, Macneal  
Comm.\_1\_21081060370000**

API 21081060370000

Permit Number 6037

Lease Name Miller, Semposki, Macneal Comm.

Well Number 1

County Kent

Township 06N

Range 12W

Section 13

2021 DEQ or Pure co\_name Sprenger Brothers

Pure Number 335

Latitude 42.90151

Longitude -85.68391

THE PURE OIL COMPANY  
COMPLETION RECORD OF THIS WELL BY OTHER OPERATORS  
LOCATION REPORT

DATE Oct. 26, 1939

No. 335

STATE Mich COUNTY Kent DIST. Wyoming SEC. 13 TOWN 6 N RANGE 12 W

WELL No. 1 (SERIAL No. 335) FARM Miller, et al - Community ACRES

NAME OF STREAM OR WATERS \_\_\_\_\_ QUADRANGLE NW-SW-SW

OPERATOR Sprenger Brothers Map Wyoming-Kent

320330 Sprenger Bros.  
Feet from North Line of Farm

320330 " " East " " "

330 330 " " South " " "

330 330 " " West " " "

Feet from North Line of Section

" " East " " "

990 990 " " South " " "

330 330 " " West " " "

LEGEND

- LOCATION
- ⊕ RIG
- ⊕ DRILLING
- ☀ GAS WELL
- OIL WELL
- ⬮ SMALL OIL WELL
- ⊖ DRY HOLE
- ⬮ DRY SHOWING OIL
- ⊖ DRY SHOWING GAS
- ⊖ ABANDONED LOCATION
- ☀ ABANDONED GAS WELL
- ⬮ ABANDONED OIL WELL

NOTE: Below make tracing from map, (when no map is obtainable make sketch) showing farm, center of section, this location with measurements and also wells, dry holes, or other locations in the vicinity of this location.

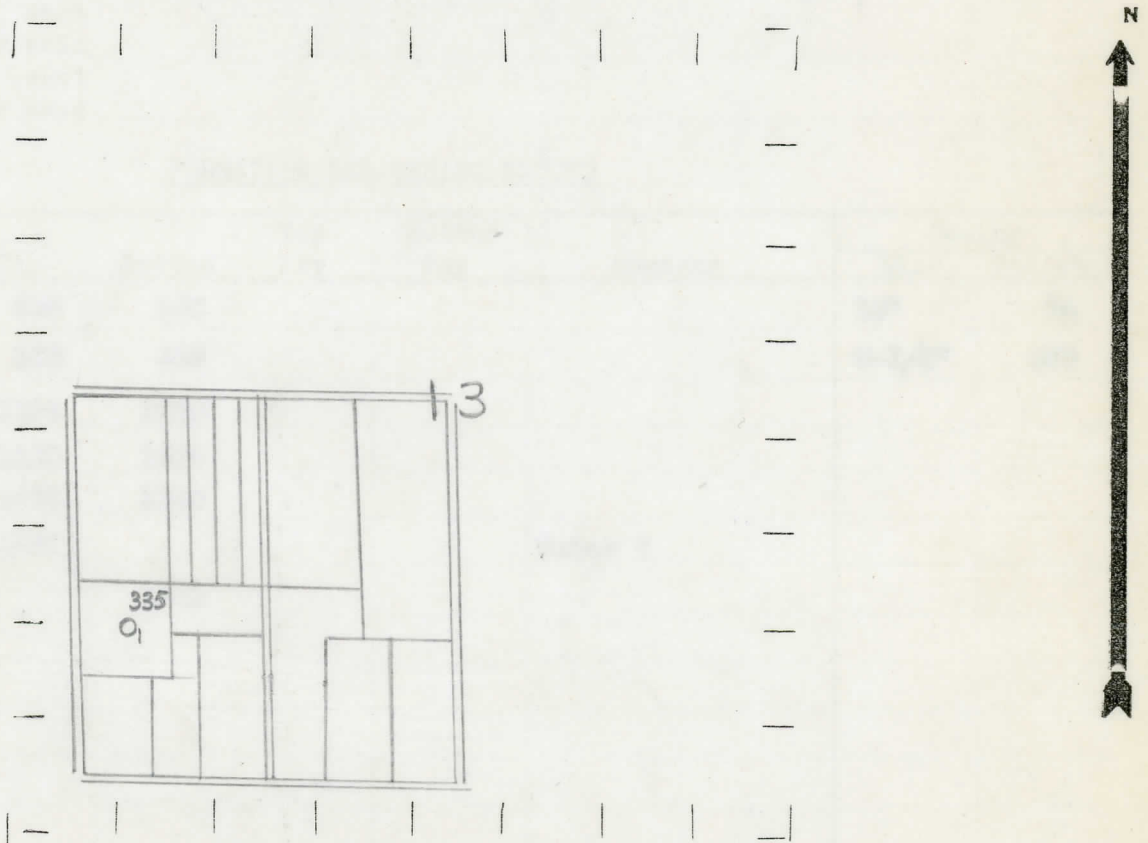

REMARKS:

SIGNED \_\_\_\_\_

Superintendent or Foreman.

COMPLETION RECORD OF WELLS DRILLED BY OTHER OPERATORS

Michigan Producing Division

Date January 10, 1940 No. 335  
 State Mich. County Kent ~~Dist.~~ Twp. Wyoming Sec. 13 Twp. 6 N Rge. 12 W  
 Well No. 1 (~~County No.~~) 335 Farm Miller, et al (Comm.) Acres  
 Operator Sprenger Brothers Information secured ~~from~~ Scouting Department  
 Date well started 11-27-39 Dated well completed 1-7-40 Elevation 689.1

PRODUCTION RECORD

1st 24 hours natural Dry Hole  
 2nd 24 hours natural  
 Date of shot No. of quarts From to From to  
 Date of acid No. of gallons  
 1st 24 hours after acid shot  
 2nd 24 hours after acid shot

FORMATION AND CASING RECORD

Formation	Top	Bottom	Top Pay	Bottom Pay	Remarks	Casing	
						Size	Set at
Marshall	205	300				10"	74
"	325	465				8-1/4"	535
Red Rock	1195	1200					
Berea	1200	1235					
Antrim	1615	1830					
Traverse Lime	1887				Water ?		
Total Depth		1933					

Remarks

Signed D. C. Shackelford