



Western Michigan University
ScholarWorks at WMU

Legacy Scout Tickets from Pure Oil Company

8-20-2021

MGRRE_PureOilScoutTickets_Bultema, J._2_21081070580000

MGRRE

Western Michigan University

Follow this and additional works at: <https://scholarworks.wmich.edu/pure>



Part of the Geology Commons

WMU ScholarWorks Citation

MGRRE, "MGRRE_PureOilScoutTickets_Bultema, J._2_21081070580000" (2021). *Legacy Scout Tickets from Pure Oil Company*. 4255.

<https://scholarworks.wmich.edu/pure/4255>

This Document is brought to you for free and open access via ScholarWorks at WMU. It has been accepted for inclusion in Legacy Scout Tickets from Pure Oil Company by an authorized administrator of ScholarWorks at WMU. See the National Digital Catalogue - Science Base Catalogue for more collections submitted by MGRRE.



MGRRE_PureOilScoutTickets_Bultema, J._2_21081070580000

API 21081070580000

Permit Number 7058

Lease Name Bultema, J.

Well Number 2

County Kent

Township 07N

Range 12W

Section 29

2021 DEQ or Pure co_name Fisher McCall Oil and Gas, Incorporated and Sackner, W. E.

Pure Number 377

Latitude 42.97024

Longitude -85.75729

THE PURE OIL COMPANY

DATE November 22, 1939

LOCATION REPORT

No. 377

STATE Michigan

COUNTY Kent

DIST Walker

SEC. 29

TOWN 7 N

RANGE 12 W

WELL No. 2 (SERIAL No. 377) FARM

PRECX Bultema

ACRES

NAME OF STREAM OR WATERS

QUADRANGLE NE-NE-NW
NE NE NW

OPERATOR Fisher-McCall Oil & Gas, Inc., et al

Map

Walker Township, Kent County

6600

Fisher, McCall Inc.

Walker-Kent

Feet from North Line of Farm

1999

" " East " " "

Low

" " South " " "

1799

" " West " " "

6660

Feet from North Line of Section

19199

" " East " 1/4 "

" " South " " "

" " West " " "

LEGEND

○ LOCATION

⊙ DRY HOLE

⊕ RIG

⊙ DRY SHOWING OIL

⊕ DRILLING

⊙ DRY SHOWING GAS

⊙ GAS WELL

⊙ ABANDONED LOCATION

⊙ OIL WELL

⊙ ABANDONED GAS WELL

⊙ SMALL OIL WELL

⊙ ABANDONED OIL WELL

NOTE: Below make tracing from map. (when no map is obtainable make sketch) showing farm, center of section, this location with measurements and also wells, dry holes, or other locations in the vicinity of this location.

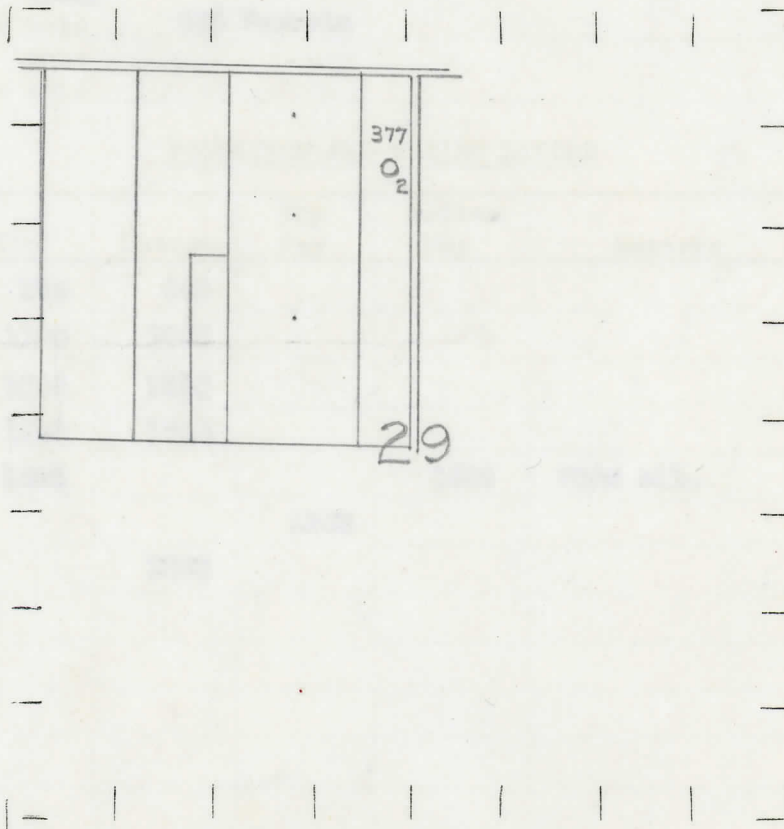

REMARKS:

SIGNED

Superintendent or Foreman.

990-N
300-E

COMPLETION RECORD OF WELLS DRILLED BY OTHER OPERATORS

Michigan Producing Division

Date **December 28, 1939** No. **377**
 State **Mich.** County **Kent** ~~Dist.~~ Twp. **Walker** Sec. **29** Twp. **7 N** Rge. **12 W**
 Well No. **2** (~~County No.~~) **377** Farm **Bultona** Acres _____
 Operator **Fisher-McCall, et al** Information secured ~~from~~ **By Scouting Department**
 Date well started **12-4-39** Dated well completed **12-14-39** Elevation **722.1**

PRODUCTION RECORD

12
 1st ~~24~~ hours natural **Filled up 700 ft.**
 2nd 24 hours natural _____
 Date of shot _____ No. of quarts _____ From _____ to _____ From _____ to _____
 Date of acid **12-18-39** No. of gallons **2000**
 1st 24 hours after acid, ~~shot~~ **150 Barrels**
 shot
 2nd 24 hours after acid _____

FORMATION AND CASING RECORD

Formation	Top	Bottom	Top Pay	Bottom Pay	Remarks	Casing	
						Size	Set at
Marshall	184	440				8-5/8"	491
Red Rock	1190	1205				5-3/16"	1885
Berea	1205	1250					
Antrim	1690	1845					
Traverse Lime	1885			1886	Show oil.		
Total Depth		1898					

Remarks _____

Signed **D. C. Shackelford**