



Western Michigan University  
ScholarWorks at WMU

---

Legacy Scout Tickets from Pure Oil Company

---

8-20-2021

## MGRRE\_PureOilScoutTickets\_Alabastine Company\_2\_21081070870000

MGRRE

*Western Michigan University*

Follow this and additional works at: <https://scholarworks.wmich.edu/pure>



Part of the Geology Commons

---

### WMU ScholarWorks Citation

MGRRE, "MGRRE\_PureOilScoutTickets\_Alabastine Company\_2\_21081070870000" (2021). *Legacy Scout Tickets from Pure Oil Company*. 4265.

<https://scholarworks.wmich.edu/pure/4265>

This Document is brought to you for free and open access via ScholarWorks at WMU. It has been accepted for inclusion in Legacy Scout Tickets from Pure Oil Company by an authorized administrator of ScholarWorks at WMU. See the National Digital Catalogue - Science Base Catalogue for more collections submitted by MGRRE.



---

**MGRRE\_PureOilScoutTickets\_Alabastine Company\_2\_21081070870000**

API 21081070870000

Permit Number 7087

Lease Name Alabastine Company

Well Number 2

County Kent

Township 06N

Range 12W

Section 2

2021 DEQ or Pure co\_name Hogan Brothers

Pure Number 387

Latitude 42.93897

Longitude -85.70273

THE PURE OIL COMPANY  
 LOCATION REPORT

DATE November 29, 1939

No. 387

STATE Michigan COUNTY Kent DISTRICT Wyoming SEC. 22 TOWN 6 N RANGE 12 W  
 WELL No. 2 (SERIAL No. 387) FARM Alabastine Company ACRES \_\_\_\_\_

NAME OF STREAM OR WATERS \_\_\_\_\_ QUADRANGLE SE NW NW

OPERATOR Hogan Brothers Map Wyoming Township, Kent County  
Hogan Bros. Wyoming, Kent

Feet from North Line of Farm  
44449 " " East " " "  
330330 " " South " " "  
 " " West " " "  
1093093 Feet from North Line of Section  
 " " East " " "  
 " " South " " "  
990990 " " West " " "

- LEGEND**
- LOCATION
  - ⊕ DRILLING
  - ☀ GAS WELL
  - OIL WELL
  - ⊙ SMALL OIL WELL
  - ⊖ DRY HOLE
  - ⊙ DRY SHOWING OIL
  - ⊙ DRY SHOWING GAS
  - ⊖ ABANDONED LOCATION
  - ☀ ABANDONED GAS WELL
  - ⊙ ABANDONED OIL WELL

NOTE: Below make tracing from map, (when no map is obtainable make sketch) showing farm, center of section, this location with measurements and also wells, dry holes, or other locations in the vicinity of this location.

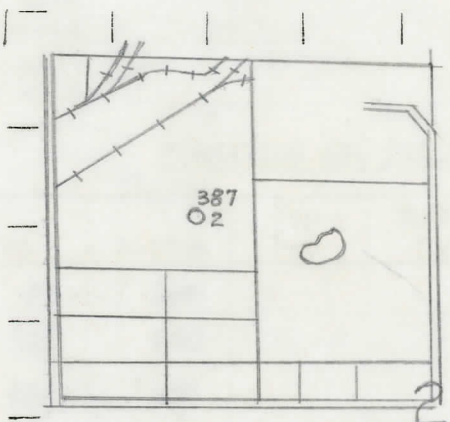

REMARKS: \_\_\_\_\_  
 \_\_\_\_\_  
 \_\_\_\_\_

SIGNED \_\_\_\_\_  
 Superintendent or Foreman.

Michigan Producing Division

Date December 28, 1939 No. 387  
 State Mich. County Kent ~~Dist.~~ Twp. Wyoming Sec. 2 Twp. 6 N Rge. 12 W  
 Well No. 2 (~~Serial No.~~) 387 Farm Alabastine Co. Acres \_\_\_\_\_  
 Operator Hogan Brothers Information secured ~~from~~ By Scouting Department  
 Date well started 11-30-39 Dated well completed 12-16-39 Elevation 608.4

PRODUCTION RECORD

1st 24 hours natural Dry Hole  
 2nd 24 hours natural \_\_\_\_\_  
 Date of shot \_\_\_\_\_ No. of quarts \_\_\_\_\_ From \_\_\_\_\_ to \_\_\_\_\_ From \_\_\_\_\_ to \_\_\_\_\_  
 Date of acid \_\_\_\_\_ No. of gallons \_\_\_\_\_  
 1st 24 hours after acid shot \_\_\_\_\_  
 2nd 24 hours after acid shot \_\_\_\_\_

FORMATION AND CASING RECORD

Formation	Top	Bottom	Top Pay	Bottom Pay	Remarks	Casing	
						Size	Set at
Marshall	94	195				10"	25
"	225	280				8-1/4"	85
"	283	362				6-5/8"	366
Coldwater Lime	640	645				5-3/16"	1747
Red Rock	1092	1109					
Berea	1109	1135		1127	Show oil & water.		
Antrim	1575	1713	S.L.M.				
Traverse Lime	1773			1775	Small show oil.		
				1791	Small show oil.		
			1839	1842	Water-130 ft.		
Total Depth		1842					

Remarks \_\_\_\_\_  
 \_\_\_\_\_  
 \_\_\_\_\_

Signed D. C. Shackelford