



Western Michigan University
ScholarWorks at WMU

Legacy Scout Tickets from Pure Oil Company

8-20-2021

MGRRE_PureOilScoutTickets_Lincoln Country Club_1_21081072680000

MGRRE

Western Michigan University

Follow this and additional works at: <https://scholarworks.wmich.edu/pure>



Part of the Geology Commons

WMU ScholarWorks Citation

MGRRE, "MGRRE_PureOilScoutTickets_Lincoln Country Club_1_21081072680000" (2021). *Legacy Scout Tickets from Pure Oil Company*. 4302.

<https://scholarworks.wmich.edu/pure/4302>

This Document is brought to you for free and open access via ScholarWorks at WMU. It has been accepted for inclusion in Legacy Scout Tickets from Pure Oil Company by an authorized administrator of ScholarWorks at WMU. See the National Digital Catalogue - Science Base Catalogue for more collections submitted by MGRRE.



MGRRE_PureOilScoutTickets_Lincoln Country Club_1_21081072680000

API 21081072680000

Permit Number 7268

Lease Name Lincoln Country Club

Well Number 1

County Kent

Township 07N

Range 12W

Section 20

2021 DEQ or Pure co_name Twin Drilling Company

Pure Number 424

Latitude 42.9785

Longitude -85.76042

THE PURE OIL COMPANY

DATE January 24, 1940

LOCATION REPORT

No. 424

STATE Michigan

COUNTY Kent

DIST. Walker

TWP. Walker

SEC. 20

TOWN. 7 N

7 N

12 W

WELL No. 1 (SERIAL No. 424) FARM

Lincoln Country Club

ACRES

NAME OF STREAM OR WATERS

QUADRANGLE

NW-NE-SW

OPERATOR Twin Drilling Company

Map Walker Township, Kent County

Walker - Kent

33330 Feet from North Line of Farm

32330 " " East " " "

" " South " " "

33330 " " West " " "

33330 Feet from North Line of Section

9990 " " East 1/4 " "

" " South " " "

" " West " " "

LEGEND

○ LOCATION

⊙ RIG

⊕ DRILLING

☀ GAS WELL

● OIL WELL

⦿ SMALL OIL WELL

⊖ DRY HOLE

⦿ DRY SHOWING OIL

☀ DRY SHOWING GAS

⊖ ABANDONED LOCATION

☀ ABANDONED GAS WELL

⦿ ABANDONED OIL WELL

NOTE: Below make tracing from map, (when no map is obtainable make sketch) showing farm, center of section, this location with measurements and also wells, dry holes, or other locations in the vicinity of this location.

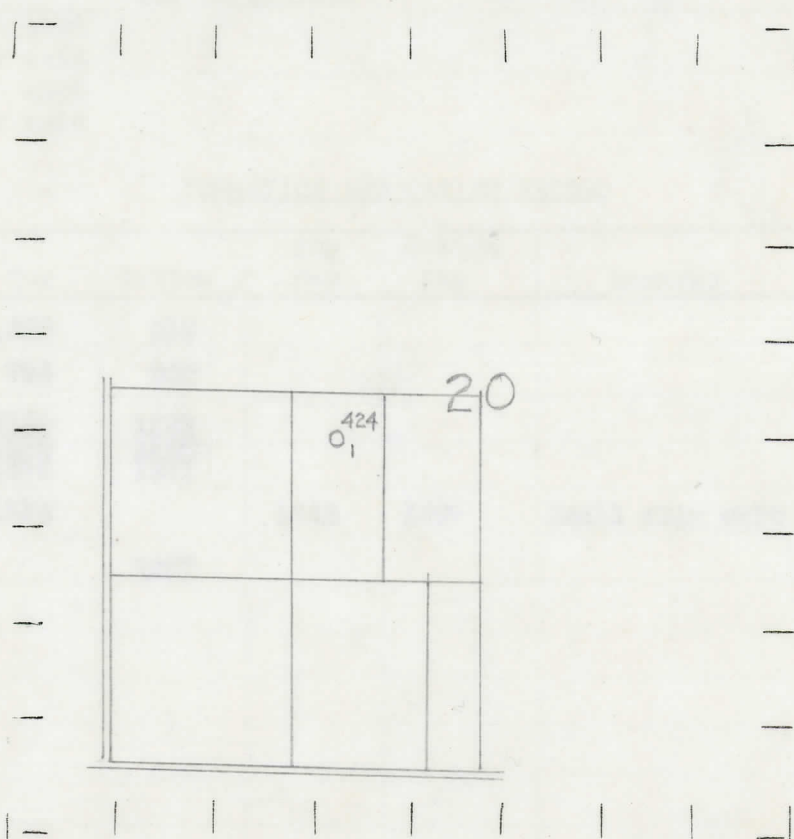

REMARKS:

SIGNED

Superintendent or Foreman.

