



Western Michigan University
ScholarWorks at WMU

Legacy Scout Tickets from Pure Oil Company

8-20-2021

MGRRE_PureOilScoutTickets_Story, L. M._3_21081073160000

MGRRE

Western Michigan University

Follow this and additional works at: <https://scholarworks.wmich.edu/pure>



Part of the Geology Commons

WMU ScholarWorks Citation

MGRRE, "MGRRE_PureOilScoutTickets_Story, L. M._3_21081073160000" (2021). *Legacy Scout Tickets from Pure Oil Company*. 4308.

<https://scholarworks.wmich.edu/pure/4308>

This Document is brought to you for free and open access via ScholarWorks at WMU. It has been accepted for inclusion in Legacy Scout Tickets from Pure Oil Company by an authorized administrator of ScholarWorks at WMU. See the National Digital Catalogue - Science Base Catalogue for more collections submitted by MGRRE.



MGRRE_PureOilScoutTickets_Story, L. M._3_21081073160000

API 21081073160000

Permit Number 7316

Lease Name Story, L. M.

Well Number 3

County Kent

Township 07N

Range 12W

Section 32

2021 DEQ or Pure co_name Voorhees Drilling Company

Pure Number 430

Latitude 42.94403

Longitude -85.76493

THE PURE OIL COMPANY

DATE February 7, 1940

LOCATION REPORT

No. 430

STATE Michigan COUNTY Kent DIST Walker TWP. Walker SEC. 32 TOWN 7 N RANGE 12 W

WELL No. 33 (SERIAL No. 430) FARM PREC. L. M. Story ACRES

NAME OF STREAM OR WATERS QUADRANGLE SW SW SW

OPERATOR Voorhees Drilling Company Map Walker Township, Kent County

Feet from North Line of Farm

33 330 East " " "
33 330 South " " "
33 330 West " " "

Feet from North Line of Section

33 330 East " " "
33 330 South " " "
33 330 West " " "

- LEGEND
O LOCATION
D RIG
+ DRILLING
* GAS WELL
● OIL WELL
● SMALL OIL WELL
○ DRY HOLE
● DRY SHOWING OIL
○ DRY SHOWING GAS
○ ABANDONED LOCATION
* ABANDONED GAS WELL
● ABANDONED OIL WELL

NOTE: Below make tracing from map, (when no map is obtainable make sketch) showing farm, center of section, this location with measurements and also wells, dry holes, or other locations in the vicinity of this location.

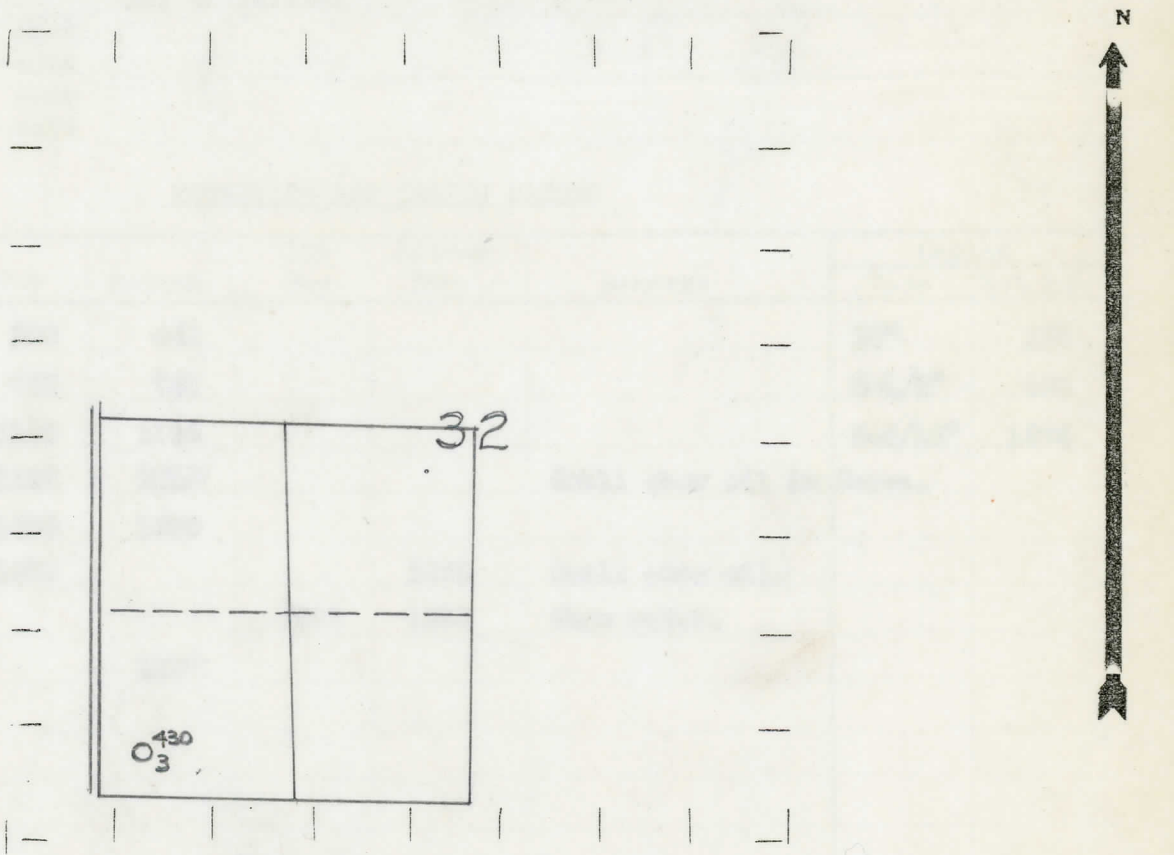

REMARKS:

SIGNED

Superintendent or Foreman.

COMPLETION RECORD OF WELLS DRILLED BY OTHER OPERATORS

Michigan Producing Division

Date March 6, 1940 No. 430
 State Mich. County Kent Dist. Walker Twp. Walker Sec. 32 Twp. 7 N Rge. 12 W
 Well No. 3 (Serial No.) 430 Farm L. M. Story Acres _____
 Operator Voorhees Drilling Company Information secured ~~from~~ Scouting Department
 Date well started 2-8-40 Dated well completed 2-28-40 Elevation 715.7

PRODUCTION RECORD

1st 24 hours natural Dry Hole
 2nd 24 hours natural _____
 Date of shot _____ No. of quarts _____ From _____ to _____ From _____ to _____
 Date of acid _____ No. of gallons _____
 1st 24 hours after acid shot _____
 2nd 24 hours after acid shot _____

FORMATION AND CASING RECORD

Formation	Top	Bottom	Top Pay	Bottom Pay	Remarks	Casing	
						Size	Set at
Marshall	200	441				10"	132
Coldwater Lime	733	742				8-1/4"	460
Red Rock	1152	1188				5-3/16"	1874
Berea	1198	1218			Small show oil in Berea.		
Antrim	1530	1830					
Traverse Lime	1874			1875	Small show oil.		
			1892	1898	Show water.		
Total Depth		1927					

Remarks _____

Signed D. C. Shackelford