



Western Michigan University
ScholarWorks at WMU

Legacy Scout Tickets from Pure Oil Company

8-20-2021

MGRRE_PureOilScoutTickets_Edison, Harold_1_21081074560000

MGRRE

Western Michigan University

Follow this and additional works at: <https://scholarworks.wmich.edu/pure>



Part of the Geology Commons

WMU ScholarWorks Citation

MGRRE, "MGRRE_PureOilScoutTickets_Edison, Harold_1_21081074560000" (2021). *Legacy Scout Tickets from Pure Oil Company*. 4333.

<https://scholarworks.wmich.edu/pure/4333>

This Document is brought to you for free and open access via ScholarWorks at WMU. It has been accepted for inclusion in Legacy Scout Tickets from Pure Oil Company by an authorized administrator of ScholarWorks at WMU. See the National Digital Catalogue - Science Base Catalogue for more collections submitted by MGRRE.



MGRRE_PureOilScoutTickets_Edison, Harold_1_21081074560000

API 21081074560000

Permit Number 7456

Lease Name Edison, Harold

Well Number 1

County Kent

Township 07N

Range 12W

Section 27

2021 DEQ or Pure co_name Rose, Louis

Pure Number 455

Latitude 42.96855

Longitude -85.70871

THE PURE OIL COMPANY

LOCATION REPORT

DATE March 20, 1940

No. 455

STATE Michigan COUNTY Kent DIST. Walker TWP. Walker SEC. 27 TOWN 7 N RANGE 12 W

WELL No. 1 (SERIAL No. 455) FARM Harold Edison ACRES

NAME OF STREAM OR WATERS QUADRANGLE SE-NE NW-E-NW

OPERATOR Louis Rose Map Walker Township, Kent County

990 Feet from North Line of Farm

418 " " East " " "

" " South " " "

" " West " " "

990 Feet from North Line of Section

418 " " East " " "

" " South " " "

" " West " " "

LEGEND

- LOCATION
- ⊕ RIG
- ⊕ DRILLING
- ☀ GAS WELL
- OIL WELL
- ◆ SMALL OIL WELL
- ⊖ DRY HOLE
- DRY SHOWING OIL
- ⊖ DRY SHOWING GAS
- ⊖ ABANDONED LOCATION
- ☀ ABANDONED GAS WELL
- ABANDONED OIL WELL

NOTE: Below make tracing from map, (when no map is obtainable make sketch) showing farm, center of section, this location with measurements and also wells, dry holes, or other locations in the vicinity of this location.

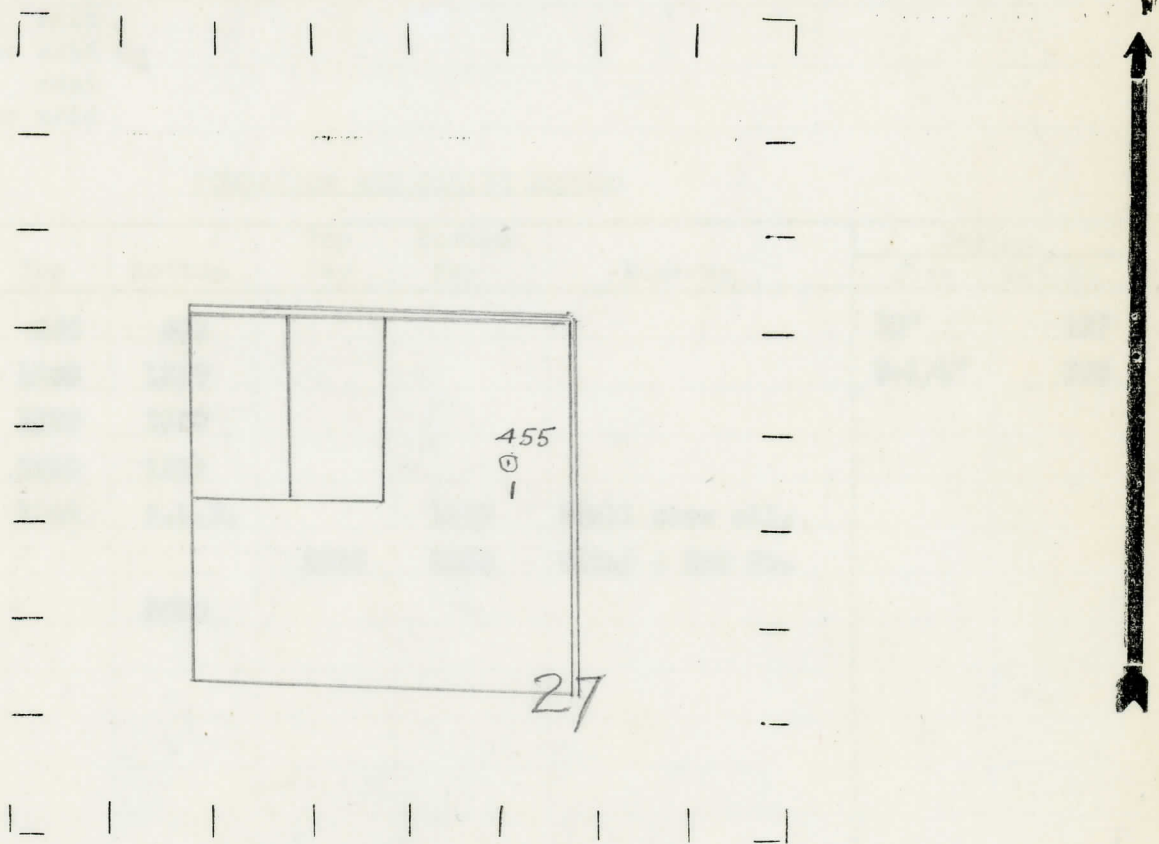

REMARKS:

SIGNED

[Signature]

Superintendent or Foreman.

COMPLETION RECORD OF WELLS DRILLED BY OTHER OPERATORS

Michigan Producing Division

Date April 10, 1940 No. 455
 State Mich. County Kent ~~Dist.~~ Walker Twp. 27 Sec. 7 N Rge. 12 W
 (Serial No.)
 Well No. 1 (~~Scout No.~~) 455 Farm Harold Edison Acres _____
 Operator Louis Rose Information secured from ~~Scout~~ Scouting Department By _____
 Date well started 3-19-40 Dated well completed 4-7-40 Elevation 758.2

PRODUCTION RECORD

1st 24 hours natural Dry Hole
 2nd 24 hours natural _____
 Date of shot _____ No. of quarts _____ From _____ to _____ From _____ to _____
 Date of acid _____ No. of gallons _____
 1st 24 hours after acid shot _____
 2nd 24 hours after acid shot _____

FORMATION AND CASING RECORD

Formation	Top	Bottom	Top Pay	Bottom Pay	Remarks	Casing	
						Size	Set at
Marshall	265	508				10"	127
Red Rock	1265	1280				8-1/4"	555
Berea	1280	1500					
Antrim	1715	1892					
Traverse Lime	1942	S.L.M.		1945	Small show oil.		
			2025	2030	Water - 200 ft.		
Total Depth		2030					

Remarks _____

Signed D. C. Shackelford