



Western Michigan University  
ScholarWorks at WMU

---

Legacy Scout Tickets from Pure Oil Company

---

8-20-2021

## MGRRE\_PureOilScoutTickets\_Gard et al\_1\_na

MGRRE

*Western Michigan University*

Follow this and additional works at: <https://scholarworks.wmich.edu/pure>



Part of the Geology Commons

---

### WMU ScholarWorks Citation

MGRRE, "MGRRE\_PureOilScoutTickets\_Gard et al\_1\_na" (2021). *Legacy Scout Tickets from Pure Oil Company*. 4334.

<https://scholarworks.wmich.edu/pure/4334>

This Document is brought to you for free and open access via ScholarWorks at WMU. It has been accepted for inclusion in Legacy Scout Tickets from Pure Oil Company by an authorized administrator of ScholarWorks at WMU. See the National Digital Catalogue - Science Base Catalogue for more collections submitted by MGRRE.



---

MGRRE\_PureOilScoutTickets\_Gard et al\_1\_na

API na

Permit Number na

Lease Name Gard et al

Well Number 1

County Kent

Township 06N

Range 12W

Section 14

2021 DEQ or Pure co\_name Michigan Devonian Petroleum Company

Pure Number 456

Latitude 42.9061096

Longitude -85.6951805

THE PURE OIL COMPANY

DATE March 20, 1940

LOCATION REPORT

No. 456

STATE Michigan COUNTY Kent DIST. Wyoming TWP. Wyoming SEC. 14 TOWN 6 N RANGE 12 W

WELL No. 1 (SERIAL No. 456) FARM Gard, et al. ACRES

NAME OF STREAM OR WATERS \_\_\_\_\_ QUADRANGLE SW SW SE

OPERATOR Mich. Devonian Petroleum Company Map Wyoming Township, Kent County

Feet from North Line of Farm

“ “ East “ “ “

200 200 “ “ South “ “ “

290 290 “ “ West “ “ “

Feet from North Line of Section

“ “ East “ “ “

200 200 “ “ South “ 1/4 “

620 620 “ “ West “ “ “

LEGEND

- LOCATION
- ⊕ RIG
- ⊕ DRILLING
- ☀ GAS WELL
- OIL WELL
- SMALL OIL WELL
- ⊖ DRY HOLE
- ◆ DRY SHOWING OIL
- ☀ DRY SHOWING GAS
- ⊖ ABANDONED LOCATION
- ☀ ABANDONED GAS WELL
- ABANDONED OIL WELL

NOTE: Below make tracing from map, (when no map is obtainable make sketch) showing farm, center of section, this location with measurements and also wells, dry holes, or other locations in the vicinity of this location.

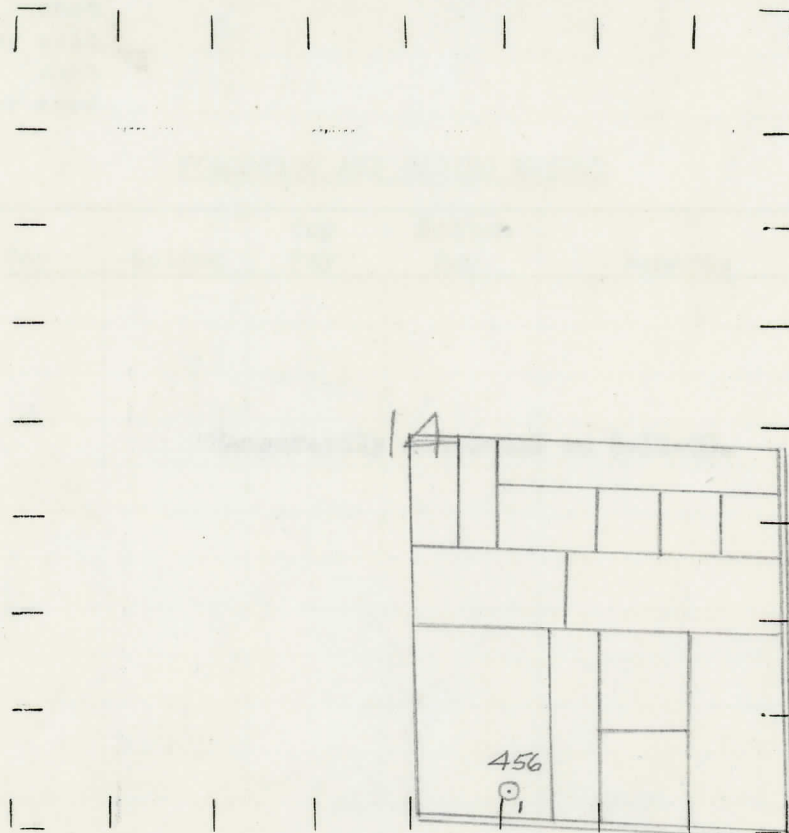

REMARKS:

SIGNED

*W*

Superintendent or Foreman.

COMPLETION RECORD OF WELLS DRILLED BY OTHER OPERATORS

Michigan Producing Division

Date **May 15, 1940** No. **456**  
 State **Mich.** County **Kent** Dist. **Wyoming** Twp. **6 N** Sec. **14** Rge. **12 W**  
 Well No. **1** (Serial No.) **456** Farm **Gard, et al** Acres \_\_\_\_\_  
 Operator **Mich. Devonian Petroleum Co.** Information secured ~~from~~ **Scouting Department**  
 Date well started **Not started.** Dated well completed **Not completed.** Elevation \_\_\_\_\_

PRODUCTION RECORD

1st 24 hours natural **Temporarily abandoned.**  
 2nd 24 hours natural \_\_\_\_\_  
 Date of shot \_\_\_\_\_ No. of quarts \_\_\_\_\_ From \_\_\_\_\_ to \_\_\_\_\_ From \_\_\_\_\_ to \_\_\_\_\_  
 Date of acid \_\_\_\_\_ No. of gallons \_\_\_\_\_  
 1st 24 hours after acid shot \_\_\_\_\_  
 2nd 24 hours after acid shot \_\_\_\_\_

FORMATION AND CASING RECORD

Formation	Top	Bottom	Top Pay	Bottom Pay	Remarks	Casing	
						Size	Set at
Marshall	100	130				10"	130
"	130	150				8 1/2"	150
Red Bed	150	170				8 1/2"	170
Barren	170	180			<b>Temporarily abandoned on 5-13-40.</b>		
Andria	180	190					
Andria (cont.)	190	200					
Andria (cont.)	200	210					
Andria (cont.)	210	220					
Andria (cont.)	220	230					
Andria (cont.)	230	240					
Andria (cont.)	240	250					
Andria (cont.)	250	260					
Andria (cont.)	260	270					
Andria (cont.)	270	280					
Andria (cont.)	280	290					
Andria (cont.)	290	300					

Remarks \_\_\_\_\_  
 \_\_\_\_\_  
 \_\_\_\_\_

Signed **D. C. Shackelford**