



Western Michigan University  
ScholarWorks at WMU

---

Legacy Scout Tickets from Pure Oil Company

---

8-20-2021

**MGRRE\_PureOilScoutTickets\_Cudahy, J\_A-1\_21081075580000**

MGRRE

*Western Michigan University*

Follow this and additional works at: <https://scholarworks.wmich.edu/pure>



Part of the Geology Commons

---

#### **WMU ScholarWorks Citation**

MGRRE, "MGRRE\_PureOilScoutTickets\_Cudahy, J\_A-1\_21081075580000" (2021). *Legacy Scout Tickets from Pure Oil Company*. 4352.

<https://scholarworks.wmich.edu/pure/4352>

This Document is brought to you for free and open access via ScholarWorks at WMU. It has been accepted for inclusion in Legacy Scout Tickets from Pure Oil Company by an authorized administrator of ScholarWorks at WMU. See the National Digital Catalogue - Science Base Catalogue for more collections submitted by MGRRE.



---

**MGRRE\_PureOilScoutTickets\_Cudahy, J\_A-1\_21081075580000**

API 21081075580000

Permit Number 7558

Lease Name Cudahy, J

Well Number A-1

County Kent

Township 07N

Range 12W

Section 33

2021 DEQ or Pure co\_name Christian Oil Company

Pure Number 474

Latitude 42.9508098

Longitude -85.7330686

THE PURE OIL COMPANY

LOCATION REPORT

No. ~~474~~

DATE April 24, 1940

STATE Michigan COUNTY Kent DIST. Walker TWP. Walker SEC. 33 TOWN 7 N RANGE 12 W  
WELL No. A-1 (SERIAL No. 474) FARM PREC. J. Cuddihy ACRES

NAME OF STREAM OR WATERS QUADRANGLE SE SW NE

OPERATOR Welsh Oil Company Map Walker Township, Kent County

Welsh Oil Co

Walker - Kent

Feet from North Line of Farm

330 330 " " East " " "

330 330 " " South " " "

" " West " " "

Feet from North Line of Section

" " East " " "

330 330 " " South " 1/4 "

990 990 " " West " " "

re 495  
sp 4-19-40  
10' 188  
manhole  
240-360;  
380-?

LEGEND

○ LOCATION

⊕ RIG

⊕ DRILLING

☀ GAS WELL

● OIL WELL

● SMALL OIL WELL

○ DRY HOLE

● DRY SHOWING OIL

☀ DRY SHOWING GAS

○ ABANDONED LOCATION

☀ ABANDONED GAS WELL

● ABANDONED OIL WELL

NOTE: Below make tracing from map. (when no map is obtainable make sketch) showing farm, center of section, this location with measurements and also wells, dry holes, or other locations in the vicinity of this location.

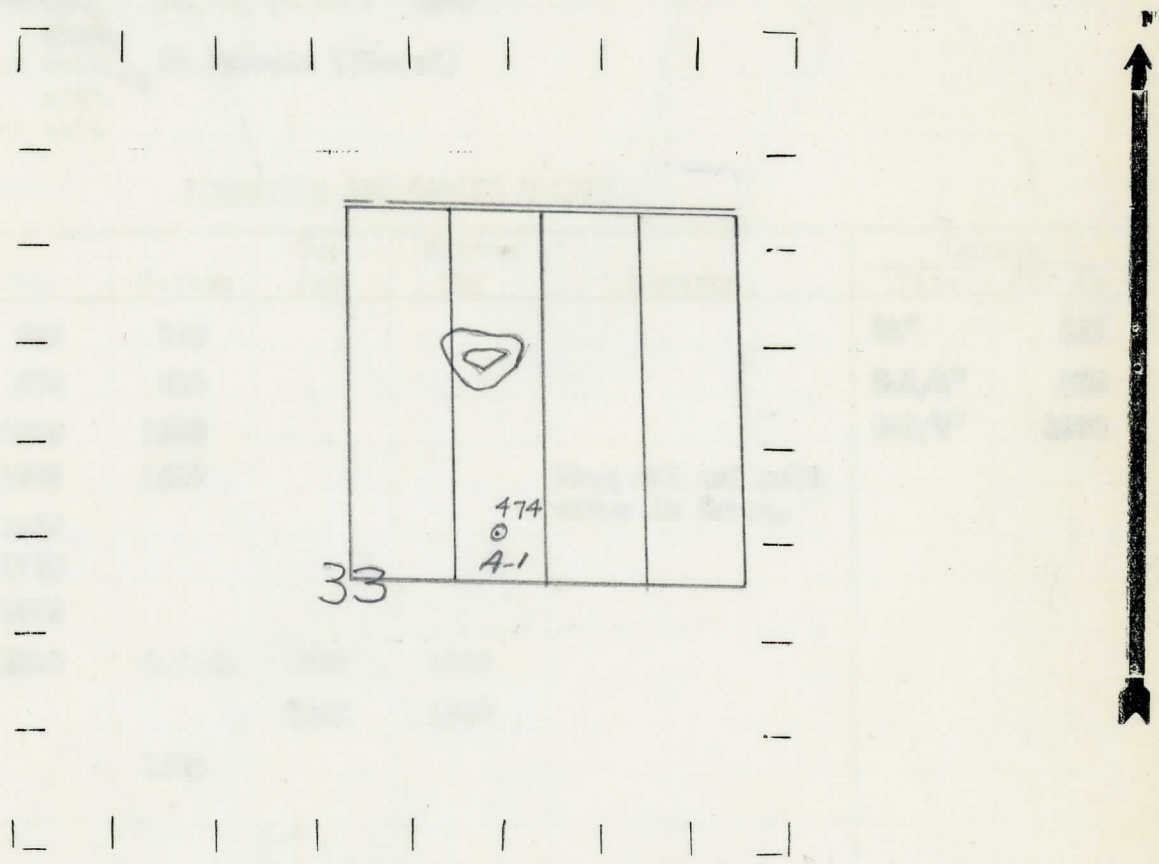

REMARKS:

SIGNED

W

Superintendent or Foreman.

Michigan Producing Division

Date May 15, 1940 No. 474  
 State Mich. County Kent Dist. Walker Sec. 33 Twp. 7 N Rge. 12 W  
 Well No. A-1 (Serial No.) 474 Farm J. Cuddihy Acres \_\_\_\_\_  
 Operator Welsh Oil Company Information secured Scouting Department  
 Date well started 4-19-40 Dated well completed 5-7-40 Elevation 764.2

PRODUCTION RECORD

1st 24 hours natural Filled up 300 ft.  
 2nd 24 hours natural \_\_\_\_\_  
 Date of shot \_\_\_\_\_ No. of quarts \_\_\_\_\_ From \_\_\_\_\_ to \_\_\_\_\_  
 Date of acid 5-9-40 No. of gallons 1000  
 1st 24 hours after ~~shot~~ 50 Barrels (Flowed)  
 2nd 24 hours after acid \_\_\_\_\_

FORMATION AND CASING RECORD

Formation	Top	Bottom	Top Pay	Bottom Pay	Remarks	Casing	
						Size	Set at
Marshall	240	360				10"	168
"	380	515				8-1/4"	530
Red Rock	1232	1246				6-5/8"	1920
Berea	1253	1290			Show oil and salt water in Berea.		
Antrim (light)	1685						
Antrim (dark)	1750						
Traverse Form.	1875						
Traverse Lime	1920	C.T.M.	1930	1935			
			1945	1949			
Total Depth		1949					

Remarks \_\_\_\_\_

Signed D. C. Shackelford