



Western Michigan University
ScholarWorks at WMU

Legacy Scout Tickets from Pure Oil Company

8-20-2021

**MGRRE_PureOilScoutTickets_Livingston, John &
Nellie_3_21081076600000**

MGRRE

Western Michigan University

Follow this and additional works at: <https://scholarworks.wmich.edu/pure>



Part of the Geology Commons

WMU ScholarWorks Citation

MGRRE, "MGRRE_PureOilScoutTickets_Livingston, John & Nellie_3_21081076600000" (2021). *Legacy Scout Tickets from Pure Oil Company*. 4364.
<https://scholarworks.wmich.edu/pure/4364>

This Document is brought to you for free and open access via ScholarWorks at WMU. It has been accepted for inclusion in Legacy Scout Tickets from Pure Oil Company by an authorized administrator of ScholarWorks at WMU. See the National Digital Catalogue - Science Base Catalogue for more collections submitted by MGRRE.



MGRRE_PureOilScoutTickets_Livingston, John & Nellie_3_21081076600000

API 21081076600000

Permit Number 7660

Lease Name Livingston, John & Nellie

Well Number 3

County Kent

Township 07N

Range 12W

Section 32

2021 DEQ or Pure co_name Goodale Enterprises LLC

Pure Number 486

Latitude 42.9474401

Longitude -85.7502229

THE PURE OIL COMPANY

DATE May 15, 1940

LOCATION REPORT

No. 480

STATE Michigan COUNTY Kent DIST. Walker TWP. Walker SEC. 32 TOWN TW RANGE 12 W

WELL No. 3 (SERIAL No. 486) FARM John and Nellie Livingston ACRES

NAME OF STREAM OR WATERS QUADRANGLE SW NE SE - SE

OPERATOR Smith Petroleum Company Map Walker Township, Kent County

990 990 Smith Petroleum Co
Feet from North Line of Farm

250 250 " " East " " "

" " South " " "

250 250 " " West " " "

990 990 Feet from North Line of Section

1070 1070 " " East " " "

" " South " " "

" " West " " "

LEGEND

- LOCATION
- ⊕ RIG
- ⊕ DRILLING
- ☀ GAS WELL
- OIL WELL
- SMALL OIL WELL
- ⊖ DRY HOLE
- ◆ DRY SHOWING OIL
- ⊖ DRY SHOWING GAS
- ⊖ ABANDONED LOCATION
- ☀ ABANDONED GAS WELL
- ABANDONED OIL WELL

NOTE: Below make tracing from map, (when no map is obtainable make sketch) showing farm, center of section, this location with measurements and also wells, dry holes, or other locations in the vicinity of this location.

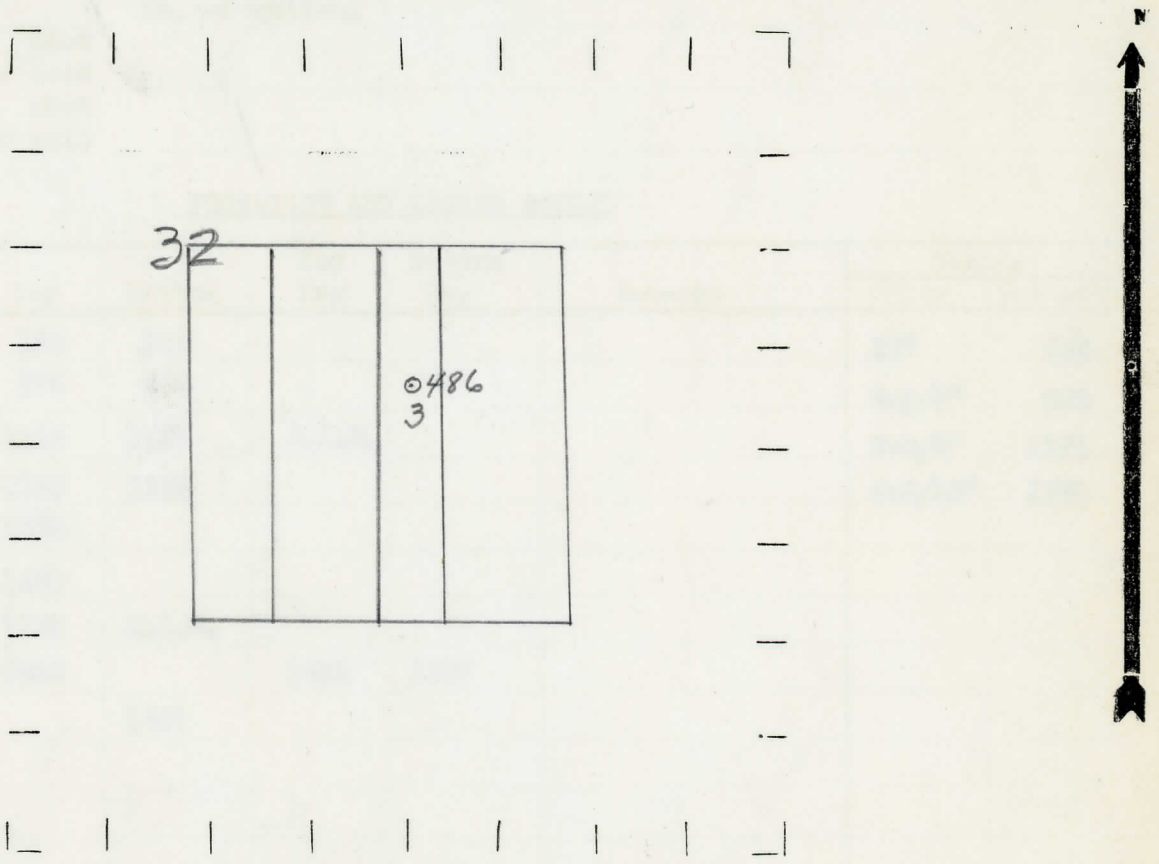

REMARKS:

SIGNED

W
Superintendent or Foreman.

COMPLETION RECORD OF WELLS DRILLED BY OTHER OPERATORS

Michigan Producing Division

Date **June 12, 1940** No. **486**
 State **Mich.** County **Kent** Dist. **Walker** Twp. **7 N** Rge. **12 W**
 Well No. **3** (Serial No.) **486** Farm **John Livingston** Acres
 Operator **Smith Petroleum Company** Information secured from **Scouting Department**
 Date well started **5-14-40** Dated well completed **6-5-40** Elevation **668.2**

PRODUCTION RECORD

1st 24 hours natural **1400 Barrels**
 2nd 24 hours natural
 Date of shot No. of quarts From to From to
 Date of acid No. of gallons
 1st 24 hours after acid shot
 2nd 24 hours after acid shot

FORMATION AND CASING RECORD

Formation	Top	Bottom	Top Pay	Bottom Pay	Remarks	Casing	
						Size	Set at
Marshall	148	250				10"	148
"	274	404				8-1/4"	460
Red Rock	1116	1131	S.L.M.			6-5/8"	1171
Berea	1140	1166				5-3/16"	1781
Antrim (light)	1605						
Antrim (dark)	1680						
Traverse Form.	1752	S.L.M.					
Traverse Line	1808		1829	1837			
Total Depth		1837					

Remarks **Gauged 2,160,000 cu. ft. gas and hole full of oil in the Berea; gas 1142' to 1146'; oil from 1146' to 1148'.**

Signed **D. C. Shackelford**