



Western Michigan University  
ScholarWorks at WMU

---

Legacy Scout Tickets from Pure Oil Company

---

8-20-2021

**MGRRE\_PureOilScoutTickets\_Thurkettle,  
Jane\_5\_21081081720000**

MGRRE  
*Western Michigan University*

Follow this and additional works at: <https://scholarworks.wmich.edu/pure>



Part of the Geology Commons

---

#### WMU ScholarWorks Citation

MGRRE, "MGRRE\_PureOilScoutTickets\_Thurkettle, Jane\_5\_21081081720000" (2021). *Legacy Scout Tickets from Pure Oil Company*. 4394.  
<https://scholarworks.wmich.edu/pure/4394>

This Document is brought to you for free and open access via ScholarWorks at WMU. It has been accepted for inclusion in Legacy Scout Tickets from Pure Oil Company by an authorized administrator of ScholarWorks at WMU. See the National Digital Catalogue - Science Base Catalogue for more collections submitted by MGRRE.



---

**MGRRE\_PureOilScoutTickets\_Thurkettle, Jane\_5\_21081081720000**

API 21081081720000

Permit Number 8172

Lease Name Thurkettle, Jane

Well Number 5

County Kent

Township 07N

Range 12W

Section 29

2021 DEQ or Pure co\_name Goodale Enterprises LLC

Pure Number 516

Latitude 42.9631059

Longitude -85.7589929

DATE November 6, 1940

LOCATION REPORT

No. 516 516

STATE Michigan COUNTY Kent DIST. Walker TWP. Walker SEC. 29 TOWN 7N RANGE 12W  
WELL No. 5 (SERIAL No. 516) FARM Joyce Thackerette ACRES

NAME OF STREAM OR WATERS \_\_\_\_\_ QUADRANGLE C-NE-SW

OPERATOR H. C. Williams Gordon Oil Co. 2-3-52 Map Walker - Kent

562 H. C. Williams 2-28-49 Walker - Kent  
Feet from North Line of Farm

660 " " East " " "

" " South " " "

" " West " " "

660 Feet from North Line of Section 1/4

660 " " East " " "

" " South " " "

" " West " " "

LEGEND

- LOCATION
- ⊕ RIG
- ⊕ DRILLING
- ☀ GAS WELL
- OIL WELL
- SMALL OIL WELL
- ⊖ DRY HOLE
- ◆ DRY SHOWING OIL
- ☀ DRY SHOWING GAS
- ⊖ ABANDONED LOCATION
- ☀ ABANDONED GAS WELL
- ABANDONED OIL WELL

NOTE: Below make tracing from map. (when no map is obtainable make sketch) showing farm, center of section, this location with measurements and also wells, dry holes, or other locations in the vicinity of this location.

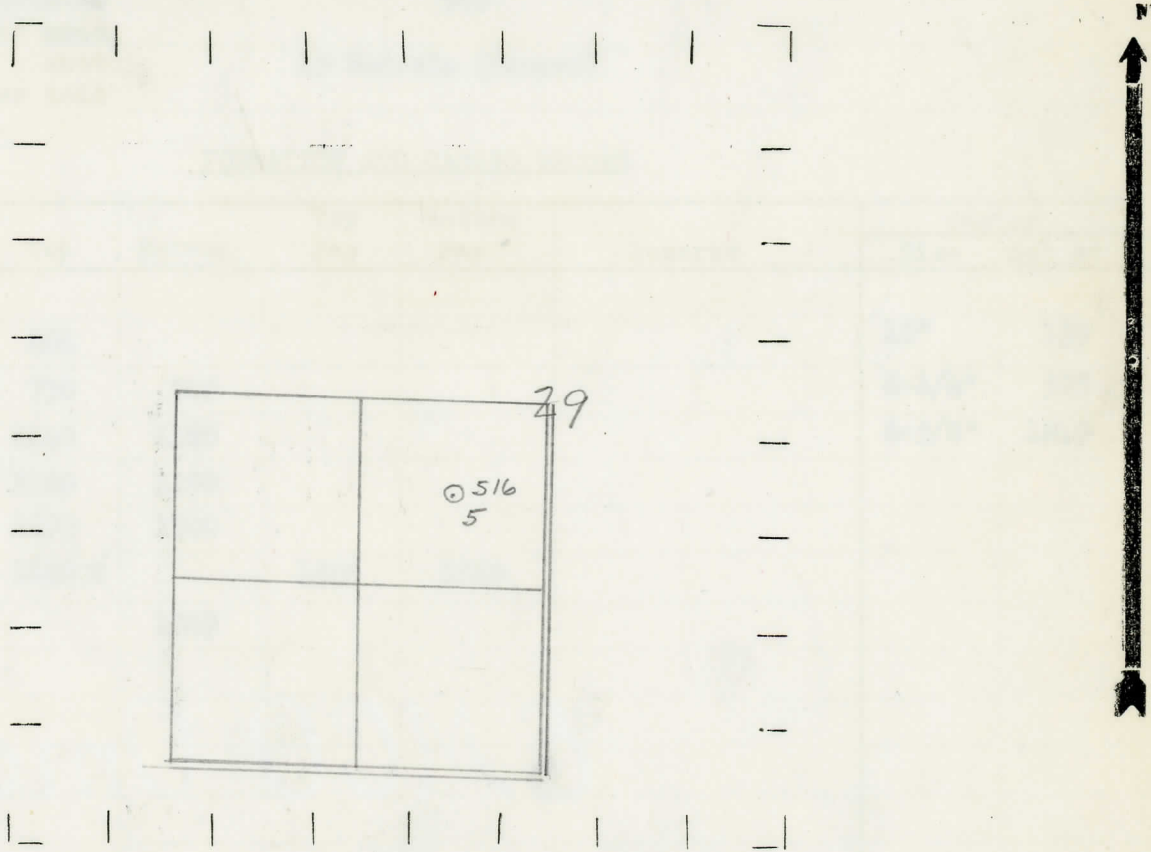

REMARKS:

\_\_\_\_\_  
\_\_\_\_\_  
\_\_\_\_\_

SIGNED

W

Superintendent or Foreman.

Division

**Michigan Producing**

Date December 4, 1940 No. 516  
 State Mich. County Kent Dist. Walker Sec. 29 Twp. 7 N Rge. 12 W  
 Well No. 5 (Serial No.) XXXXXXX Farm Jane Thurkettle Acres 516  
 Operator H. C. Williams Information secured from Scouting Department  
 Date well started 11-3-40 Dated well completed 11-17-40 Elevation 710.5

PRODUCTION RECORD

1st 24 hours natural Filled up 150 ft.  
 2nd 24 hours natural  
 Date of shot No. of quarts From to From to  
 Date of acid No. of gallons 500  
 1st 24 hours after ~~acid~~ shot 45 Barrels (Pumped)  
 2nd 24 hours after acid

FORMATION AND CASING RECORD

Formation	Top	Bottom	Top Pay	Bottom Pay	Remarks	Casing	
						Size	Set at
Marshall	204					10"	159
Coldwater Lime	730	740				8-1/4"	505
Red Rock	1140	1160				6-5/8"	1845
Berea	1160	1190					
Antrim	1600	1800					
Traverse Lime	1860 ?		1865	1869			
Total Depth		1869					

Remarks

Signed D. C. Shackelford