



Western Michigan University  
ScholarWorks at WMU

---

Legacy Scout Tickets from Pure Oil Company

---

8-20-2021

**MGRRE\_PureOilScoutTickets\_Budenger,  
John\_1\_21081104260000**

MGRRE  
*Western Michigan University*

Follow this and additional works at: <https://scholarworks.wmich.edu/pure>



Part of the Geology Commons

---

#### **WMU ScholarWorks Citation**

MGRRE, "MGRRE\_PureOilScoutTickets\_Budenger, John\_1\_21081104260000" (2021). *Legacy Scout Tickets from Pure Oil Company*. 4439.  
<https://scholarworks.wmich.edu/pure/4439>

This Document is brought to you for free and open access via ScholarWorks at WMU. It has been accepted for inclusion in Legacy Scout Tickets from Pure Oil Company by an authorized administrator of ScholarWorks at WMU. See the National Digital Catalogue - Science Base Catalogue for more collections submitted by MGRRE.



---

**MGRRE\_PureOilScoutTickets\_Budenger, John\_1\_21081104260000**

API 21081104260000

Permit Number 10426

Lease Name Budenger, John

Well Number 1

County Kent

Township 05N

Range 12W

Section 19

2021 DEQ or Pure co\_name Columbia Oil and Gas Company

Pure Number 561

Latitude 42.80564

Longitude -85.77129

THE PURE OIL COMPANY

LOCATION REPORT

Date October 13, 1943 A.F.E. No. \_\_\_\_\_  
 Division Michigan Producing District \_\_\_\_\_ Lease John Budenger  
 Acres \_\_\_\_\_ Lease No. \_\_\_\_\_ Elevation \_\_\_\_\_ Well No. 1 (Serial No. 561)  
 Quadrangle SW-SW-NE Sec. 19 Twp. 5 N Rge. 12 W Blk. Byron  
SW-SW-NE Sec. 19 Twp. 5 N Rge. 12 W Dist. Byron  
 Survey \_\_\_\_\_ County Kent State Michigan  
 Operator Columbia Oil & Gas Co. Map Byron Twp., Kent Co.

Feet from North Line of Lease  
 " " East " " "  
330 " " South " " "  
330 " " West " " "  
 Feet from North Line of Section  
 " " East " " "  
330 " " South " " "  
330 " " West " " "

LEGEND

- Location
- ☀ Gas Well
- Oil Well
- ☀ Gas-Distillate Well
- ∅ or ○ Dry Hole
- Dry Showing Oil
- ☀ Dry Showing Gas
- ⊗ Abandoned Location
- ☀ or ⊗ Abandoned Gas Well
- or ● Abandoned Oil Well
- or ○ Input Well

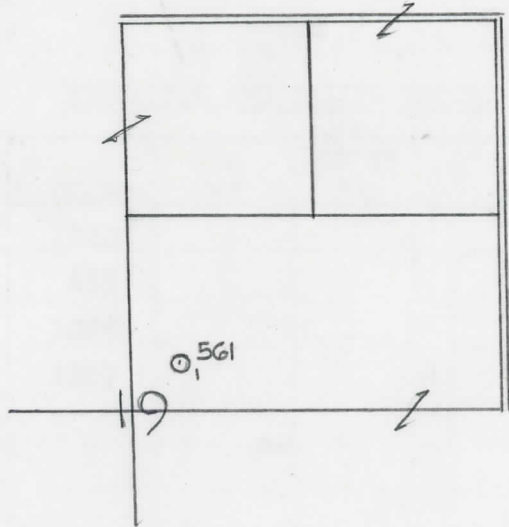

Scale \_\_\_\_\_

Remarks: \_\_\_\_\_  
 \_\_\_\_\_  
 \_\_\_\_\_

Submitted by RN Civil Engineer Approved by \_\_\_\_\_ Division Manager  
 Approved by \_\_\_\_\_ Vice-President - General Manager

Date October 13, 1943

LOCATION REPORT

Case John Budenger  
V.E.E. No. 291

COMPLETION RECORD OF WELLS DRILLED BY OTHER OPERATORS

Michigan Producing Division

Date November 17, 1943 No. 561  
State Mich. County Kent Dist. Byron Sec. 19 Twp. 5 N Rge. 12 W  
(Serial No.)  
Well No. 1 (~~County No.~~) 561 Farm John Budenger Acres  
Operator Columbia Oil & Gas Company Information secured ~~from~~ Scouting Department By  
Date well started 10-15-43 Date well completed 11-5-43 Elevation 737.8

PRODUCTION BOARD

1st 24 hours natural Dry Hole  
2nd 24 hours natural  
Date of shot No. of quarts From to From to  
Date of acid No. of gallons  
shot  
1st 24 hours after acid shot  
2nd 24 hours after acid shot

FORMATION AND CASING RECORD

Formation	Top	Bottom	Top Pay	Bottom Pay	Remarks	Casing	
						Size	Set at
Marshall	136	262				10"	156
Coldwater Lime	637	655				8-1/4"	346
Coldw. Red Rock	1079	1085					
Berea	1085	1107					
Antrim (light)	1516						
Antrim (dark)	1570						
Traverse Form.	1686						
Traverse Lime	1747				H.F.S.W. 1775.		
Total Depth		1804					

Remarks 1725' CTM equals 1711' SOM.

Signed D. C. Shackelford