



Western Michigan University
ScholarWorks at WMU

Legacy Scout Tickets from Pure Oil Company

8-20-2021

**MGRRE_PureOilScoutTickets_Apsey, John E Jr et
ux_1_21081113160000**

MGRRE
Western Michigan University

Follow this and additional works at: <https://scholarworks.wmich.edu/pure>



Part of the Geology Commons

WMU ScholarWorks Citation

MGRRE, "MGRRE_PureOilScoutTickets_Apsey, John E Jr et ux_1_21081113160000" (2021). *Legacy Scout Tickets from Pure Oil Company*. 4449.
<https://scholarworks.wmich.edu/pure/4449>

This Document is brought to you for free and open access via ScholarWorks at WMU. It has been accepted for inclusion in Legacy Scout Tickets from Pure Oil Company by an authorized administrator of ScholarWorks at WMU. See the National Digital Catalogue - Science Base Catalogue for more collections submitted by MGRRE.



MGRRE_PureOilScoutTickets_Apsey, John E Jr et ux_1_21081113160000

API 21081113160000

Permit Number 11316

Lease Name Apsey, John E Jr et ux

Well Number 1

County Kent

Township 05N

Range 11W

Section 8

2021 DEQ or Pure co_name Oil Producers, Incorporated

Pure Number 577

Latitude 42.83641

Longitude -85.62592

THE PURE OIL COMPANY
LOCATION REPORT

Date January 4, 1945 A.F.E. No. _____
 Division Mich. Producing District _____ Lease John E. Apsey, Jr. et ux
John E. Apsey, Jr., et ux
 Acres _____ Lease No. _____ Elevation _____ Well No. 1 (Serial No. 577)
 Quadrangle NE-SE-NE NE SE NE Sec. 8 Twp. 5 N Rge. 11 W ~~X Bld.~~ ~~X Dist.~~ Gaines Gaines
 Survey _____ County Kent State Michigan
 Operator Oil Producers, Inc. Map Gaines Twp - Kent Co.
Oil Producers, Inc. Gaines Township, Kent County

<u>330</u>	<u>330</u>	Feet from North Line of Lease
_____	_____	" " East " " "
_____	_____	" " South " " "
<u>330</u>	<u>330</u>	" " West " " "
_____	_____	Feet from North Line of Section
<u>330</u>	<u>330</u>	" " East " <u>1/4</u> "
<u>990</u>	<u>990</u>	" " South " " "
_____	_____	" " West " " "

LEGEND

- Location
- ☀ Gas Well
- Oil Well
- ☀ Gas - Distillate Well
- ∅ or ○ Dry Hole
- Dry Showing Oil
- ☀ Dry Showing Gas
- ⊗ Abandoned Location
- ☀ or ☀ Abandoned Gas Well
- or ● Abandoned Oil Well
- or ○ Input Well

Low

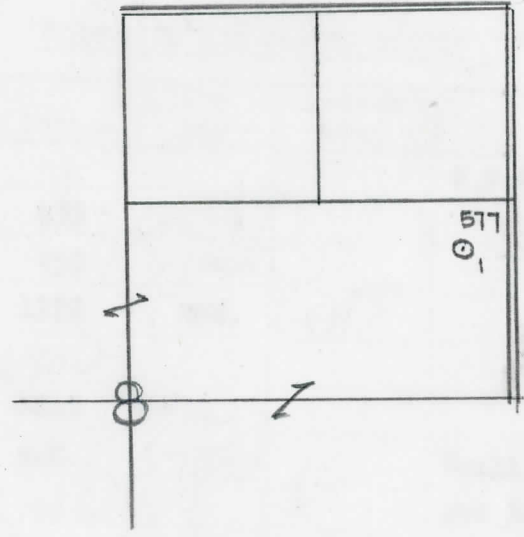

Remarks: _____

Scale _____

Submitted by RN _____ Approved by _____
 Civil Engineer Division Manager
 Approved by _____
 Vice-President - General Manager

Date April 11, 1945

LOCATION BELOW
THE OIL COMPANY

W.E. No.

COMPLETION RECORD OF WELLS DRILLED BY OTHER OPERATORS

Michigan Producing Division

Date April 11, 1945

No. 577

State Mich. County Kent Twp. Gaines Sec. 8 Twp. 5 N Rge. 11 W
(Serial No.)

Well No. 1 (577) Farm J. E. Apsey, Jr. Acres

Operator Oil Producers, Inc. Information secured By Scouting Department

Date well started 1-29-45 Date well completed 3-23-45 Elevation 779.3

PRODUCTION BOARD

1st 24 hours natural Dry Hole

2nd 24 hours natural

Date of shot 3-30-45 No. of quarts 500 From To From to

Date of acid 3-30-45 No. of gallons 500

~~1st 24 hours after acid shot~~ Pumped 12 bbls. oil and a large undetermined amt. of salt water after acid - abandoned as non-commercial.
2nd 24 hours after acid

FORMATION AND CASING RECORD

Formation	Top	Bottom	Top Pay	Bottom Pay	Remarks	Casing	
						Size	Set at
					H.F.W. 236. (1543)	10"	230
Marshall	255	455	(1524)			8-1/4"	515
Coldwater Line	905	935	(1126)			5-3/16"	1899
Coldw. Red Rock	1260	1272	SOM. (1481)				
Antrim (light)	1680	(1900)					
Antrim (dark)	1695	1845	(1916)				
Traverse Line	1898	SLM. (1119)			Small show oil and gas 1899-1901.	(1120)	
<i>Tanf. fm.</i>	1845	(1066)			Water zone not reported.		
Total Depth		1949	(1170)				
Plugged back:		1925	(1146)				

Remarks 1245' eq. 1259' SOM; 1909' eq. 1901' SLM.

Signed D. C. Shackelford