



Western Michigan University
ScholarWorks at WMU

Legacy Scout Tickets from Pure Oil Company

8-20-2021

**MGRRE_PureOilScoutTickets_Planck, John
O._1_21081116980000**

MGRRE
Western Michigan University

Follow this and additional works at: <https://scholarworks.wmich.edu/pure>



Part of the Geology Commons

WMU ScholarWorks Citation

MGRRE, "MGRRE_PureOilScoutTickets_Planck, John O._1_21081116980000" (2021). *Legacy Scout Tickets from Pure Oil Company*. 4462.
<https://scholarworks.wmich.edu/pure/4462>

This Document is brought to you for free and open access via ScholarWorks at WMU. It has been accepted for inclusion in Legacy Scout Tickets from Pure Oil Company by an authorized administrator of ScholarWorks at WMU. See the National Digital Catalogue - Science Base Catalogue for more collections submitted by MGRRE.



MGRRE_PureOilScoutTickets_Planck, John O._1_21081116980000

API 21081116980000

Permit Number 11698

Lease Name Planck, John O.

Well Number 1

County Kent

Township 09N

Range 10W

Section 31

2021 DEQ or Pure co_name MacCallum, Byron

Pure Number 590

Latitude 43.12563

Longitude -85.53931

THE PURE OIL COMPANY

LOCATION REPORT

Date August 1, 1945 A.F.E. No. _____

Division Mich. Producing District _____ Lease John O. Planck

Acres _____ Lease No. _____ Elevation _____ Well No. 1 (Serial No. 590)

Quadrangle SW SW NE Sec. 31 Twp. 9 N Rge. 10 W ~~Dist.~~ Courtland

Survey _____ County Kent State Michigan

Operator Byron MacCallum, Tr. Map Courtland Township, Kent County

| | |
|------------|---------------------------------|
| | Feet from North Line of Lease |
| | " " East " " " |
| <u>330</u> | " " South " " " |
| <u>330</u> | " " West " " " |
| | Feet from North Line of Section |
| | " " East " " " |
| <u>330</u> | " " South " <u>1/4</u> " |
| <u>330</u> | " " West " " " |

LEGEND

- Location
- ☀ Gas Well
- Oil Well
- ☀- Distillate Well
- ∅ or ○ Dry Hole
- or ○ Dry Showing Oil
- ☀ Dry Showing Gas
- ⊗ Abandoned Location
- ☀ or ☀ Abandoned Gas Well
- or ● Abandoned Oil Well
- or ○ Input Well

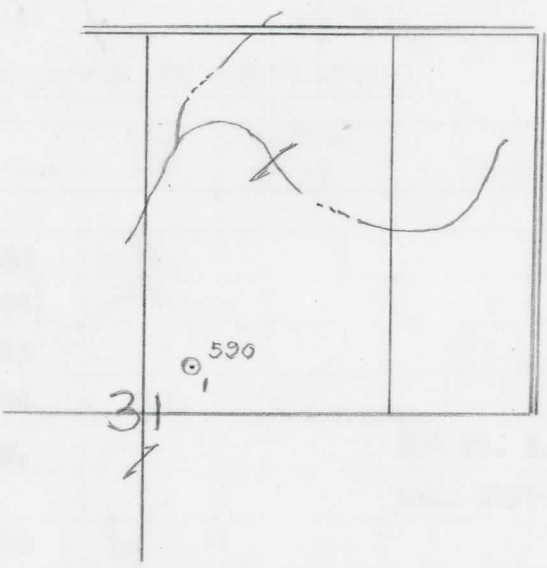

Remarks: _____

Submitted by _____ Civil Engineer

Approved by _____ Division Manager

Approved by _____ Vice-President - General Manager

COMPLETION RECORD OF WELLS DRILLED BY OTHER OPERATORS

Michigan Producing Division

Date September 19, 1945 No. 590
 State Mich. Co. Kent Dist. Courtland Twp. 31 Sec. 9 N Rge. 10 W
 Well No. 1 Serial No. 590 Farm John O. Planck Acres _____
 Operator Byron MacCallum, Tr.
 Date started 8-9-45 Date completed 9-12-45 Elevation 823.3

PRODUCTION RECORD

1st 24 hours natural
 Date of shot _____ No. of quarts _____ From _____ To _____ From _____ to _____
 Date of acid _____ No. of gallons _____ shot _____
 1st 24 hours after acid _____
 Completed as: Oil Well _____ Gas Well _____ Dry Hole X

FORMATION AND CASING RECORD

| Formation | Top | Bottom | Top Pay | Bottom Pay | Remarks | Casing | |
|-----------------|------|--------|---------|------------|------------------------------------|---------|---------|
| | | | | | | Size | Set at |
| Brown Dolomite | 600 | (+223) | | | | 10" | 281 |
| Mich. Stray | 615 | 660 | (+208) | | | 8-1/4" | 912 |
| Marshall | 680 | 895 | (+143) | | | 6-5/8" | RH 2336 |
| Coldw. Red Rock | 1706 | 1715 | (-883) | | | | |
| Antrim | 2140 | 2290 | SLM. | (-1317) | | | |
| Traverse Lime | 2335 | SOM. | (-1512) | | 500 ft. S.W. in 12 hrs. 2357-2360. | (-1534) | |
| Total Depth | | 2360 | (-1437) | | | | |

Remarks _____

Signed D. C. Shackelford