



Western Michigan University
ScholarWorks at WMU

Legacy Scout Tickets from Pure Oil Company

8-20-2021

MGRRE_PureOilScoutTickets_Dewilde, A. J._1_21081120990000

MGRRE

Western Michigan University

Follow this and additional works at: <https://scholarworks.wmich.edu/pure>



Part of the Geology Commons

WMU ScholarWorks Citation

MGRRE, "MGRRE_PureOilScoutTickets_Dewilde, A. J._1_21081120990000" (2021). *Legacy Scout Tickets from Pure Oil Company*. 4476.

<https://scholarworks.wmich.edu/pure/4476>

This Document is brought to you for free and open access via ScholarWorks at WMU. It has been accepted for inclusion in Legacy Scout Tickets from Pure Oil Company by an authorized administrator of ScholarWorks at WMU. See the National Digital Catalogue - Science Base Catalogue for more collections submitted by MGRRE.



MGRRE_PureOilScoutTickets_Dewilde, A. J._1_21081120990000

API 21081120990000

Permit Number 12099

Lease Name Dewilde, A. J.

Well Number 1

County Kent

Township 09N

Range 11W

Section 28

2021 DEQ or Pure co_name Jones Development Company

Pure Number 604

Latitude 43.13235

Longitude -85.62967

WC

THE PURE OIL COMPANY LOCATION REPORT

Date January 30, 1946

A.F.E. No. _____

Division Mich. Producing District _____

Lease A. J. De Wilde
A. J. De Wilde

Acres _____ Lease No. _____ Elevation _____ Well No. 1 (Serial No. 604)

Quadrangle SW-SW-SW Sec. 28 Twp. 9 N Rge. 11 W ~~ENK~~ ~~DISK~~ Algoma
Algoma

Survey _____ County Kent State Michigan

Operator Jones Dev. Co.
Jones Development Company Map Algoma Township, Kent County

Feet from North Line of Lease

_____	_____	East	_____	_____
<u>330</u>	<u>330</u>	South	_____	_____
<u>330</u>	<u>330</u>	West	_____	_____

Feet from North Line of Section

_____	_____	East	_____	_____
<u>330</u>	<u>330</u>	South	<u>1/4</u>	_____
<u>330</u>	<u>330</u>	West	_____	_____

LEGEND

- Location
- ☀ Gas Well
- Oil Well
- ☀ Gas - Distillate Well
- ⊘ or ○ Dry Hole
- Dry Showing Oil
- ☀ Dry Showing Gas
- ⊘ Abandoned Location
- ☀ or ☀ Abandoned Gas Well
- or ● Abandoned Oil Well
- or ○ Input Well

Low

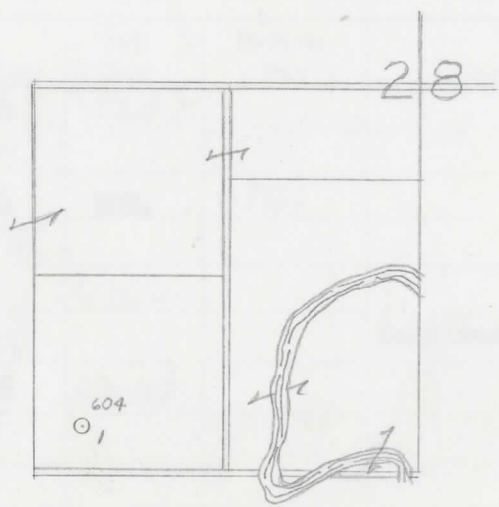

Scale _____

Remarks: _____

Submitted by CB
Civil Engineer

Approved by _____
Division Manager

Approved by _____
Vice-President - General Manager

THE PURE OIL COMPANY
COMPLETION RECORD OF WELLS DRILLED BY OTHER OPERATORS

Michigan Producing Division

Date May 15, 1946 No. 604
 State Mich. Co. Kent ~~Riskx~~ Twp. Algoma Sec. 28 Twp. 9 N Rge. 11 W
 Well No. 1 Serial No. 604 Farm A. J. DeWilde Acres _____
 Operator Jones Development Company
 Date started 2-11-46 Date completed 4-12-46 Elevation 750.1

PRODUCTION RECORD

1st 24 hours natural _____
 Date of shot _____ No. of quarts _____ From _____ To _____ From _____ To _____
 Date of acid _____ No. of gallons _____ shot _____
 1st 24 hours after acid _____
 Completed as: Oil Well _____ Gas Well _____ Dry Hole **X**

FORMATION AND CASING RECORD

Formation	Top	Bottom	Top Pay	Bottom Pay	Remarks	Casing	
						Size	Set at
Marshall	539	785	(+211)			10"	220
Coldwater Lime	1051	(-301)				8-1/4"	300
Coldw. Red Rock	1642	1654	SOM.	(-892)		6-5/8"	820
Antrim (light)	1848	(-1098)					
Antrim (dark)	1980	2185	(-1230)				
Traverse Lime	2240	(-1490)			Salt water 2260-65.	(-1510)	
Total Depth		2265	(-1515)				

Remarks _____

Signed D. C. Shackelford