



Western Michigan University  
ScholarWorks at WMU

---

Legacy Scout Tickets from Pure Oil Company

---

8-20-2021

**MGRRE\_PureOilScoutTickets\_Coalter, John  
H.\_1\_21081122750000**

MGRRE  
*Western Michigan University*

Follow this and additional works at: <https://scholarworks.wmich.edu/pure>



Part of the Geology Commons

---

#### **WMU ScholarWorks Citation**

MGRRE, "MGRRE\_PureOilScoutTickets\_Coalter, John H.\_1\_21081122750000" (2021). *Legacy Scout Tickets from Pure Oil Company*. 4482.  
<https://scholarworks.wmich.edu/pure/4482>

This Document is brought to you for free and open access via ScholarWorks at WMU. It has been accepted for inclusion in Legacy Scout Tickets from Pure Oil Company by an authorized administrator of ScholarWorks at WMU. See the National Digital Catalogue - Science Base Catalogue for more collections submitted by MGRRE.



---

**MGRRE\_PureOilScoutTickets\_Coalter, John H.\_1\_21081122750000**

API 21081122750000

Permit Number 12275

Lease Name Coalter, John H.

Well Number 1

County Kent

Township 10N

Range 12W

Section 15

2021 DEQ or Pure co\_name Fisher McCall Oil and Gas, Incorporated and Wagenaar, Neil

Pure Number 610

Latitude 43.25683

Longitude -85.73077

WC

# THE PURE OIL COMPANY LOCATION REPORT

Date May 1, 1946

A.F.E. No. \_\_\_\_\_

Division Mich. Producing

District \_\_\_\_\_

Lease John N. Coalter

Acres \_\_\_\_\_ Lease No. \_\_\_\_\_ Elevation \_\_\_\_\_ Well No. 1 (Serial No. 610)

Quadrangle SW-SW-NW Sec. 15 Twp. 10 N Rge. 12 W Twp. Tyrone

Survey \_\_\_\_\_ County Kent State Michigan

Operator Fisher-McCall Oil & Gas, Inc. & Neil Wagenaar Map Tyrone Township, Kent County

1065 1065 Feet from North Line of Lease

“ “ East “ “ “

“ “ South “ “ “

330 330 “ “ West “ “ “

Feet from North Line of Section

“ “ East “ “ “

255 255 “ “ South “ 1/4 “

330 330 “ “ West “ “ “

### LEGEND

○ Location

☀ Gas Well

● Oil Well

☀ Gas - Distillate Well

○ or ○ Dry Hole

● Dry Showing Oil

☀ Dry Showing Gas

⊗ Abandoned Location

☀ or ☀ Abandoned Gas Well

● or ● Abandoned Oil Well

⊗ or ⊗ Input Well

*Handwritten notes:*  
me 22  
for 429-116

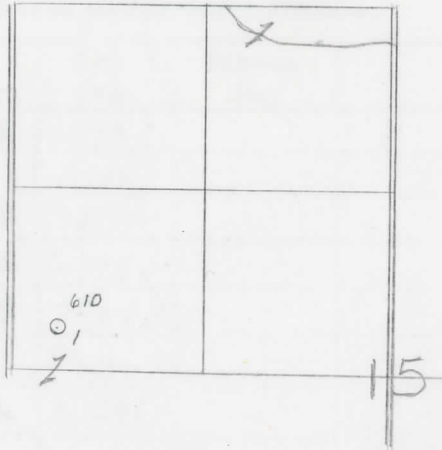

Scale \_\_\_\_\_

Remarks: \_\_\_\_\_

Submitted by CB \_\_\_\_\_  
Civil Engineer

Approved by \_\_\_\_\_  
Division Manager

Approved by \_\_\_\_\_  
Vice-President - General Manager

## THE PURE OIL COMPANY

THE PURE OIL COMPANY

## COMPLETION RECORD OF WELLS DRILLED BY OTHER OPERATORS

Michigan Producing Division

Date May 29, 1946 No. 610  
 State Mich. Co. Kent ~~District~~ Twp. Tyrone Sec. 15 Twp. 10 N Rge. 12 W  
 Well No. 1 Serial No. 610 Farm John N. Coalter Acres \_\_\_\_\_  
 Operator Fisher-McCall Oil & Gas, Inc. and Neil Wagenaar  
 Date started 4-29-46 Date completed 5-23-46 Elevation 797.6

## PRODUCTION RECORD

1st 24 hours natural \_\_\_\_\_  
 Date of shot \_\_\_\_\_ No. of quarts \_\_\_\_\_ From \_\_\_\_\_ To \_\_\_\_\_ From \_\_\_\_\_ To \_\_\_\_\_  
 Date of acid \_\_\_\_\_ No. of gallons \_\_\_\_\_ shot \_\_\_\_\_  
 1st 24 hours after acid \_\_\_\_\_  
 Completed as: Oil Well \_\_\_\_\_ Gas Well \_\_\_\_\_ Dry Hole

## FORMATION AND CASING RECORD

Formation	Top	Bottom	Top Pay	Bottom Pay	Remarks	Casing	
						Size	Set at
Brown Dolomite	625	638	(+173)			10"	372
Mich. Stray	653		(+145)			8-1/4"	608
Marshall	700	880	(+188)			6-5/8"	900
Coldw. Red Rock	1593 SLM	1602	(-795)				
Sunbury	1702	1723	(-904)				
Antrim	2100		(-1302)				
Traverse Form.	2292	SLM.	(-1494)				
Traverse Lime	2347	"	(-1549)		Rainbow oil 2349-2351. (-1551) 100 ft. salt water in one hr. 2351-2353-unable to bail down. (-1553)		
Total Depth		2353	(-1555)				

Remarks 1596' equals 1599' SLM; 2345' CTM equals 2336' SLM.

Signed

D. C. Shackelford