



Western Michigan University  
ScholarWorks at WMU

---

Legacy Scout Tickets from Pure Oil Company

---

8-20-2021

**MGRRE\_PureOilScoutTickets\_Boyd, Burch Works et  
al\_1\_21081123620000**

MGRRE

*Western Michigan University*

Follow this and additional works at: <https://scholarworks.wmich.edu/pure>



Part of the Geology Commons

---

#### **WMU ScholarWorks Citation**

MGRRE, "MGRRE\_PureOilScoutTickets\_Boyd, Burch Works et al\_1\_21081123620000" (2021). *Legacy Scout Tickets from Pure Oil Company*. 4486.  
<https://scholarworks.wmich.edu/pure/4486>

This Document is brought to you for free and open access via ScholarWorks at WMU. It has been accepted for inclusion in Legacy Scout Tickets from Pure Oil Company by an authorized administrator of ScholarWorks at WMU. See the National Digital Catalogue - Science Base Catalogue for more collections submitted by MGRRE.



---

**MGRRE\_PureOilScoutTickets\_Boyd, Burch Works et al\_1\_21081123620000**

API 21081123620000

Permit Number 12362

Lease Name Boyd, Burch Works et al

Well Number 1

County Kent

Township 09N

Range 11W

Section 36

2021 DEQ or Pure co\_name McGerry, James J, Incorporated

Pure Number 614

Latitude 43.12342

Longitude -85.55657

# THE PURE OIL COMPANY

## LOCATION REPORT

Date June 13, 1946 A.F.E. No. \_\_\_\_\_  
 Division Michigan Producing District \_\_\_\_\_ Lease Burch Boyd Works et al  
Burch Boyd Works, et al  
 Acres \_\_\_\_\_ Lease No. \_\_\_\_\_ Elevation \_\_\_\_\_ Well No. 1 (Serial No. 614)  
 Quadrange NE-NW-SE Sec. 36 Twp. 9-N Rge. 11-W Bk. Algoma Dist. Algoma  
NE NW SE Twp. \_\_\_\_\_  
 Survey \_\_\_\_\_ County Kent State Michigan  
 Operator James J. McGerry, Tr. Map Algoma Township, Kent County  
James J. McGerry, Tr.

450 450 Feet from North Line of Lease  
185 185 " " East " " "  
 " " South " " "  
 " " West " " "  
450 450 Feet from North Line of Section 1/4  
 " " East " " "  
 " " South " " "  
1135 1135 " " West " " "

**LEGEND**

- Location
- ☀ Gas Well
- Oil Well
- ☀ Gas - Distillate Well
- ∅ or ○ Dry Hole
- Dry Showing Oil
- ☀ Dry Showing Gas
- ⊗ Abandoned Location
- ☀ or ☀ Abandoned Gas Well
- or ● Abandoned Oil Well
- or ○ Input Well

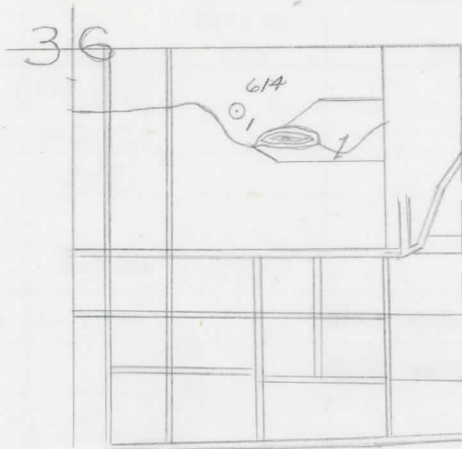

Scale \_\_\_\_\_

Remarks: \_\_\_\_\_  
 \_\_\_\_\_  
 \_\_\_\_\_

Submitted by CB Civil Engineer Approved by \_\_\_\_\_ Division Manager  
 Approved by \_\_\_\_\_ Vice-President - General Manager

COMPLETION RECORD OF WELLS DRILLED BY OTHER OPERATORS

Michigan Producing Division

Date July 17, 1946 No. 614  
 State Mich. Co. Kent ~~Dist.~~ Twp. Algoma Sec. 36 Twp. 9 N Rge. 11 W  
 Well No. 1 Serial No. 614 Farm Burch Boyd Works, et al Acres  
 Operator James J. McGerry, Tr.  
 Date started 6-6-46 Date completed 7-12-46 Elevation 706.1

PRODUCTION RECORD

1st 24 hours natural  
 Date of shot No. of quarts From To From To  
 Date of acid No. of gallons shot  
 1st 24 hours after acid  
 Completed as: Oil Well Gas Well Dry Hole X

FORMATION AND CASING RECORD

Formation	Top	Bottom	Top Pay	Bottom Pay	Remarks	Casing	
						Size	Set at
Marshall	464	732	(+242)			10"	156
Coldwater Lime	1016	1023	(-210)			8-1/4"	297
Coldw. Red Rock	1563	1569	(-85)			6-5/8"	765
Antrim (light)	1670	(-964)					
Antrim (dark)	1980	2163	S.L.M. (-1274)				
Traverse Lime	2211	S.L.M.	(-1505)		Show oil 2217-2222. (-1511)		
					Salt water 2224-26. (-1518)		
Total Depth		2226	(-1520)				

Remarks 2138' equals 2132' S.L.M.

Signed D. C. Shackelford