



Western Michigan University  
ScholarWorks at WMU

---

Legacy Scout Tickets from Pure Oil Company

---

8-20-2021

**MGRRE\_PureOilScoutTickets\_Baderschneider, Lienweber,  
Morrison, Pfuhl\_13\_21085085470000**

MGRRE

*Western Michigan University*

Follow this and additional works at: <https://scholarworks.wmich.edu/pure>



Part of the Geology Commons

---

#### WMU ScholarWorks Citation

MGRRE, "MGRRE\_PureOilScoutTickets\_Baderschneider, Lienweber, Morrison, Pfuhl\_13\_21085085470000" (2021). *Legacy Scout Tickets from Pure Oil Company*. 4516.  
<https://scholarworks.wmich.edu/pure/4516>

This Document is brought to you for free and open access via ScholarWorks at WMU. It has been accepted for inclusion in Legacy Scout Tickets from Pure Oil Company by an authorized administrator of ScholarWorks at WMU. See the National Digital Catalogue - Science Base Catalogue for more collections submitted by MGRRE.



---

**MGRRE\_PureOilScoutTickets\_Baderschneider, Lienweber, Morrison,  
Pfuhl\_13\_21085085470000**

API 21085085470000

Permit Number 8547

Lease Name Baderschneider, Lienweber, Morrison, Pfuhl

Well Number 13

County Lake

Township 18N

Range 11W

Section 25

2021 DEQ or Pure co\_name Mid Michigan Gas Storage Company

Pure Number 17

Latitude 43.92355

Longitude -85.56741

THE PURE OIL COMPANY

DATE April 16, 1941

LOCATION REPORT

No. 17

STATE Michigan COUNTY Lake DISTRICT Pinora TWP Pinora SEC. 235 TOWN 18N RANGE 11W

WELL No. 133 (SERIAL No. 17) FARM Baderschneider-Lienweber-Morrison-Pfuhl ACRES

NAME OF STREAM OR WATERS QUADRANGLE C-12

OPERATOR Taggart Brothers Company Map Pinora Township, Lake County

Feet from North Line of Farm

1320 1320 " " East " " "

1320 1320 " " South " " "

0 0 " " West " " "

Feet from North Line of Section

1320 1320 " " East " " "

0 0 " " South " " "

" " West " " "

Low

LEGEND

- LOCATION, RIG, DRILLING, GAS WELL, OIL WELL, SMALL OIL WELL, DRY HOLE, DRY SHOWING OIL, DRY SHOWING GAS, ABANDONED LOCATION, ABANDONED GAS WELL, ABANDONED OIL WELL

NOTE: Below make tracing from map. (when no map is obtainable make sketch) showing farm, center of section, this location with measurements and also wells, dry holes, or other locations in the vicinity of this location.

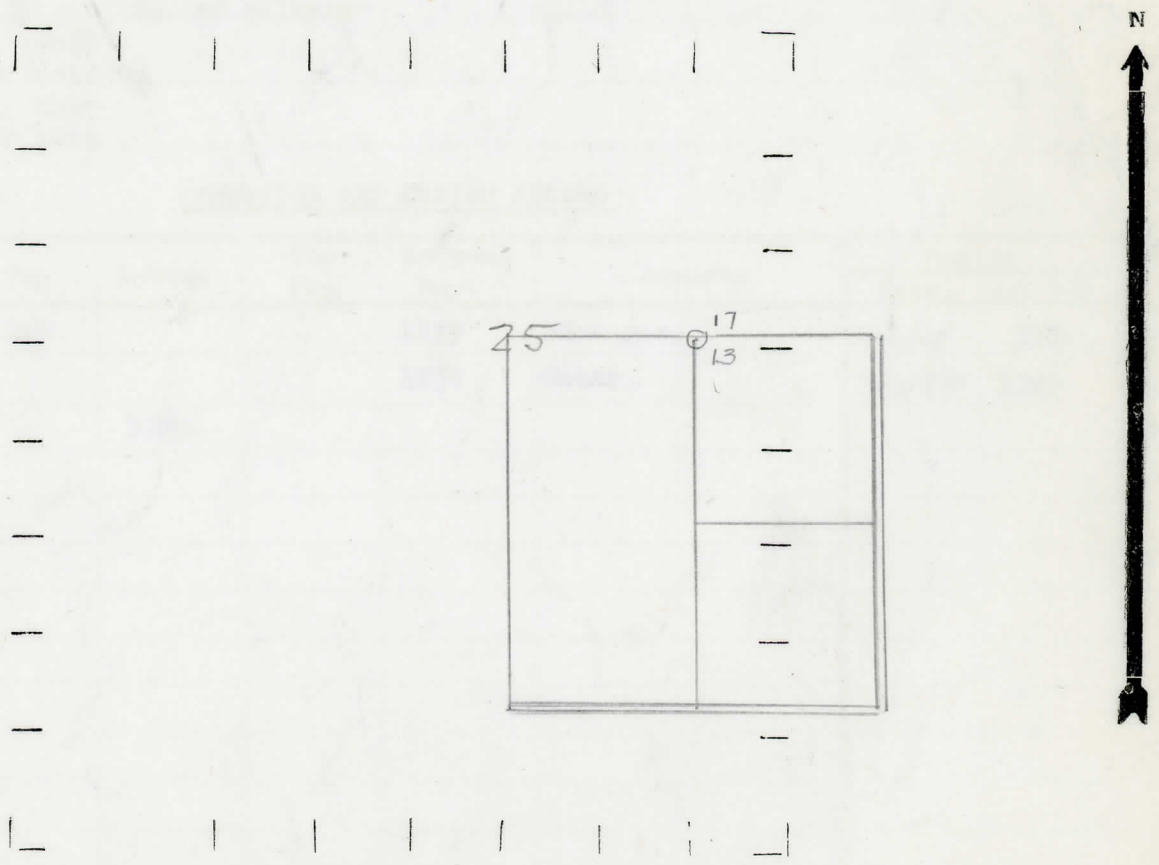

REMARKS:

SIGNED

Superintendent or Foreman.

ОБЪЕКТОВ THE PURE OIL COMPANY  
 ИМЕНЕ ОБЪЕКТА ИЛИ НАЗВАНИЕ

THE PURE OIL COMPANY  
 LOCATION REPORT

STATE OF MICHIGAN  
 DIVISION OF OIL

WELL NO. 13 (SERIAL NO. 73) EXPLORATION

BRADLEY-SCHNEIDER-TRIMMER-ROLLISON-BLOTT

17

Date May 14, 1941 No. 17  
 State Mich. County Lake **Dist.** Pinora Twp. 25 Sec. 18 N Rge. 11 W  
 Well No. 13 (Serial No.) 17 Farm Baderschneider, et al Acres  
 Operator Taggart Brothers Company Information secured ~~from~~ Scouting Department By  
 Date well started 5-3-41 Date well completed 5-10-41 Elevation 1153.1

PRODUCTION RECORD

1st 24 hours natural Dry Hole  
 2nd 24 hours natural  
 Date of shot No. of quarts From to From to  
 Date of acid No. of gallons  
 shot  
 1st 24 hours after acid  
 shot  
 2nd 24 hours after acid

FORMATION AND CASING RECORD

Formation	Top	Bottom	Top Pay	Bottom Pay	Remarks	Casing	
						Size	Set at
Stray	1249			1253	Show gas.	8-1/4"	302
				1259	Water.	5-3/16"	1248
Total Depth		1259					

Remarks

Signed D. C. Shackelford