



Western Michigan University
ScholarWorks at WMU

Legacy Scout Tickets from Pure Oil Company

8-20-2021

**MGRRE_PureOilScoutTickets_Peiser, Marcus A et
al_1_21085089120000**

MGRRE
Western Michigan University

Follow this and additional works at: <https://scholarworks.wmich.edu/pure>



Part of the Geology Commons

WMU ScholarWorks Citation

MGRRE, "MGRRE_PureOilScoutTickets_Peiser, Marcus A et al_1_21085089120000" (2021). *Legacy Scout Tickets from Pure Oil Company*. 4522.
<https://scholarworks.wmich.edu/pure/4522>

This Document is brought to you for free and open access via ScholarWorks at WMU. It has been accepted for inclusion in Legacy Scout Tickets from Pure Oil Company by an authorized administrator of ScholarWorks at WMU. See the National Digital Catalogue - Science Base Catalogue for more collections submitted by MGRRE.



MGRRE_PureOilScoutTickets_Peiser, Marcus A et al_1_21085089120000

API 21085089120000

Permit Number 8912

Lease Name Peiser, Marcus A et al

Well Number 1

County Lake

Township 18N

Range 11W

Section 6

2021 DEQ or Pure co_name Marathon Oil Company

Pure Number 23

Latitude 43.97844

Longitude -85.67926

THE PURE OIL COMPANY

DATE August 27, 1941

LOCATION REPORT

No. 23

COMPLETION RECORD OF WELLS DRILLED BY OTHER OPERATORS

STATE Michigan COUNTY Lake DIST. Pinora TWP. Pinora SEC. 66 TOWN 18 N RANGE 11 W
WELL No. 1 (SERIAL No. 223) FARM Marcus A. Peiser, et al ACRES

NAME OF STREAM OR WATERS QUADRANGLE G 3 1/2 NW 1/4 SW 1/4

OPERATOR Ohio Oil Company Map Pinora Township, Lake County

1720 1720 Feet from North Line of Farm

“ “ East “ “ “

“ “ South “ “ “

592 592 “ “ West “ “ “

920 920 Feet from North Line of Section 1/4 1/4

“ “ East “ “ “

“ “ South “ “ “

726 726 “ “ West “ “ “

map

LEGEND

- LOCATION
- ⊕ RIG
- ⊕ DRILLING
- ☀ GAS WELL
- OIL WELL
- SMALL OIL WELL
- ⊕ DRY HOLE
- DRY SHOWING OIL
- ⊕ DRY SHOWING GAS
- ⊕ ABANDONED LOCATION
- ☀ ABANDONED GAS WELL
- ABANDONED OIL WELL

NOTE: Below make tracing from map, (when no map is obtainable make sketch) showing farm, center of section, this location with measurements and also wells, dry holes, or other locations in the vicinity of this location.

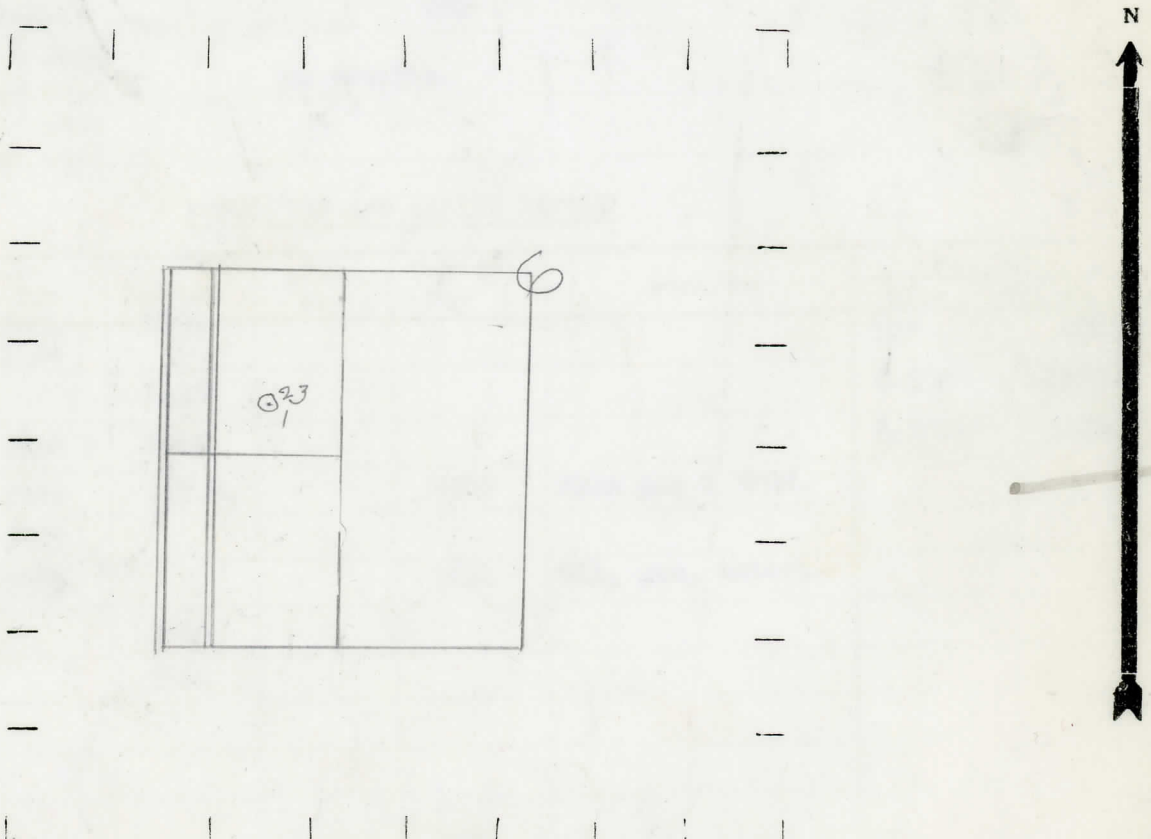

REMARKS:

SIGNED

Superintendent or Foreman.

CW

Date November 19, 1941 No. 23
 State Mich. County Lake Dist. XXXX
 Twp. Pinora Sec. 6 Twp. 18 N Rge. 11 W
 Well No. 1 (Serial No.) 23 (County No.)
 Farm M. A. Peiser, et al Acres
 Operator Ohio Oil Company Information secured From Scouting Department
 Date well started 9-3-41 Date well completed 10-13-41 Elevation 1143.7

PRODUCTION RECORD

1st 24 hours natural Dry Hole
 2nd 24 hours natural
 Date of shot 11-2-41 No. of quarts 250 From to
 Date of acid 11-2-41 No. of gallons 250
 1st 24 hours after acid shot No results.
 2nd 24 hours after acid shot

FORMATION AND CASING RECORD

Formation	Top	Bottom	Top Pay	Bottom Pay	Remarks	Casing	
						Size	Set at
Brown Dolomite	1084	1092					
Stray	1186					10"	406
Red Rock		1425				6-5/8"	1630
Antrim	2540 ?	2868				5-3/16"	3482
Traverse Lime	2880	C.T.M.		2905	Show gas & HFSW.		
Dundee	3493						
Monroe	3570			3664	Oil, gas, water.		
Total Depth		3666					
Plugged back:		3664					

Remarks Filled up with 1200 ft. salt water and 200 ft. oil natural - after plugging back and treating in 12 days swabbed 120 bbls. oil - water could not be swabbed down. 3095' CTM equals 3097' SLM.

Signed D. C. Shackelford