



Western Michigan University  
ScholarWorks at WMU

---

Legacy Scout Tickets from Pure Oil Company

---

8-20-2021

**MGRRE\_PureOilScoutTickets\_Pfuhl, Curt\_1\_21085089430000**

MGRRE

*Western Michigan University*

Follow this and additional works at: <https://scholarworks.wmich.edu/pure>



Part of the Geology Commons

---

#### **WMU ScholarWorks Citation**

MGRRE, "MGRRE\_PureOilScoutTickets\_Pfuhl, Curt\_1\_21085089430000" (2021). *Legacy Scout Tickets from Pure Oil Company*. 4524.

<https://scholarworks.wmich.edu/pure/4524>

This Document is brought to you for free and open access via ScholarWorks at WMU. It has been accepted for inclusion in Legacy Scout Tickets from Pure Oil Company by an authorized administrator of ScholarWorks at WMU. See the National Digital Catalogue - Science Base Catalogue for more collections submitted by MGRRE.



---

**MGRRE\_PureOilScoutTickets\_Pfuhl, Curt\_1\_21085089430000**

API 21085089430000

Permit Number 8943

Lease Name Pfuhl, Curt

Well Number 1

County Lake

Township 18N

Range 11W

Section 24

2021 DEQ or Pure co\_name Mid Michigan Gas Storage Company

Pure Number 26

Latitude 43.9316712

Longitude -85.564998

THE PURE OIL COMPANY

DATE September 10, 1941

LOCATION REPORT

No. 26

STATE Michigan COUNTY Lake DIST. TWP. Pinora SEC. 24 TOWN 18 N RANGE 11 W  
WELL No. 1 (SERIAL No. 286) FARM Curt Pfuhl ACRES 110

NAME OF STREAM OR WATERS \_\_\_\_\_ QUADRANGLE C 3 1/2 SE SE

OPERATOR Weber Oil Company Map Pinora Township, Lake County  
Weber Oil Co Pinora - Lake

Feet from North Line of Farm  
660 660 " " East " " "  
330 330 " " South " " "  
" " West " " "

Feet from North Line of Section  
660 660 " " East 1/4  
330 330 " " South " " "  
" " West " " "

LEGEND

- LOCATION
- ⊕ RIG
- ⊕ DRILLING
- ☀ GAS WELL
- OIL WELL
- SMALL OIL WELL
- ⊖ DRY HOLE
- DRY SHOWING OIL
- ☀ DRY SHOWING GAS
- ⊖ ABANDONED LOCATION
- ☀ ABANDONED GAS WELL
- ABANDONED OIL WELL

NOTE: Below make tracing from map. (when no map is obtainable make sketch) showing farm, center of section, this location with measurements and also wells, dry holes, or other locations in the vicinity of this location.

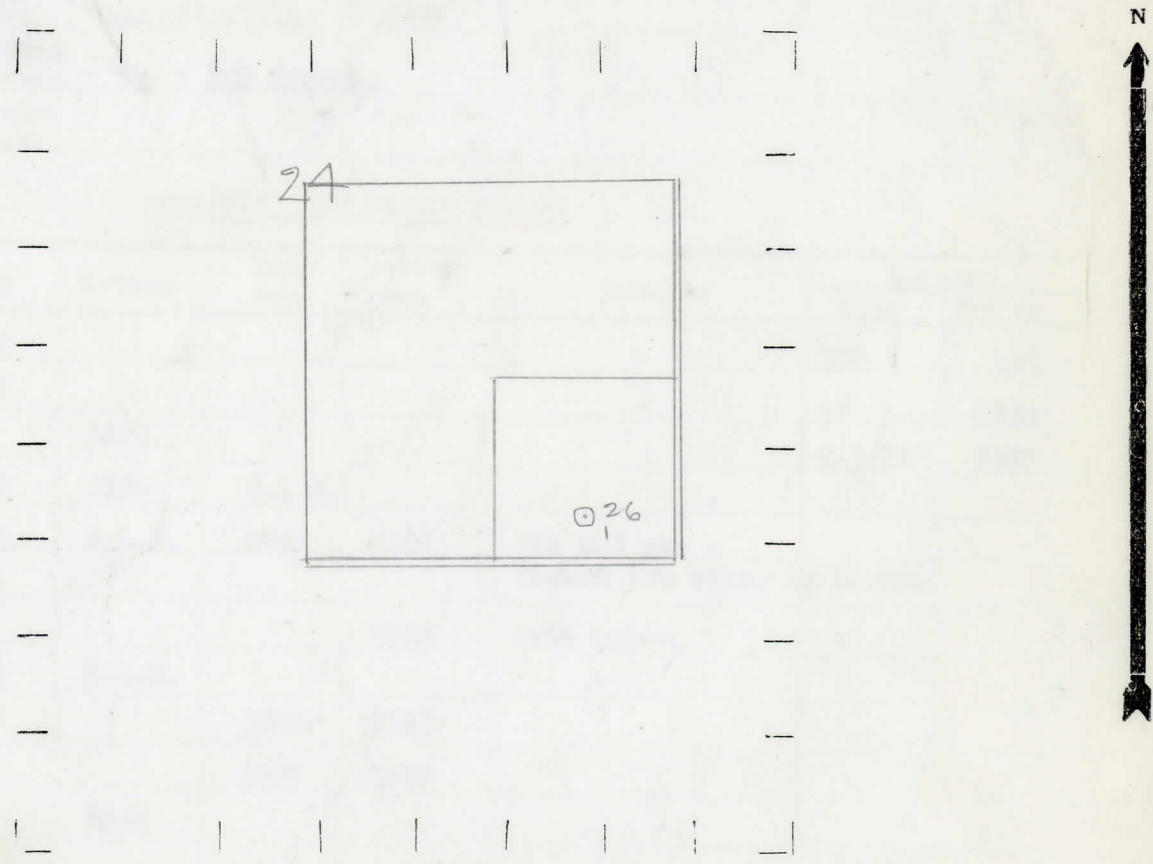

REMARKS:

\_\_\_\_\_  
\_\_\_\_\_  
\_\_\_\_\_

SIGNED

W  
Superintendent or Foreman.

DATE November 12, 1941 LOCATION REPORT 26  
 COUNTY Washtenaw DISTRICT 26  
 NAME OF OPERATOR OR LESSEE Weber Oil Company  
 (SERIAL NO.) 26 (FARM NO.) 26

Date November 12, 1941 No. 26  
 State Mich. County Lake Dist. Pinora  
 Twp. Pinora Sec. 24 Twp. 18 N Rge. 11 W  
 Well No. 1 (County No.) 26 Farm Curt Pfuhl Acres \_\_\_\_\_  
 Operator Weber Oil Company Information secured from Scouting Department  
 Date well started 9-11-41 Date well completed 10-30-41 Elevation 1156.3

PRODUCTION RECORD

1st 24 hours natural 300 Barrels (Flowed)  
 2nd 24 hours natural \_\_\_\_\_  
 Date of shot \_\_\_\_\_ No. of quarts \_\_\_\_\_ From \_\_\_\_\_ to \_\_\_\_\_  
 Date of acid 11-5-41 No. of gallons 1000  
 1st 24 hours after acid 680 Barrels  
 shot \_\_\_\_\_  
 2nd 24 hours after acid \_\_\_\_\_

FORMATION AND CASING RECORD

Formation	Top	Bottom	Top Pay	Bottom Pay	Remarks	Casing	
						Size	Set at
Brown Dolomite	1135					10"	415
Stray	1238					7"	1530
Marshall		1470				5-3/16"	3597
Antrim	2600	2920	S.L.M.				
Traverse Lime	2953	S.L.M.	2955	2967	Oil and gas - flowed 180 bbls. in 16 hrs.		
				3025	Salt water.		
Dundee	3526	S.L.M.					
Monroe	3600		3622	3623			
			3628	3629			
Total Depth		3632					

Remarks 3033' CTM equals 3053' SLM.

Signed D. C. Shackelford