



Western Michigan University  
ScholarWorks at WMU

---

Legacy Scout Tickets from Pure Oil Company

---

8-20-2021

**MGRRE\_PureOilScoutTickets\_Lucius\_1\_21085110550000**

MGRRE

*Western Michigan University*

Follow this and additional works at: <https://scholarworks.wmich.edu/pure>



Part of the Geology Commons

---

#### **WMU ScholarWorks Citation**

MGRRE, "MGRRE\_PureOilScoutTickets\_Lucius\_1\_21085110550000" (2021). *Legacy Scout Tickets from Pure Oil Company*. 4574.

<https://scholarworks.wmich.edu/pure/4574>

This Document is brought to you for free and open access via ScholarWorks at WMU. It has been accepted for inclusion in Legacy Scout Tickets from Pure Oil Company by an authorized administrator of ScholarWorks at WMU. See the National Digital Catalogue - Science Base Catalogue for more collections submitted by MGRRE.



---

**MGRRE\_PureOilScoutTickets\_Lucius\_1\_21085110550000**

API 21085110550000

Permit Number 11055

Lease Name Lucius

Well Number 1

County Lake

Township 19N

Range 11W

Section 22

2021 DEQ or Pure co\_name Rowmor Corporation and AmeriCrude Oil Company

Pure Number 84

Latitude 44.0304

Longitude -85.62149

# THE PURE OIL COMPANY LOCATION REPORT

Date September 13, 1944

A.F.E. No. \_\_\_\_\_

Division Mich. Producing District \_\_\_\_\_ Lease Lucius

Acres \_\_\_\_\_ Lease No. \_\_\_\_\_ Elevation \_\_\_\_\_ Well No. 1 (Serial No. 84)

Quadrangle NW-NW-NW Sec. 22 Twp. 19 N Rge. 11 W Twp. Ellsworth

Survey \_\_\_\_\_ County Lake State Michigan

Operator Rowmor Corp. & Americrude Oil Co. Map Ellsworth Township, Lake County

<u>330</u>	<u>330</u>	Feet from North Line of Lease
_____	_____	" " East " " "
_____	_____	" " South " " "
<u>330</u>	<u>330</u>	" " West " " " <u>1/4</u>
<u>330</u>	<u>330</u>	Feet from North Line of Section
_____	_____	" " East " " "
_____	_____	" " South " " "
<u>330</u>	<u>330</u>	" " West " " "

### LEGEND

- Location
- ☀ Gas Well
- Oil Well
- ☀ Gas - Distillate Well
- ∅ or ○ Dry Hole
- Dry Showing Oil
- ☀ Dry Showing Gas
- ⊗ Abandoned Location
- ☀ or ☀ Abandoned Gas Well
- or ● Abandoned Oil Well
- or ○ Input Well

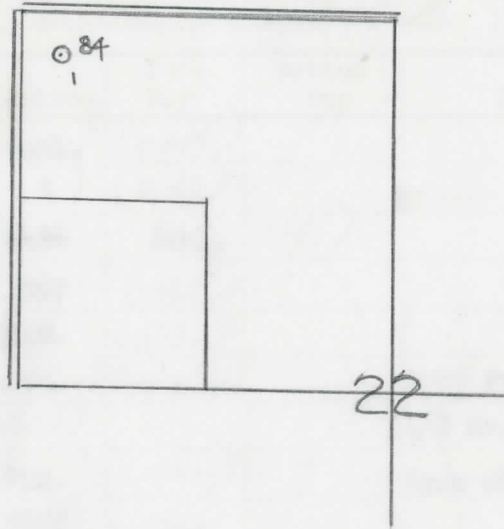

Remarks: \_\_\_\_\_

Scale \_\_\_\_\_

Submitted by RN Civil Engineer

Approved by \_\_\_\_\_ Division Manager

Approved by \_\_\_\_\_ Vice-President - General Manager

LOCATION BELOW  
THE ROCK OIL COMPANY

COMPLETION RECORD OF WELLS DRILLED BY OTHER OPERATORS

Michigan Producing Division

Date **March 7, 1945** No. **84**  
 State **Mich.** County **Lake** ~~XXXXX~~ Twp. **Ellsworth** Sec. **22** Twp. **19 N** Rge **11 W**  
 Well No. **1** (Serial No.) ~~XXXXXXXXXX~~ **84** Farm **Lucius** Acres \_\_\_\_\_  
 Operator **Rowmor Corp.-Americrude Oil Co.** Information secured ~~XXXXX~~ By **Scouting Department**  
 Date well started **12-14-44** Date well completed **2-28-45** Elevation **1189.8**

PRODUCTION BOARD

1st 24 hours natural **Dry Hole**  
 2nd 24 hours natural \_\_\_\_\_  
 Date of shot \_\_\_\_\_ No. of quarts \_\_\_\_\_ From \_\_\_\_\_ to \_\_\_\_\_ From \_\_\_\_\_ to \_\_\_\_\_  
 Date of acid \_\_\_\_\_ No. of gallons \_\_\_\_\_  
 shot \_\_\_\_\_  
 1st 24 hours after acid \_\_\_\_\_  
 shot \_\_\_\_\_  
 2nd 24 hours after acid \_\_\_\_\_

FORMATION AND CASING RECORD

Formation	Top	Bottom	Top Pay	Bottom Pay	Remarks	Casing	
						Size	Set at
Brown Dolomite	1041	Schl.	(+149)			10"	285
Mich. Stray	1144	"	(+46)			6-5/8"	1445
Marshall	1271	1426	Schl.	(-81)			
Antrim	2565	2867	(-1375)				
Traverse Lime	2923	SLM.	(-1733)				
Dundee	3512	CTM.	(-2322)		1000 ft. S.W. in		
<i>Traverse</i>	2867	(-1677)			1/2 hr. at 3574.	(-2384)	
Detroit River	3612	SLM.	(-2422)		Scum oil 3624-3626.	(-2434)	
Total Depth		3658	(-2468)				

Remarks **3197' equals 3206' SLM; 3622' equals 3622' SLM.**

Signed **D. C. Shackelford**